



22

ODYSSEY MEDICAL CENTER

22

22 ODYSSEY, SUITE 265 IRVINE, CA 92618

2,477 SF

CLASS A MEDICAL OFFICE CONDOMINIUM  
FOR SALE OR LEASE

CBRE

# Property Overview



22 Odyssey, Suite 265 is a fully improved 2,477 square foot medical office condominium. Located on the second floor of the Odyssey Medical center, the subject property is part of the highly desirable Irvine Spectrum medical office district. This modern medical condominium is move in ready with top class finishes and a highly efficient layout housing a waiting room, reception area, four versatile treatment rooms, a AAAA certified single OR surgery center, large nurses station, staff break room, and two private physician and admin offices. With ample and convenient free surface parking as well as easy access to all major Orange County freeways, this property is perfect for expanding or establishing a medical practice. Ownership will consider offers for purchase or long term lease and the acquisition of specific furniture, fixtures and equipment may also be entertained.

22 ODYSSEY, SUITE 265 IRVINE, CA

# Property Features



Recently Renovated Lobby



Abundant Surface Parking



Convenient Elevator Access For Patient Drop-Off & Pick-Up



Located in a Premier Condo Project



Enjoy Close Proximity To Irvine Spectrum Amenities

22 ODYSSEY, SUITE 265 IRVINE, CA



# Suite 265

FLOOR PLAN

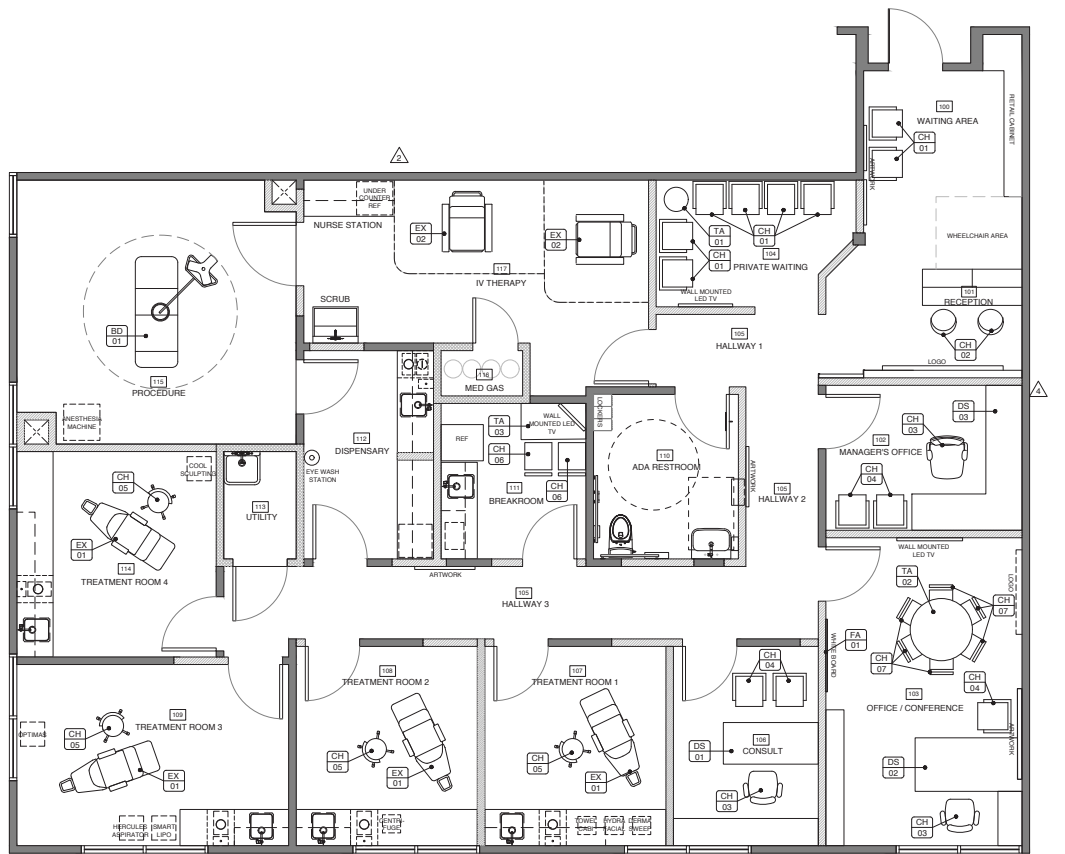

**2,477 SF**

Efficient layout with dedicated reception and waiting room, physicians office and conference room, patient consult, four (4) versatile treatment rooms, a one (1) OR surgery center and related support areas, nurse station, staff kitchen/break room and dedicated in-suite restroom.



22 ODYSSEY, SUITE 265 IRVINE, CA



# Suite 265

INTERIOR



**2,477 SF** MEDICAL OFFICE SPACE  
FOR SALE OR LEASE

22 ODYSSEY, SUITE 265 IRVINE, CA



22 ODYSSEY, SUITE 265 IRVINE, CA 92618

**John Scruggs**

First Vice President

Lic. 01796826

+1 949 842 5897

[John.Scruggs@cbre.com](mailto:John.Scruggs@cbre.com)

**Daniel Nabavi**

Senior Associate

Lic. 02069315

+1 949 225 7429

[Daniel.Nabavi@cbre.com](mailto:Daniel.Nabavi@cbre.com)



©2024 CBRE, Inc. All rights reserved. This information has been obtained from sources believed reliable, but has not been verified for accuracy or completeness. You should conduct a careful, independent investigation of the property and verify all information. Any reliance on this information is solely at your own risk. CBRE and the CBRE logo are service marks of CBRE, Inc. All other marks displayed on this document are the property of their respective owners, and the use of such logos does not imply any affiliation with or endorsement of CBRE. Photos herein are the property of their respective owners. Use of these images without the express written consent of the owner is prohibited.