



For Lease

Coffee / small eatery retail space available

- 1,972 square feet of space available in Kindred Square
- The space has been prepped for a small restaurant/coffee shop with plumbing, electric, sprinklers and air handling units in place
- Exterior signage opportunity is available
- Outdoor seating available
- The campus is within walking distance to Brown Hotel, Courier-Journal, Brown Office Building, St. Francis High School, Louisville Free Public Library and Heyburn Building

Kindred Square
656 S. Fourth Street
Louisville, KY 40202

Yandell Wood, SIOR
+1 502 394 2518
yandell.wood@am.jll.com

Jeff Dreher, SIOR, MBA
+1 502 394 2519
jeff.dreher@am.jll.com



Ground floor plan

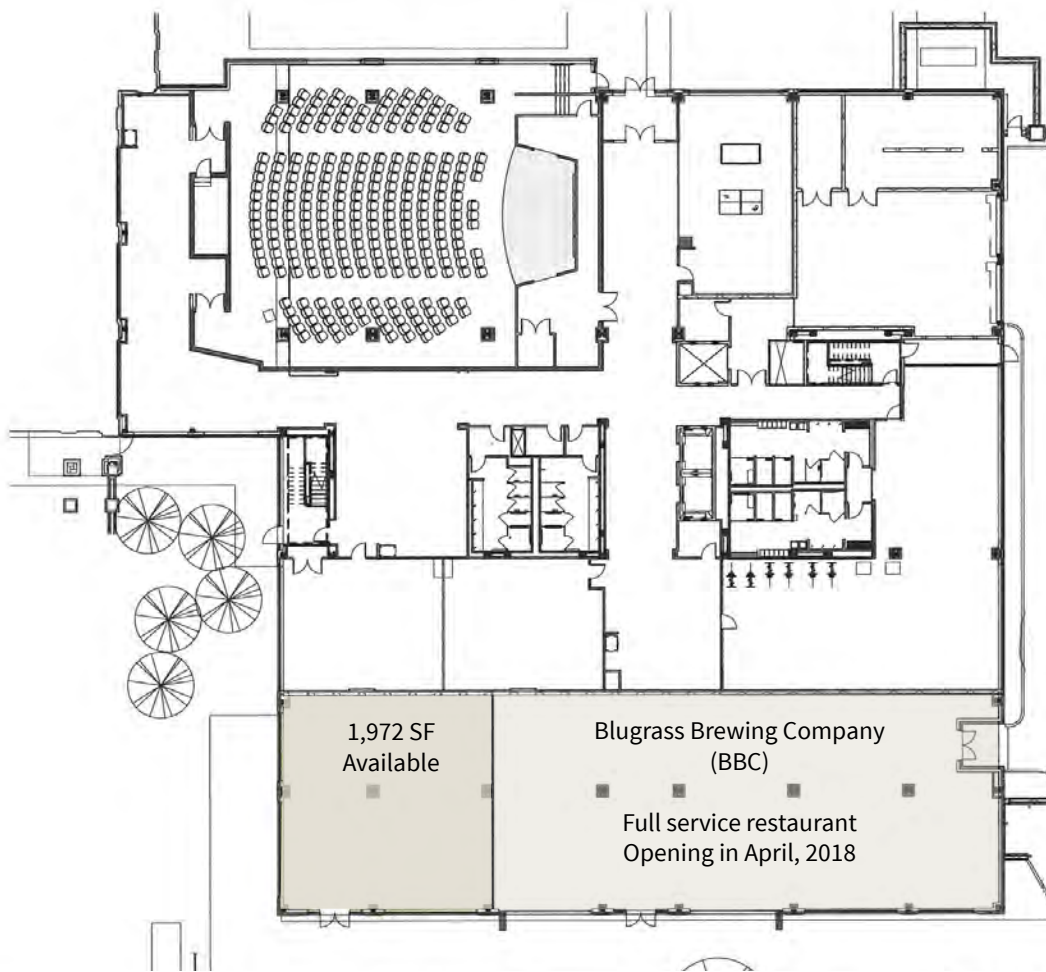

Downtown location

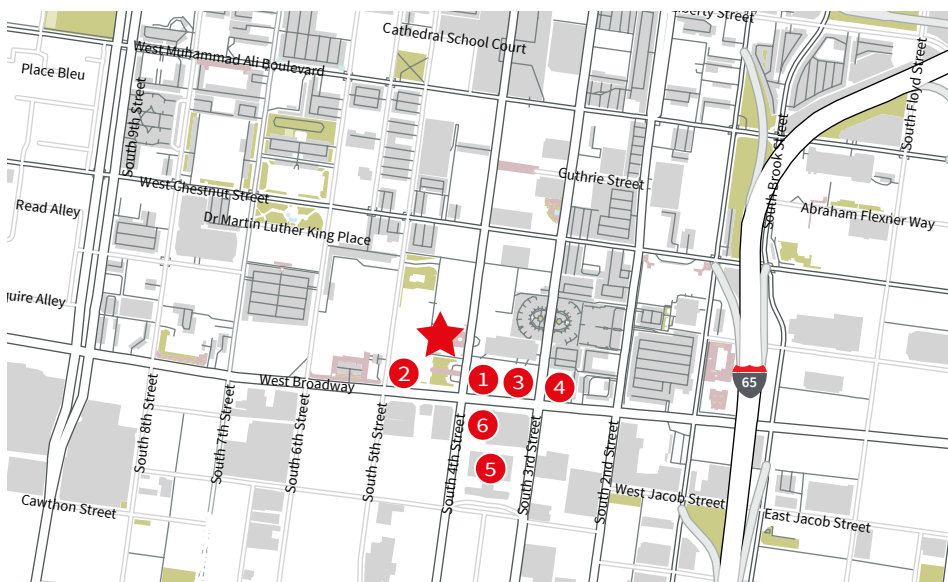

- ★ Kindred Square
- ① Brown Hotel
- ② Courier-Journal
- ③ Brown Office Building
- ④ St. Francis High School
- ⑤ Louisville Free Public Library
- ⑥ Heyburn Building

DISCLAIMER

©2021 Jones Lang LaSalle IP, Inc. All rights reserved. All information contained herein is from sources deemed reliable; however, no representation or warranty is made to the accuracy thereof.

