

6215, 6223 & 6231
CANTON CENTER ROAD
CANTON, MICHIGAN

OFFICE FOR LEASE
3,400 Square Feet Available



**SIGNATURE
ASSOCIATES**
KNOW SIGNATURE | KNOW RESULTS

GOVINDA PROFESSIONAL PARK



PROPERTY FEATURES

- 3,400 square feet available
- Private entry medical and office suites
- Monument signage on Canton Center Road
- New parking lot with ample spaces immediately adjacent to suite entrances
- Lease Rate: \$16.50/sf Gross + Utilities



For more information, please contact:

JASON STOUGH
(248) 948 4180
jstough@signatureassociates.com

SIGNATURE ASSOCIATES
One Towne Square, Suite 1200
Southfield, MI 48076
www.signatureassociates.com

6215, 6223, & 6231 Canton Center Rd. - Canton, MI

Office For Lease

3,400
Square Feet
AVAILABLE

Site Plan

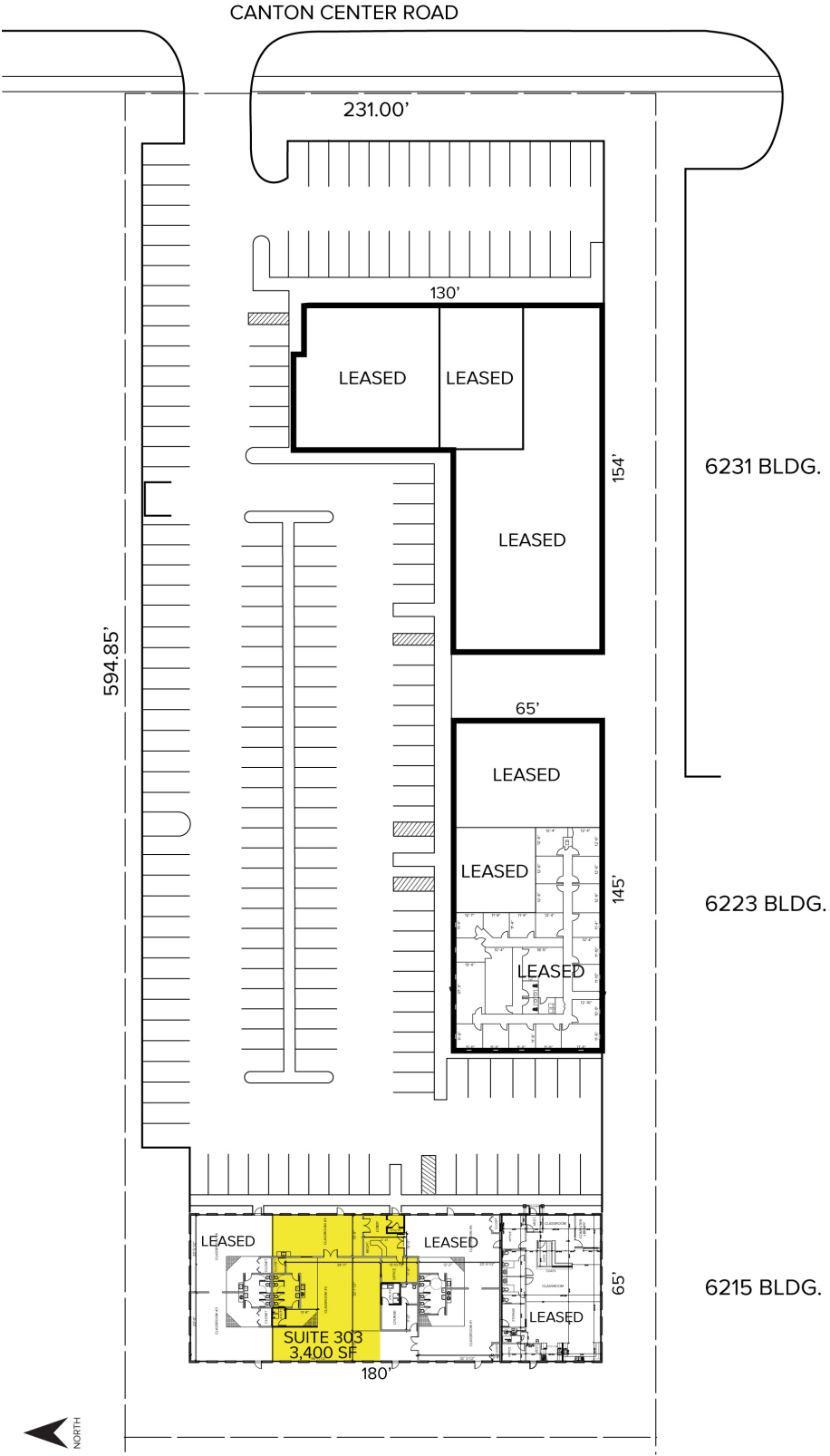

For more information, please contact:
JASON STOUGH
(248) 948 4180
jstough@signatureassociates.com

SIGNATURE ASSOCIATES
One Towne Square, Suite 1200
Southfield, MI 48076
www.signatureassociates.com

Information is subject to verification and no liability for errors or omissions is assumed. Price is subject to change and listing withdrawal.

3,400
Square Feet
AVAILABLE

29'-9" 33'-5 1/2"

CLASSROOM #3 CLASSROOM #4

98'-11 1/2"

CLOSET CLOSET CLOSET

UTILITY

13'-8"

CLASSROOM #2 CLASSROOM #5

**SUITE 303
3,400 SF**

13'-1" 32'-1 1/2" 34'-11"

18'-0"

RECPT. LOBBY

17'-7"

UTILITY

10'-0"

LOUNGE UTILITY OFFICE

11'-0" 13'-10 1/2" 11'-0"

12'-2"

23'-9 1/2"

CLASSROOM #1 CLASSROOM #6

3'-8" CLOSET

OFFICE STORAGE OFFICE

VEST. KITCHEN

CLASSROOM COATS COPY VEST.

COMPUTER LIBRARY

Information is subject to verification and no liability for errors or omissions is assumed. Price is subject to change and listing withdrawal.