

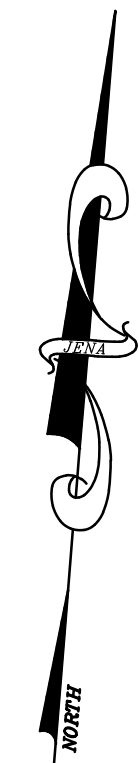

LOCATION MAP
SCALE: 1" = 2000'

**CALL BEFORE YOU DIG
IN PENNSYLVANIA**
A Three Working Day Notice is the Law!
1-800-242-1776
Dig Safely.
www.paonecall.org

SITE DATA		
EQUITABLE OWNER/DEVELOPER:	EXCHANGE 12 LLC 1177 6TH STREET WHITEHALL PA, 18052	
SITE ADDRESS:	1492 VAN BUREN ROAD PALMER TOWNSHIP NORTHAMPTON COUNTY, PENNSYLVANIA	
TRACT AREA:	1,595,755.316 SQ. FT. (36.63 ACRES)	
DEED:	BK. 761, PG. 118	
PARCEL ID:	K810A1-0324 & K8-10A1-0418	
ZONING DISTRICT:	P1/C - PLANNED INDUSTRIAL-COMMERCIAL DISTRICT	
MINIMUM LOT SIZE:	REQUIRED 15 ACRE	PROVIDED 36.63 ACRE
MINIMUM LOT WIDTH:	100 FT.	987.9 FT.
MAXIMUM BUILDING COVERAGE OF LOT:	40%	16.8%
MAXIMUM IMPERVIOUS COVERAGE:	65%	42.4%
MINIMUM LANDSCAPED AREA:	20%	57.6%
BUILDING SETBACKS:		
FRONT:	40 FT.	117.3 FT.
REAR:	15 FT.	100.3 FT.
SIDE:	15 FT.	155.4 FT.
WATER:	PUBLIC	
SEWER:	PUBLIC	

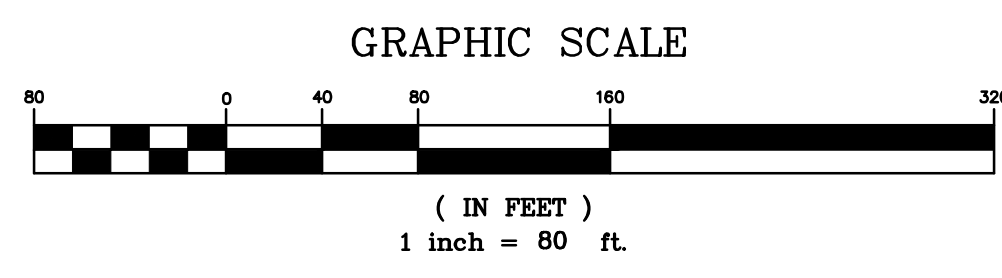
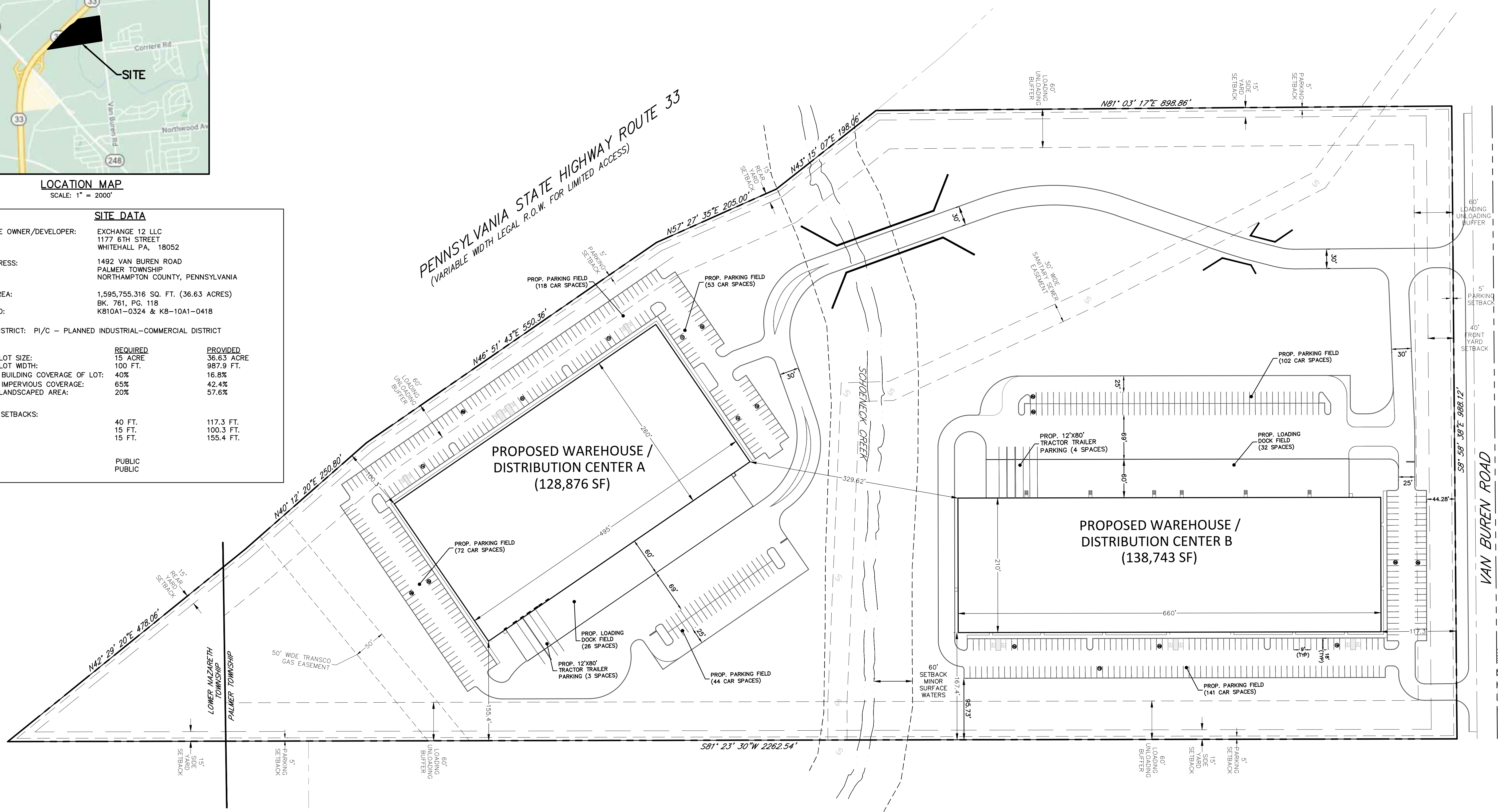

JENA ENGINEERING CORP.
CONSULTING ENGINEERS & SURVEYORS

JENA

2358 SUNSHINE ROAD
SUITE 200
ALLEN TOWN, PA. 18103
PHONE: (610) 797-4200
EMAIL: www.jenaengineering.com

CONDITIONAL USE PLAN
1492 VAN BUREN ROAD
PALMER TOWNSHIP
NORTHAMPTON COUNTY - PENNSYLVANIA

NO.	DATE	REVISIONS	BY

This drawing and its contents are copyright © 2011 JENA Engineering Corporation, and are the exclusive property of JENA Engineering Corporation, and may not be reproduced in any form without written authorization from JENA Engineering Corporation. Unauthorized reproduction, use for construction, or any other use of any or all parts of this drawing will constitute a violation of U. S. copyright laws. No third party may rely upon these plans without the consent of JENA Engineering Corporation. Field conditions should be confirmed prior to use for construction or other purposes. JENA Engineering Corporation assumes no obligation to supplement or update plans for changes, or any other reasons. All intellectual property rights, including (without limitation) design concepts, text, images, graphs, dimensions, details, any underlying databases, the layout, architectural, structural, and MEP design all remain the property of JENA Engineering Corporation or its licensors, unless otherwise indicated.

SHEET: 1 of 1
PROJECT: 034221
DATE: 4-01-2021
SCALE: 1" = 80'
DRAWN BY: DS
DESIGNED BY: BLR