

OFFICE SPACE FOR LEASE

FAIRVIEW EXECUTIVE PLAZA I

333 SALEM PLACE | FAIRVIEW HEIGHTS, IL, 62208 | I-64 & RTE. 159

CONTACT
ELLEN MANNION

314.880.0426

emannion@balkebrown.com

PROPERTY DESCRIPTION

Strategically located in the Fairview Heights Office Park, Fairview Executive Plaza I is situated at the center of a premier business and dynamic growth area.

Bordered by I-64 and Route 159, Fairview Executive Plaza I is directly across from St. Clair Square Mall and offers high visibility, convenient access to all markets and close proximity to Downtown St. Louis (15 minutes), Scott Airforce Base/Mid America Airport (12 minutes) and Lambert St. Louis International Airport (30 minutes).

- 1,023 - 4,903 sf available
- Two-story Class A office building
- All common areas recently upgraded (including restrooms)
- Monument signage available
- Immediate access to I-64 & Route 159
- Dozens of restaurants and services within the immediate area
- Convenient to I-255, I-70, I-55 and Illinois Routes 157, 158, 159 and 143
- Full Service Lease Rate: \$21.90 psf



OFFICE SPACE FOR LEASE

FAIRVIEW EXECUTIVE PLAZA I



333 SALEM PLACE | FAIRVIEW HEIGHTS, IL, 62208 | I-64 & RTE. 159

1ST FLOOR - FLOOR TO CEILING GLASS

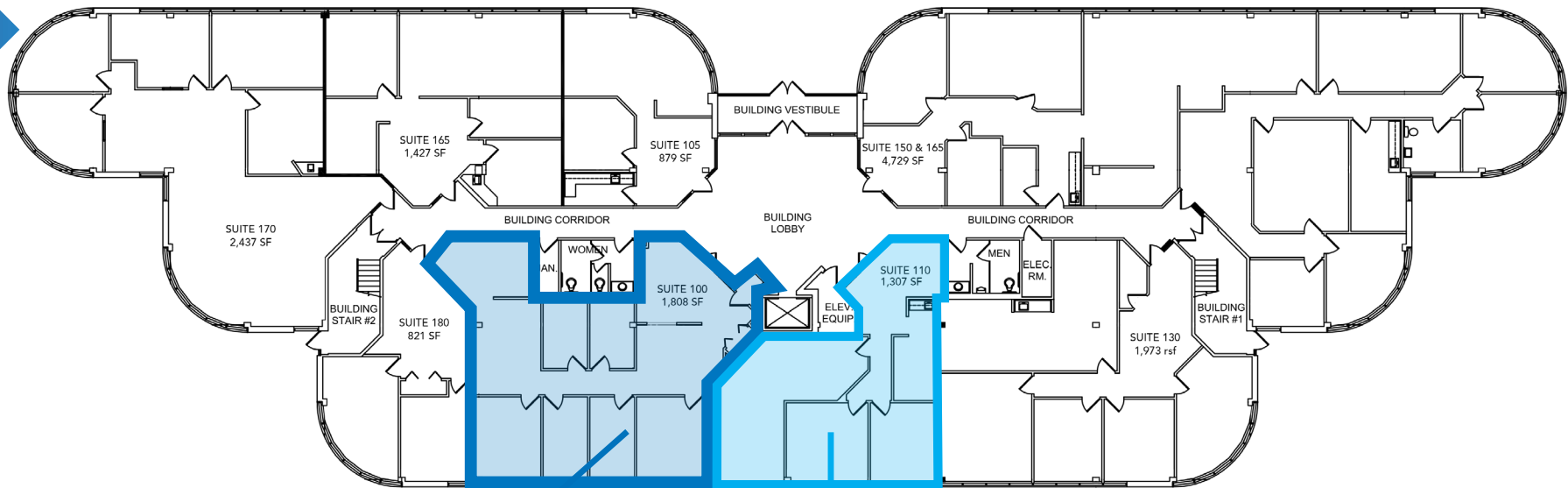

SUITE 100
(1,808 SF)

SUITE 110
(1,307 SF)

* Suite 100 & 110 Contiguous - 3,115 rsf

CONTACT

ELLEN MANNION

314.880.0426

emannion@balkebrown.com

The information provided herein was obtained from sources believed reliable; however, Transwestern makes no guarantees, warranties or representations as to the completeness or accuracy thereof. The presentation of this property is submitted subject to errors, omissions, change of price or conditions, prior sale or lease, or withdrawal without notice. Copyright © 2022 Transwestern.

OFFICE SPACE FOR LEASE

FAIRVIEW EXECUTIVE PLAZA I

333 SALEM PLACE | FAIRVIEW HEIGHTS, IL, 62208 | I-64 & RTE. 159



2ND FLOOR

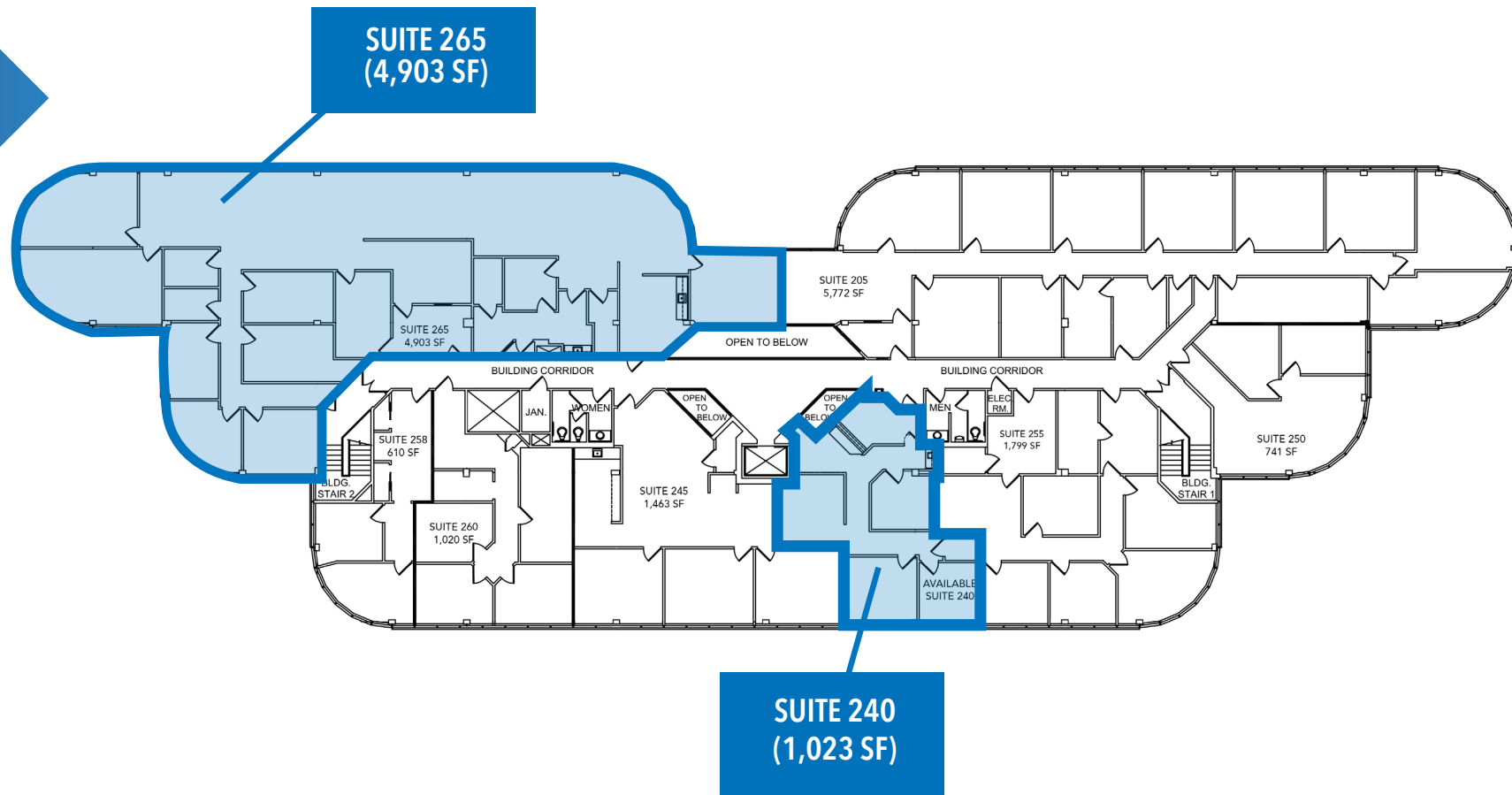

CONTACT ELLEN MANNION

314.880.0426
emannion@balkebrown.com

The information provided herein was obtained from sources believed reliable; however, Transwestern makes no guarantees, warranties or representations as to the completeness or accuracy thereof. The presentation of this property is submitted subject to errors, omissions, change of price or conditions, prior sale or lease, or withdrawal without notice. Copyright © 2022 Transwestern.

OFFICE SPACE FOR LEASE

FAIRVIEW EXECUTIVE PLAZA I

333 SALEM PLACE | FAIRVIEW HEIGHTS, IL, 62208 | I-64 & RTE. 159

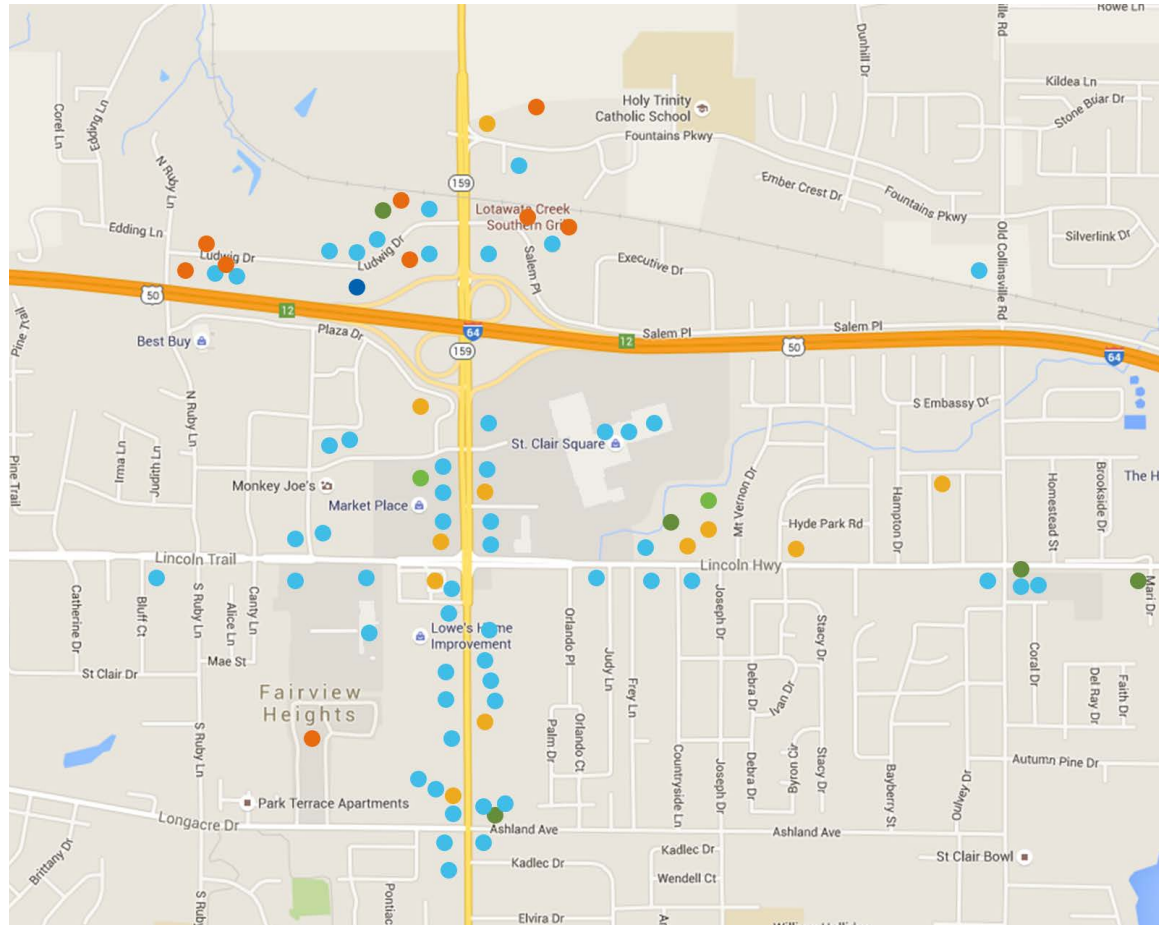

AMENITIES MAP

DINING

Lotawata Creek
TGI Fridays
Shogun Japanese
Steakhouse
Andria's Restaurant
Houlihan's
Bob Evans
Olive Garden
Applebee's
Joe's Crab Shack
Sbarro
Panda Express
Charley's Grilled Subs
Sarku Japan
Gyro Gyro
Cheddar's
Taco Bell
Ruby Tuesday
Hooters
Boston Market
Wasabi Sushi Bar
Red Robin
White Castle
Imo's Pizza
Arby's
Fortel's Pizza
Lilly Steak & Grill
China King
The Chuck Wagon

Burger King
Dandy Inn Irish Pub
Penn Station
Subway
McAlister's Deli
Long John Silver's
Show-Me's Sports Bar
Honey Baked Ham
McDonald's
Chipotle
Steak n Shake
Cayden's Diner
ERJ Dining
Smokey Bones
LongHorn Steakhouse
Popeyes
St. Louis Bread Co.
Firehouse Subs
Wing Street
Pasta Fare
Krispy Kreme
Fazoli's
Sushi Tatsu

LODGING

Holiday Inn
America's Best Value Inn
Four Points by Sheraton
Super 8
Drury Inn & Suites

Fairfield Inn
Comfort Suites
Hampton Inn
Marriott ExecuStay

GROCERY & PHARMACY

Fresh Thyme
Schnucks

BANKING

Centrue Bank
US Bank
Associated Bank
First Bank
HSBC Bank
First Community Credit Union
F&M Bank
Commerce Bank
Regions Bank

FITNESS CENTERS

Planet Fitness
Curves
Club Fitness
Dynamic Fitness

ENTERTAINMENT

St. Clair 10 Cine

CONTACT

ELLEN MANNION

314.880.0426

emannion@balkebrown.com

The information provided herein was obtained from sources believed reliable; however, Transwestern makes no guarantees, warranties or representations as to the completeness or accuracy thereof. The presentation of this property is submitted subject to errors, omissions, change of price or conditions, prior sale or lease, or withdrawal without notice. Copyright © 2022 Transwestern.