

Professional Office/  
Medical Space

**AVAILABLE**  
**FOR LEASE**

**5143**  
**Office Park Drive**  
Bakersfield, CA

### Property Highlights

- Fully improved dialysis center in central Bakersfield
- Division of space will be considered
- Convenient access from Truxtun Avenue and the Westside Parkway
- Professional and safe office area with medical and general office neighbors

The information contained herein may have been obtained from sources other than ASU Commercial. We have not verified such information and make no guarantees, warranties or representations about such information. It is your responsibility to independently confirm its accuracy and completeness prior to purchasing/leasing the property.



**Jonathon Ortiz** ▪ Associate ▪ 661 885 6948 ▪ [jonathon@asuassociates.com](mailto:jonathon@asuassociates.com) ▪ CA RE #02069258  
**Matthew E. Starr, SIOR, CCIM** ▪ Principal ▪ 661 616 3570 ▪ [matthew@asuassociates.com](mailto:matthew@asuassociates.com) ▪ CA RE #01367855  
**Martin J. Starr** ▪ Principal ▪ 661 616 3567 ▪ [mjstarr@asuassociates.com](mailto:mjstarr@asuassociates.com) ▪ CA RE #01179469  
11601 Bolthouse Drive Suite 110 ▪ Bakersfield, CA 93311 ▪ 661 862 5454 main ▪ 661 862 5444 fax

# Professional Office/Medical Space Available For Lease

## Floor Plan

5143 Office Park Drive • Bakersfield, CA

### Lease Offering

- **Availability** 21,809± SF  
Actual size of space to be determined
- **Rental Rate** Please contact listing agent
- **Tenant Improvements** Negotiable
- **Former Davita Dialysis Center**

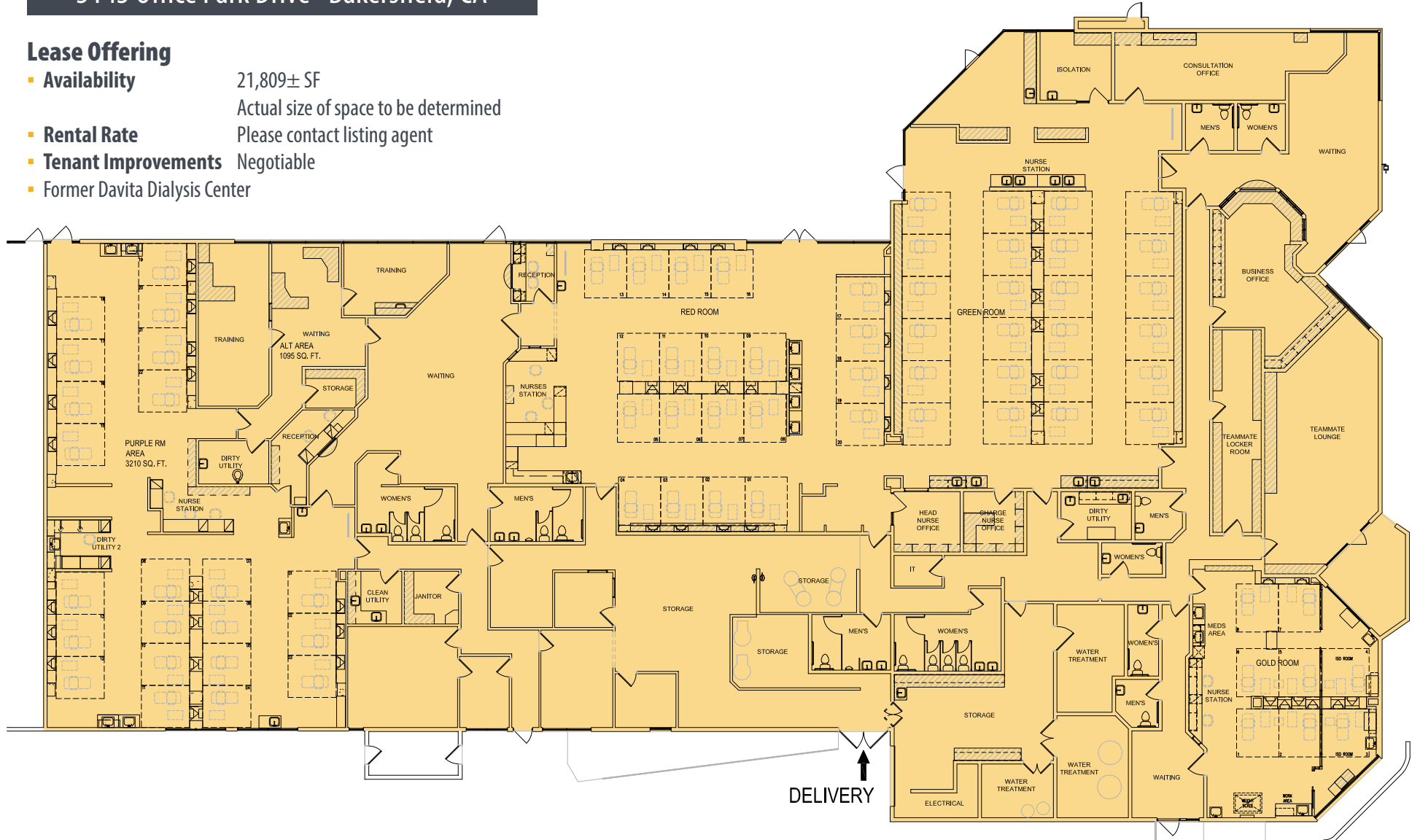

\*Plans deemed to be accurate, but not guaranteed. Plan not to scale.



# Professional Office/Medical Space Available For Lease

## Property Photos

5143 Office Park Drive • Bakersfield, CA

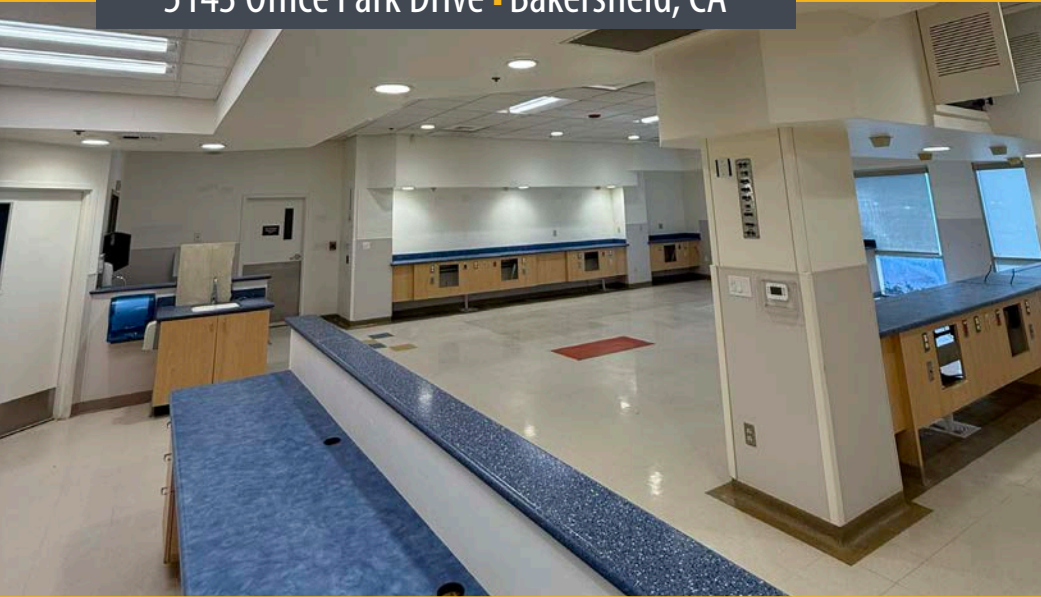



# Professional Office/Medical Space Available For Lease

## Property Photos

5143 Office Park Drive • Bakersfield, CA





# Professional Office/Medical Space Available For Lease

## Aerial Map

5143 Office Park Drive • Bakersfield, CA



5143 Office Park Drive

