

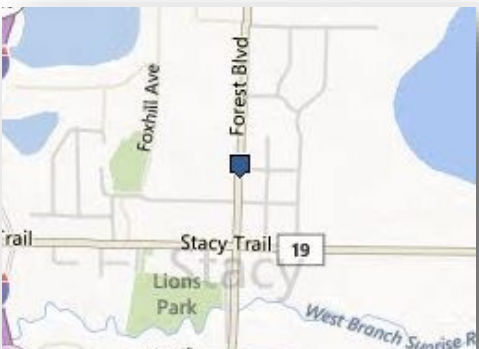

For Lease

31146 Forest Blvd., Stacy 55079



Stacy Commons

- MULTI-TENANT BUILDING
- 3 - Suites with Abundant Parking
- ADA Compliant - Common Area Restrooms
- Located on Hwy 61 - Great Signage / Visibility

* Suite 6 1,548 (Raw Space)

* Suite 7 947 (Raw Space)

* Suite 9 1,550 (Salon Space)

- Year Built: 2004
- Land Area: 1.78 Acres
- CAM & Taxes: 2021: \$2.91 psf
- Lease rates: Negotiable

For Information Contact:
Shawn Augustine
651-466-0427
saugustine@remax.net

RE/MAX
Synergy

A Muske Company
920 W. Broadway, Forest Lake, MN 55025
651-464-7070
www.remaxsynergy.com

RE/MAX
Synergy



Floor Plan

31146 Forest Blvd., Stacy 55079

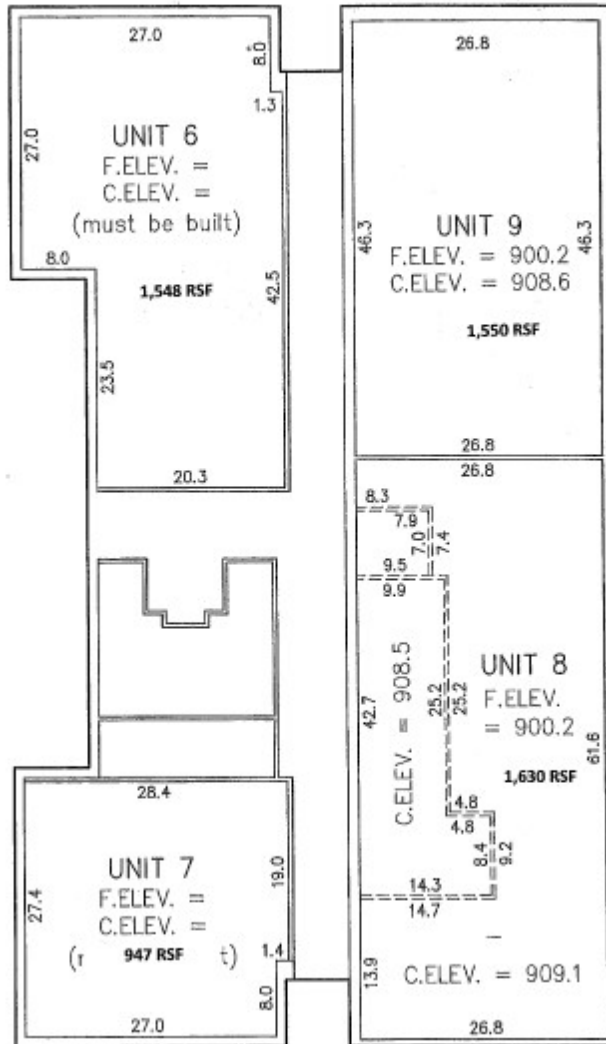

RE/MAX
Synergy

A Muske Company
920 W. Broadway, Forest Lake, MN 55025
651-464-7070
www.remaxsynergy.com

RE/MAX
Synergy



Demographics

31146 Forest Blvd., Stacy 55079

Population	2015 Projection			2016 Projection		
	< 1 Mile	< 3 Miles	< 5 Miles	< 1 Mile	< 3 Miles	< 5 Miles
Total Estimated Population	1,398	3,043	9,263	1,310	3,075	9,562
Total Census 2010 Population	1,528	2,767	8,239	1,528	2,767	8,239
Population Change %	-8.5%	12.2%	13.6%	-14.3%	14.1%	17.6%
Population Density (People/SQ Mile)	136	155	290	128	157	301
Median Age	38	38	42	38	41	43
Total Males	742	1,582	4,720	695	1,595	4,867
Total Females	656	1,461	4,543	615	1,480	4,695

Housing	2015 Projection			2016 Projection		
	< 1 Mile	< 3 Miles	< 5 Miles	< 1 Mile	< 3 Miles	< 5 Miles
Total Estimated Households	496	1,044	3,223	464	1,057	3,332
Total Census 2010 Households	554	933	2,815	554	933	2,815
Average Household Size	2.8	2.9	2.9	N/A	N/A	N/A
Total Housing Units	509	1,044	3,408	509	1,121	3,775
Owner	459	968	2,963	459	1,043	3,277
Renter	36	59	352	36	62	397
Vacant Housing Units	14	17	94	14	17	103

Household Expenditures	2015 Projection			2016 Projection		
	< 1 Mile	< 3 Miles	< 5 Miles	< 1 Mile	< 3 Miles	< 5 Miles
Total Annual Household	\$21,381,499	\$51,907,808	\$157,409,099	\$20,040,009	\$53,253,430	\$163,854,116
Average Annual Household	\$43,108	\$49,407	\$49,637	\$43,190	\$49,600	\$49,879
Food	\$5,528	\$6,183	\$6,204	\$5,475	\$6,149	\$6,195
Entertainment	\$2,235	\$2,654	\$2,672	\$2,272	\$2,732	\$2,758

RE/MAX
Synergy

A Muske Company
920 W. Broadway, Forest Lake, MN 55025
651-464-7070
www.remaxsynergy.com

RE/MAX
Synergy