

**Evans
Elder
Brown &
Seubert**

COMMERCIAL REAL ESTATE

101 E. Broadway
Suite 101
Eugene, OR 97401
(541) 345-4860

eebcre.com

FOR LEASE

1400 Valley River Drive | Suite 160
Eugene, Oregon 97401

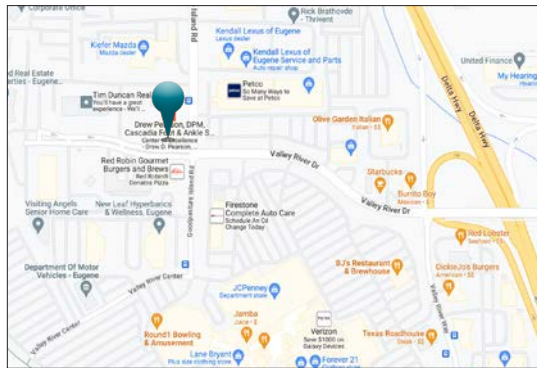

CONTACT

Alan Evans
alan@eebcre.com

Jeff Elder
jeff@eebcre.com

(541) 345-4860

Office Suite

- 1,826 square feet
- Adjacent to Valley River Center
- High quality finishes throughout the building
- Excellent On-site parking
- \$24.00 per square foot, triple net

Licensed in the State of Oregon



The information in this package was gathered from sources deemed reliable, however Evans Elder Brown & Seubert makes no representation or warranty of the accuracy of the information. Any buyer or tenant considering a purchase or lease of this property should confirm any and all information relied upon in making the decision to purchase or lease prior to finalizing the transaction and bears the risk of all inaccuracies.

Suite Description



Leased Premises:

- Reception
- Floor to ceiling windows
- Small private office or conference room
- Modern open workspace
- Restroom

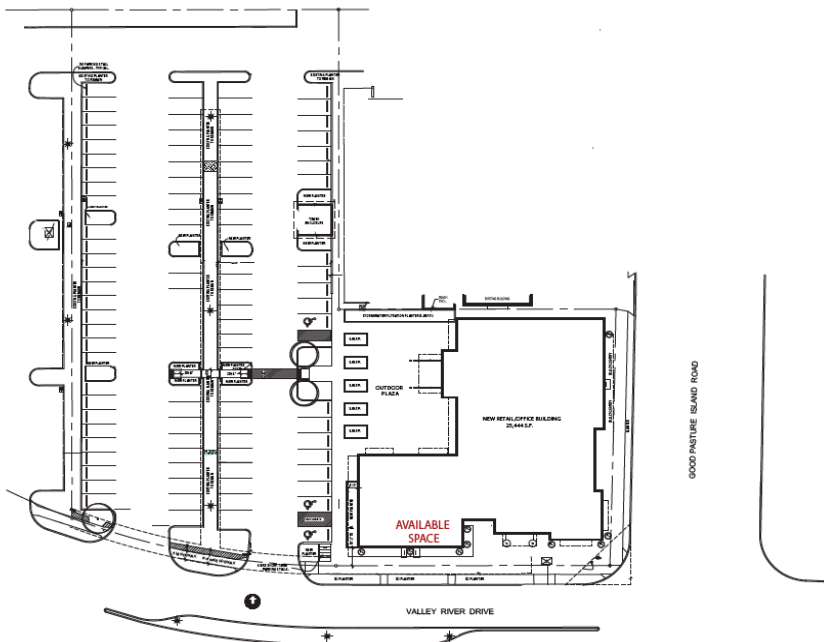

Floor Plan



Property Description



1400 Valley River Drive:

- 1400 Valley River Drive is a high-quality building with exceptional finishes, great visibility, and convenient access. With a total of 25,444 square feet, this impressive property is situated next to Valley River Center. This prime location, off of Delta Highway, is located approximately one mile west of Interstate 5.

Tenants:

- 1400 Valley River Drive tenants include: MB2 Dental, Mariner Wealth Advisors, Oregon ENT, Cascadia Foot & Ankle Podiatric, PeaceHealth Urgent Care, and Mezcaluna Restaurant.

Triple Nets:

Current annual triple net reimbursement is \$13.00 per square foot

- Property taxes
- Building insurance
- Common area maintenance
- Utilities

Ownership:



Aerial View

