

1511 ABBOT KINNEY BOULEVARD

VENICE, CALIFORNIA 90291



L I V E / W O R K / R E T A I L

jayluchs.com
For Lease
310 407 6585
Jay Luchs
Los Angeles

 **COLDWELL BANKER
COMMERCIAL**

NEWMARK

DAVID MALDONADO
T 323-702-2006
david.maldonado@cbcnrt.com
CA RE Lic. #01949738

JAY LUCHS
Vice Chairman
T 310-407-6585
jay.luchs@nmrk.com
CA RE Lic. #01260345
JAYLUCHS.COM

ADDRESS

1511 Abbot Kinney Boulevard
Venice, CA 90291

USE

Live/Work/Retail

Artist In Residence Use: will allow the manufacturing and sale of products in the building plus live/work within the premises

SIZE

Ground Floor: ±2,110 SF
2nd Floor: ±2,152 SF
3rd Floor: ±1,968 SF
TOTAL: ±6,230 SF

RENT

\$6 PSF per month NNN

NNN

±\$1.35 PSF per month



jayluchs.com
For Lease
310 407 6585
Jay Luchs
Los Angeles

 **COLDWELL BANKER
COMMERCIAL**

NEWMARK

DAVID MALDONADO
T 323-702-2006
david.maldonado@cbcnrt.com
CA RE Lic. #01949738

JAY LUCHS
Vice Chairman
T 310-407-6585
jay.luchs@nmrk.com
CA RE Lic. #01260345
JAYLUCHS.COM



HIGHLIGHTS

- Open layout
- Direct access from Abbot Kinney Blvd
- Floor to ceiling windows
- Garage
- Recessed and track lighting
- Multiple patios and balconies
- Restrooms
- Storage and cabinets
- Kitchen area on 3rd floor
- Great views of Abbot Kinney Blvd

jayluchs.com
For Lease
310 407 6585
Jay Luchs
Los Angeles

 **COLDWELL BANKER
COMMERCIAL**

NEWMARK

DAVID MALDONADO
T 323-702-2006
david.maldonado@cbcnrt.com
CA RE Lic. #01949738

JAY LUCHS
Vice Chairman
T 310-407-6585
jay.luchs@nmrk.com
CA RE Lic. #01260345
JAYLUCHS.COM

GROUND FLOOR

ABBOT KINNEY BOULEVARD

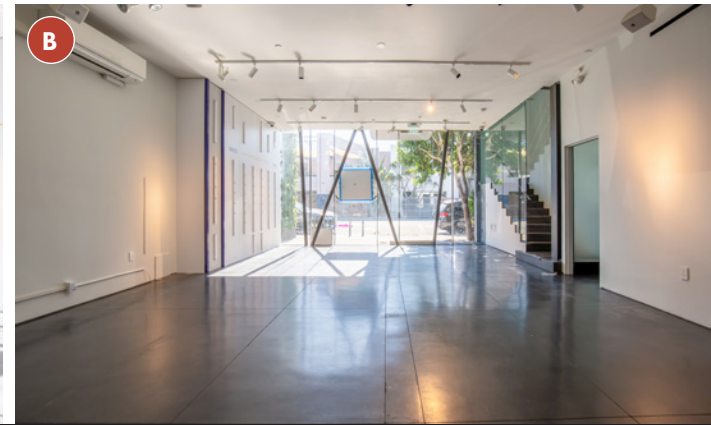
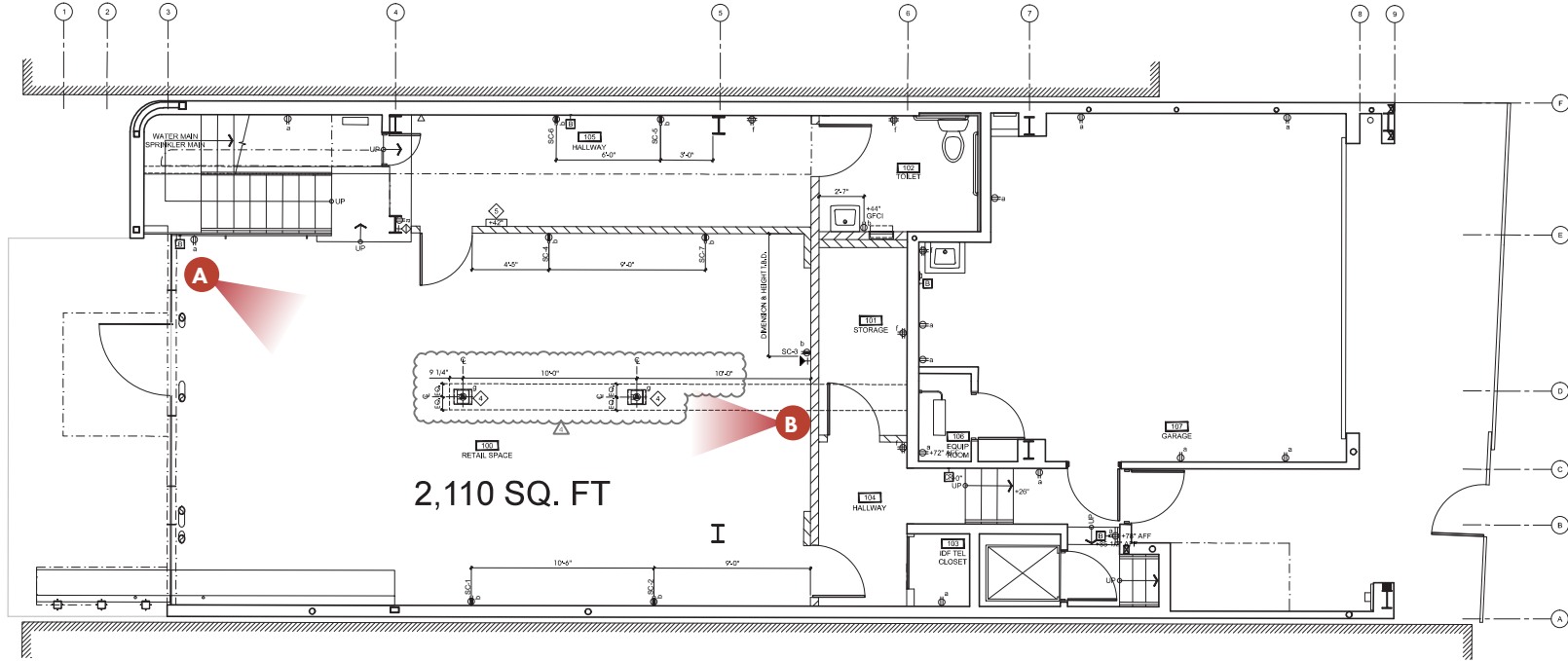

jayluchs.com
For Lease
310 407 6585
Jay Luchs
 Los Angeles

COLDWELL BANKER
COMMERCIAL

NEWMARK

DAVID MALDONADO
 T 323-702-2006
 david.maldonado@cbcnrt.com
 CA RE Lic. #01949738

JAY LUCHS
 Vice Chairman
 T 310-407-6585
 jay.luchs@nmrk.com
 CA RE Lic. #01260345
JAYLUCHS.COM

2ND FLOOR

ABBOT KINNEY BOULEVARD



jayluchs.com
For Lease
310 407 6585
Jay Luchs
Los Angeles

 **COLDWELL BANKER
COMMERCIAL**

NEWMARK

DAVID MALDONADO
T 323-702-2006
david.maldonado@cbcnrt.com
CA RE Lic. #01949738

JAY LUCHS
Vice Chairman
T 310-407-6585
jay.luchs@nmrk.com
CA RE Lic. #01260345
JAYLUCHS.COM

3RD FLOOR

ABBOT KINNEY BOULEVARD

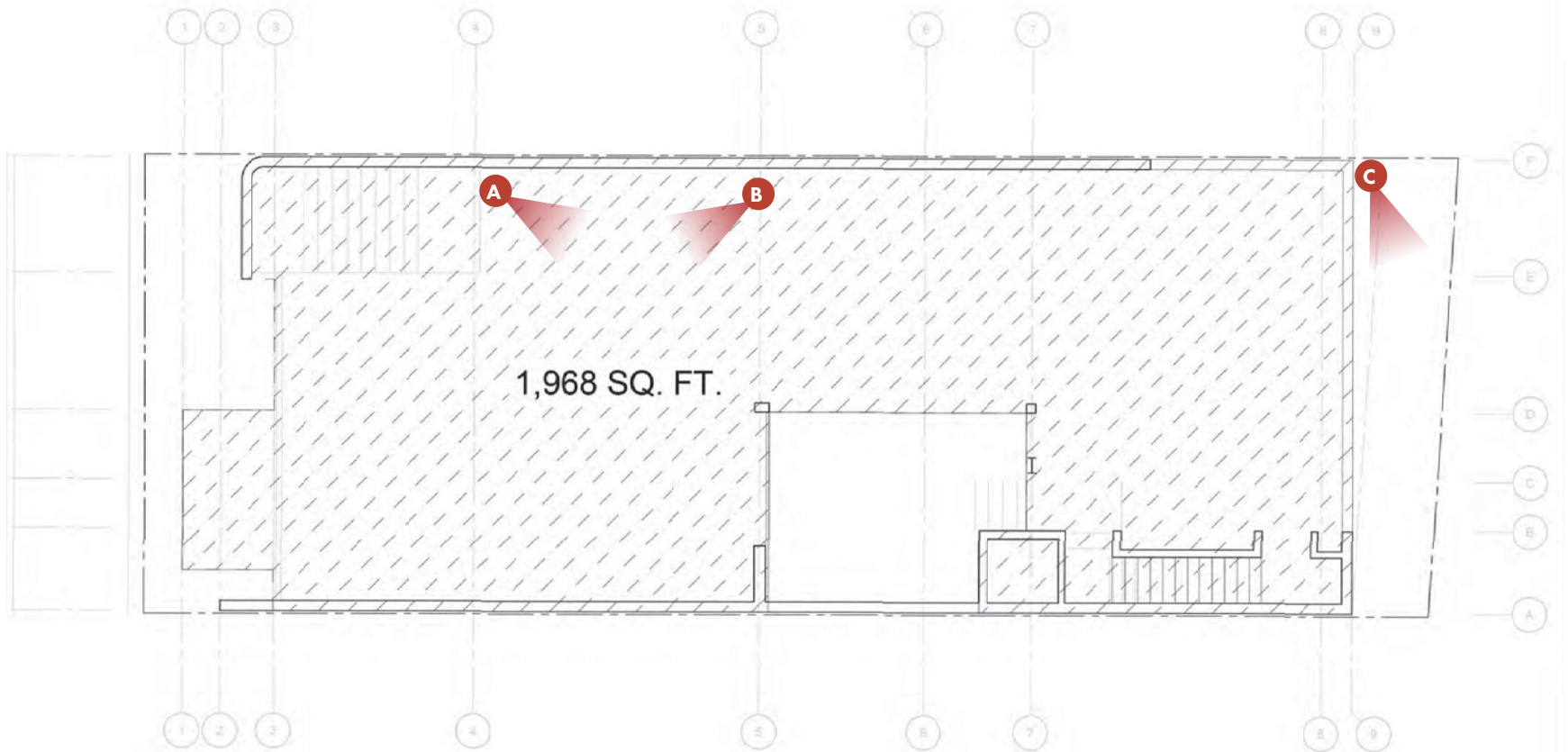

jayluchs.com
For Lease
310 407 6585
Jay Luchs
 Los Angeles

**COLDWELL BANKER
 COMMERCIAL**

NEWMARK

DAVID MALDONADO
 T 323-702-2006
 david.maldonado@cbcnrt.com
 CA RE Lic. #01949738

JAY LUCHS
 Vice Chairman
 T 310-407-6585
 jay.luchs@nmrk.com
 CA RE Lic. #01260345
JAYLUCHS.COM



The Brig

ZADIG & VOLTAIRE

nati

gorjana

GJELINA

Saje

Cha Cha

VINCE. Corridor satine
BILLY REID adidas

	Distance	Time
Venice Beach	0.8 Miles	±4 Mins
Santa Monica Airport	2.4 Miles	±9 Mins
Downtown Santa Monica	2.8 Miles	±12 Mins
LAX Airport	6.8 Miles	±21 Mins
Westfield Century City	7.4 Miles	±23 Mins
Beverly Hills	10.2 Miles	±28 Mins

For Lease
310 407 6585
Jay Luchs
Los Angeles

COLDWELL BANKER COMMERCIAL

NEWMARK

DAVID MALDONADO
T 323-702-2006
david.maldonado@cbcnrt.com
CA RE Lic. #01949738

JAY LUCHS
Vice Chairman
T 310-407-6585
jay.luchs@nmrk.com
CA RE Lic. #01260345
JAYLUCHS.COM



Cha Cha



BURRO

garfana

Saje

GJELINA
take away

GJELINA

nati

ZADIG & VOLTAIRE

bcd

The Brig

Aesop

GRACE LOVES LACE

jayluchs.com
For Lease
310 407 6585
Jay Luchs
Los Angeles

**COLDWELL BANKER
COMMERCIAL**

NEWMARK

DAVID MALDONADO
T 323-702-2006
david.maldonado@cbcnrt.com
CA RE Lic. #01949738

JAY LUCHS
Vice Chairman
T 310-407-6585
jay.luchs@nmrk.com
CA RE Lic. #01260345
JAYLUCHS.COM



jayluchs.com
For Lease
310 407 6585
Jay Luchs
Los Angeles

 **COLDWELL BANKER**
COMMERCIAL

NEWMARK

DAVID MALDONADO
T 323-702-2006
david.maldonado@cbcnrt.com
CA RE Lic. #01949738

JAY LUCHS
Vice Chairman
T 310-407-6585
jay.luchs@nmrk.com
CA RE Lic. #01260345
JAYLUCHS.COM

1101 **EVERLANE**
 1103 **AWAY THE GREAT.**
 1107 Kevin
 1117 General Admission
 1121 AHLEM Eyewear
 1121 **LCD**
 1121 Under Construction

SAN JUAN AVENUE
 1201 Only the Wild Ones
 1205 **THE BUTCHER'S DAUGHTER**
 1209 **DCX NIGHTCLUB**
 1219 Goodies
 1221 **K KEETSA**
 1223 Flannel
 1225 Cookman
 1227 MC2 St. Barth
 1227 Burning Torch
 1239 **greenleaf** gourmet chopshop



1101 **EVERLANE**
 1103 **AWAY THE GREAT.**
 1107 Kevin
 1117 General Admission
 1121 AHLEM Eyewear
 1121 **LCD**
 1121 Under Construction

1101 **EVERLANE**
 1103 **AWAY THE GREAT.**
 1107 Kevin
 1117 General Admission
 1121 AHLEM Eyewear
 1121 **LCD**
 1121 Under Construction

SAN JUAN AVENUE
 1201 Only the Wild Ones
 1205 **THE BUTCHER'S DAUGHTER**
 1209 **DCX NIGHTCLUB**
 1219 Goodies
 1221 **K KEETSA**
 1223 Flannel
 1225 Cookman
 1227 MC2 St. Barth
 1227 Burning Torch
 1239 **greenleaf** gourmet chopshop

ABBOT KINNEY BOULEVARD

SANTA CLARA AVENUE

1301 Vardagen
 1305 For Lease
 1311 Offices
 1315 Vacant
 1317 Hamilton Press Gallery
 1319 **I R O**
 1321 Under Construction
 1323 **PRINCIPISSA**
 1327 **velvet**
 1327 1/2 John Fluevog
 1329 Art Unified
 1329 **illesteva**
 1331
 1333 ASA Kafians
 1335 **calabro**
 1335 future **TODD SNYDER**
 1337 **CHRISTY DAWN**
 1341 Beauvillia Glass Designs
 1345 Stable Road Capital
 1349
 1351 future **BILLY REID** Originals
 1353 **VINCE. (Women)**
 1355 **VINCE. (Men)**
 1357 **SALE & STAGE** satine Corridor

SANTA CLARA AVENUE

1301 Vardagen
 1305 For Lease
 1311 Offices
 1315 Vacant
 1317 Hamilton Press Gallery
 1319 **I R O**
 1321 Under Construction
 1323 **PRINCIPISSA**
 1327 **velvet**
 1327 1/2 John Fluevog
 1329 Art Unified
 1329 **illesteva**
 1331
 1333 ASA Kafians
 1335 **calabro**
 1335 future **TODD SNYDER**
 1337 **CHRISTY DAWN**
 1341 Beauvillia Glass Designs
 1345 Stable Road Capital
 1349
 1351 future **BILLY REID** Originals
 1353 **VINCE. (Women)**
 1355 **VINCE. (Men)**
 1357 **SALE & STAGE** satine Corridor

CALIFORNIA AVENUE

1401 **Cher Cha**
 1403 **KOIO** (Renovating)
 1405 Erda King
 1407 **BURRO** by Firefly Live/Work For Lease
 1413B
 1415 Classic Touch Tattoo Parlour
 1419 **gorjana**
 1421 **Sage** Lemuria
 1233
 1427 **HELENA** Take Away
 1429 **HELENA**

1511 ABBOT KINNEY BOULEVARD
 VENICE, CALIFORNIA 90291

CALIFORNIA AVENUE

1401 **Cher Cha**
 1403 **KOIO** (Renovating)
 1405 Erda King
 1407 **BURRO** by Firefly Live/Work For Lease
 1413B
 1415 Classic Touch Tattoo Parlour
 1419 **gorjana**
 1421 **Sage** Lemuria
 1233
 1427 **HELENA** Take Away
 1429 **HELENA**

MILLWOOD AVENUE

1503 **THATI**
 1505 Residential
 1507 Under Construction
 1509 **ZADIG & VOLTAIRE**
 1511
 1515 **The Bay**
 Royal Heritage Tattoo & Piercing

MILLWOOD AVENUE

1503 **THATI**
 1505 Residential
 1507 Under Construction
 1509 **ZADIG & VOLTAIRE**
 1511
 1515 **The Bay**
 Royal Heritage Tattoo & Piercing

PALMS BOULEVARD

1605 Beverage Pop-up
 1609 Offices
 1611 Offices
 1615 Chiropractor
 1617 **BUCK MASON** Stronghold
 1621 **SHINOLA** **HAYABONE** Stronghold
 1623
 1625
 1629
 1633 **THE TASTING KITCHEN**
 1635 Owa Kitchen+Bar
 1639 Construction
 1645 Residential
 1641 Inkerman
 1653A pressed juicery
 1653B **ALFRED** CRAFT BEER
 1661

PALMS BOULEVARD

1605 Beverage Pop-up
 1609 Offices
 1611 Offices
 1615 Chiropractor
 1617 **BUCK MASON** Stronghold
 1621 **SHINOLA** **HAYABONE** Stronghold
 1623
 1625
 1629
 1633 **THE TASTING KITCHEN**
 1635 Owa Kitchen+Bar
 1639 Construction
 1645 Residential
 1641 Inkerman
 1653A pressed juicery
 1653B **ALFRED** CRAFT BEER
 1661

1101 **EVERLANE**
 1103 **AWAY THE GREAT.**
 1107 Kevin
 1117 General Admission
 1121 AHLEM Eyewear
 1121 **LCD**
 1121 Under Construction

SAN JUAN AVENUE
 1201 Only the Wild Ones
 1205 **THE BUTCHER'S DAUGHTER**
 1209 **DCX NIGHTCLUB**
 1219 Goodies
 1221 **K KEETSA**
 1223 Flannel
 1225 Cookman
 1227 MC2 St. Barth
 1227 Burning Torch
 1239 **greenleaf** gourmet chopshop

1101 **EVERLANE**
 1103 **AWAY THE GREAT.**
 1107 Kevin
 1117 General Admission
 1121 AHLEM Eyewear
 1121 **LCD**
 1121 Under Construction

SAN JUAN AVENUE
 1201 Only the Wild Ones
 1205 **THE BUTCHER'S DAUGHTER**
 1209 **DCX NIGHTCLUB**
 1219 Goodies
 1221 **K KEETSA**
 1223 Flannel
 1225 Cookman
 1227 MC2 St. Barth
 1227 Burning Torch
 1239 **greenleaf** gourmet chopshop

ABBOT KINNEY BOULEVARD

CRADIZ COURT

1302
 1308 Art Gallery Pop Up
 1310 **MedMen**
 1316 The Mac Studio
 1316 1/2 **HUSET**
 1320 Office building
 1324 For Lease
 1326 future **FARM RIO**

CRADIZ COURT

1302
 1308 Art Gallery Pop Up
 1310 **MedMen**
 1316 The Mac Studio
 1316 1/2 **HUSET**
 1320 Office building
 1324 For Lease
 1326 future **FARM RIO**

ANDAULSIA AVENUE

1338 **FAIRBY**
 1340 future **J CREW**
 1342 1/2 Bigfiare Fellow
 1344 **Our Place**
 1346 Residential / Office Space
 1348 Good
 1350 Sugar Nail
 1350 Friday Beers
 1354 **AVADA**
 1356 DS&D URG
 1358 **TUTTI**
 1360 Mens Liquor Market
 1362 **Macdowell**
 1410 Sandcloud
 1410 Naadam
 1410 Live
 1410 **TIMBUK2**
 1410 The Things We Do
 1420 **WARBY PARKER**
 1422
 1424
 1428 Vacant
 1430 Offices
 1432 Pudu Pudu
 1502 **Turnabout & Dandelion**
 1504 Topdrawer
 1504 **AESOP**
 1506 Mami Wata
 1508 lobby Hartley
 1510
 1514 For Lease
 1518 Office/Residence
 1520 Artist Studio / Residence
 1522 Garrett Leigh California Optical
 1522 Southern California Vibes Co.
 1524 Halton Pardee + Partners, Inc.

ANDAULSIA AVENUE

1338 **FAIRBY**
 1340 future **J CREW**
 1342 1/2 Bigfiare Fellow
 1344 **Our Place**
 1346 Residential / Office Space
 1348 Good
 1350 Sugar Nail
 1350 Friday Beers
 1354 **AVADA**
 1356 DS&D URG
 1358 **TUTTI**
 1360 Mens Liquor Market
 1362 **Macdowell**
 1410 Sandcloud
 1410 Naadam
 1410 Live
 1410 **TIMBUK2**
 1410 The Things We Do
 1420 **WARBY PARKER**
 1422
 1424
 1428 Vacant
 1430 Offices
 1432 Pudu Pudu
 1502 **Turnabout & Dandelion**
 1504 Topdrawer
 1504 **AESOP**
 1506 Mami Wata
 1508 lobby Hartley
 1510
 1514 For Lease
 1518 Office/Residence
 1520 Artist Studio / Residence
 1522 Garrett Leigh California Optical
 1522 Southern California Vibes Co.
 1524 Halton Pardee + Partners, Inc.

RIALTO AVENUE

1612 Skylark
 1616 Piccolo Ristorante
 1624 **FRANKIE BIKINIS**
 1628 AK Studios
 1632 Office
 1636 BlackCrows (upstairs)
 1636 Lavish Tan (Upstairs)
 1636 Hoff Optometry and Eyewear
 1638 **BUCK MASON** - Moving
 1644 FP Movement
 1644C Logan Hollowell
 1650 **GROW** - Lot For Sale
 1656 Office

RIALTO AVENUE

1612 Skylark
 1616 Piccolo Ristorante
 1624 **FRANKIE BIKINIS**
 1628 AK Studios
 1632 Office
 1636 BlackCrows (upstairs)
 1636 Lavish Tan (Upstairs)
 1636 Hoff Optometry and Eyewear
 1638 **BUCK MASON** - Moving
 1644 FP Movement
 1644C Logan Hollowell
 1650 **GROW** - Lot For Sale
 1656 Office

The information contained herein has been obtained from sources deemed reliable but has not been verified and no guarantee, warranty or representation, either express or implied, is made with respect to such information. Terms of sale or lease and availability are subject to change or withdrawal without notice.

JAY LUCHS
 STREET MAP

jayluchs.com
For Lease
310 407 6585
Jay Luchs
 Los Angeles

COLDWELL BANKER COMMERCIAL

NEWMARK
 Corporate RE License #01355491

DAVID MALDONADO
 T 323-702-2006
 david.maldonado@cbcnrt.com
 CA RE Lic. #01949738

JAY LUCHS
 Vice Chairman
 T 310-407-6585
 jay.luchs@nmrk.com
 CA RE Lic. #01260345
JAYLUCHS.COM