



OFFICE SPACE | FOR SALE

**101 CONNER DR**

CHAPEL HILL, NC

**ATLAS STARK**



# SALE/LEASE INFORMATION

## PROPERTY OVERVIEW

ASKING PRICE	\$1,099,000
PRICE PER SF	\$241.49/SF
ADDRESS	101 Conner Dr
SUITES	201 and 202
CITY	Chapel Hill
AREA	± 4,551 SF

Now available: 101 Conner Drive, formerly home to a medical practice and a financial advisor's office . Conveniently located just 2.5 miles from the US-501 and I-40 intersection and 3 miles from UNC Hospital, the property provides excellent accessibility. The building is anchored by reputable tenants, including Allergy Partners of Chapel Hill, a dentist, and an orthodontist, and features ample on-site parking.







# FLOOR PLAN

101 Conner Dr  
SUITE 201 & 202  
4,551 SQ. FT.

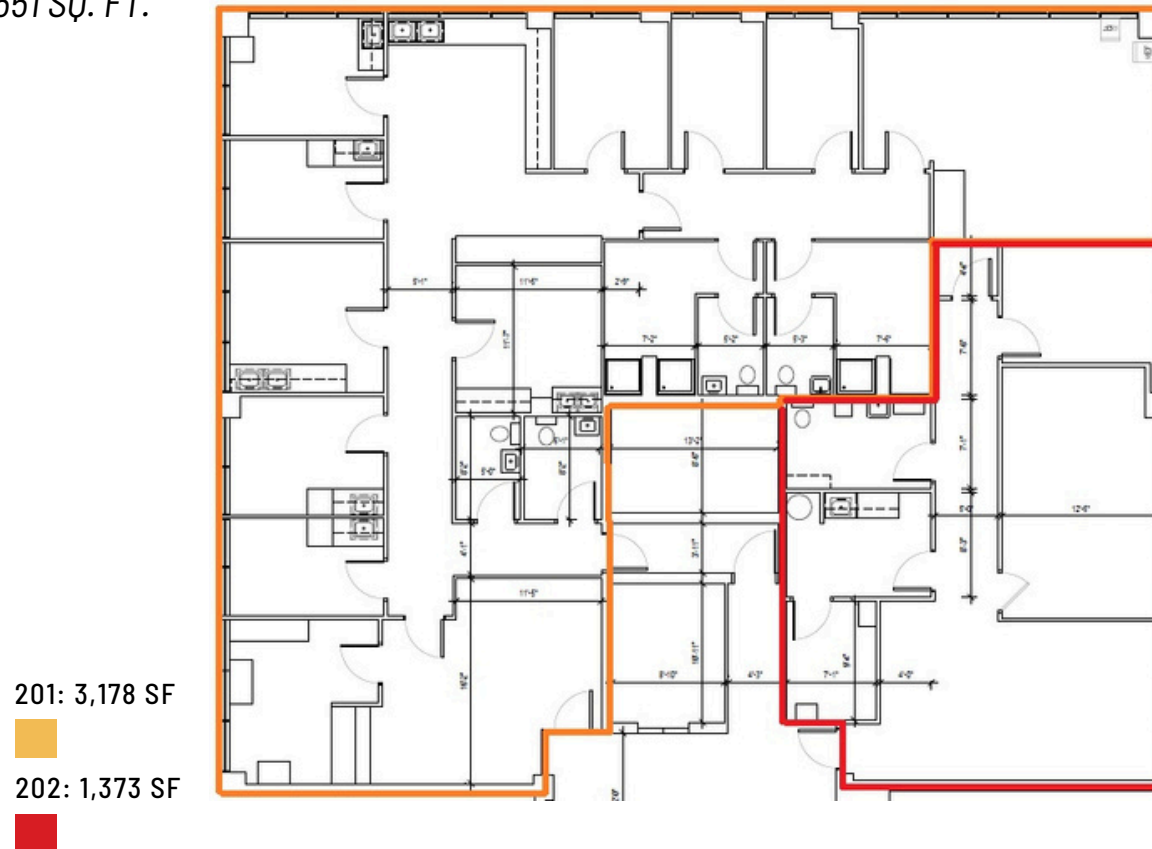

\*The space is comprised of approximately  $\frac{3}{4}$  medical office and  $\frac{1}{4}$  general office, offering flexibility for a range of users. The space offers 6 exam rooms, a lab, 4 bathrooms, a break room, and two entrances.





BRUEGGER'S  
BAGELS  
EST. 1980  
AUTHENTIC NEW YORK STYLE



TRADER JOE'S

Wegmans

SITE

VILLAGE PLAZA  
WHOLE FOODS  
MARKET

petco



barre3

CAVA



UNIVERSITY  
PLACE  
SILVERSPOT  
CINEMA



HAWKERS



THE UNIVERSITY  
of NORTH CAROLINA  
at CHAPEL HILL

UNC  
HEALTH



# 101 CONNER DRIVE

## CHAPEL HILL, NC 27514

### CONTACT

Tyler Christensen, Broker  
(C) 828.999.9459  
tchristensen@atlasstark.com

Trent Ragland, Broker  
(C) 919.815.8414  
tragland@atlasstark.com

ATLAS  STARK

Atlas Stark Holdings LLC | 2020 Progress Ct, Suite 130A, Raleigh, NC  
All information contained herein is from sources deemed reliable;  
however, no representation or warranty is made to the accuracy thereof.