

# 1353

**WALKER LANE**  
CORONA | CALIFORNIA



**FOR LEASE | 14,442 SF**

***Voit***  
REAL ESTATE SERVICES

# PROPERTY DETAILS

- ±14,442 SF Industrial building
- ±1,734 Square Feet of 2-Story Office
- 1 Grade Level Loading Door
- 1 Dock High Loading Door
- 24' Warehouse Ceiling Height
- 200 Amps Electrical Service
- 31 Parking Spaces
- Fenced Yard Area
- Desirable Corona Location
- Close Proximity to the Ontario (I-15) and Riverside (91) Freeway

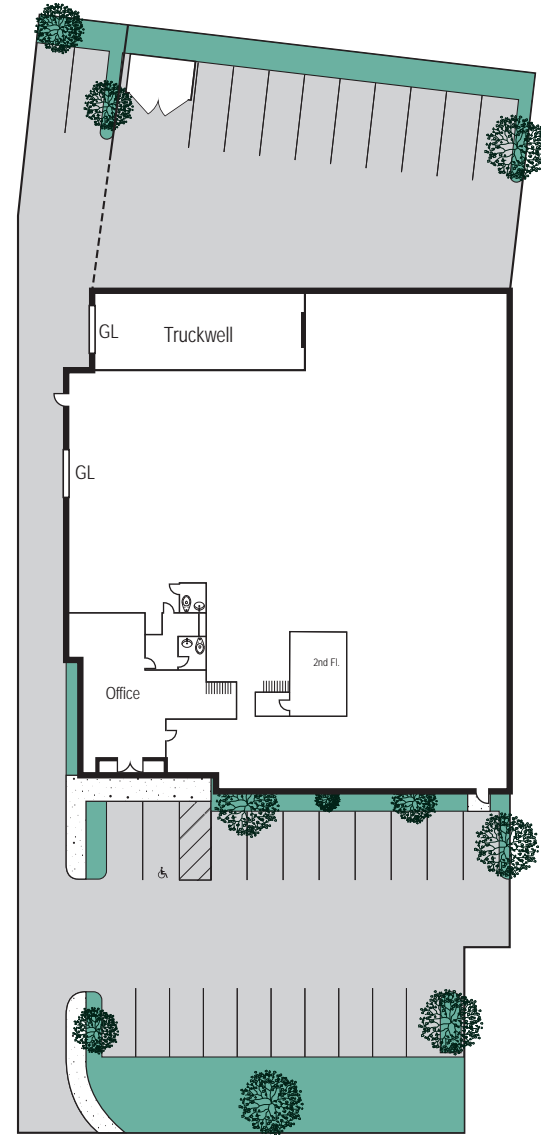

WALKER LN

## MITCH ZEHNER EXECUTIVE VICE PRESIDENT

714.935.2307  
mzehner@voitco.com  
License 00882464

## MICHAEL ZEHNER SENIOR VICE PRESIDENT

714.935.2328  
mczehner@voitco.com  
License 01917963

## RYAN MOORE EXECUTIVE VICE PRESIDENT

909.545.8011  
rmmore@voitco.com  
License 01821438

**Voit**  
REAL ESTATE SERVICES

2020 MAIN STREET | SUITE 100 | IRVINE | CALIFORNIA 92614 | 949.851.5100 | VOITCO.COM

Licensed as a Real Estate Broker by the DRE. The information contained herein has been obtained from sources we deem reliable. While we have no reason to doubt its accuracy, we do not guarantee it. ©2025 Voit Real Estate Services, Inc. All Rights Reserved. Lic. #01991785