



THE ROOT

BUILDERS

OMAHA, NE

1501 MIKE FAHEY STREET, SUITE 110
OMAHA, NE 68102

Welcome to Builders

Welcome to The Root Coworking – Builders! Located at **1501 Mike Fahey Street** in Downtown Omaha's Builders District. This space is where productivity and community come together in perfect harmony. Designed with intention, this location features everything from spacious flexible coworking spaces to fully furnished private offices, all wrapped in an environment that's as inspiring as it is functional.

Omaha's Builders District is known for its energy, innovation, and growth, so it's only fitting that we've joined the neighborhood. Whether you're looking to put your head down and focus, host a meeting in style, or network with Omaha's brightest minds, The Root Coworking is here to support your goals—and make your workday anything but ordinary.

From thoughtfully designed workspaces to curated events and endless coffee, this is the kind of workplace you'll actually look forward to coming to. So, take a break from the home office, leave behind the noisy coffee shop, and join a community that's built to grow, just like you.



Memberships

At The Root, we don't just offer workspace—but we create spaces where you can do your best work. Our memberships are intentionally designed to meet you where you are, but scale to where you want to go. Whether you are looking to create the ideal HQ for your growing team, or simply need flexible coworking access to accommodate your busy schedule, we have a plan tailored to you.

Team Suite



Inquire for pricing

Private suites featuring a mix of offices and open space. Perfect for larger teams of 10+ people.

Private Office



Inquire for pricing

Move-in ready offices for individuals and small to mid-size teams.

Dedicated Desk



\$350/month

Your own height-adjustable desk with lockable storage and 24/7 access.

Warm Desk



\$120/month

Our part-time membership, equipped with 8-days access per month.

Hot Desk

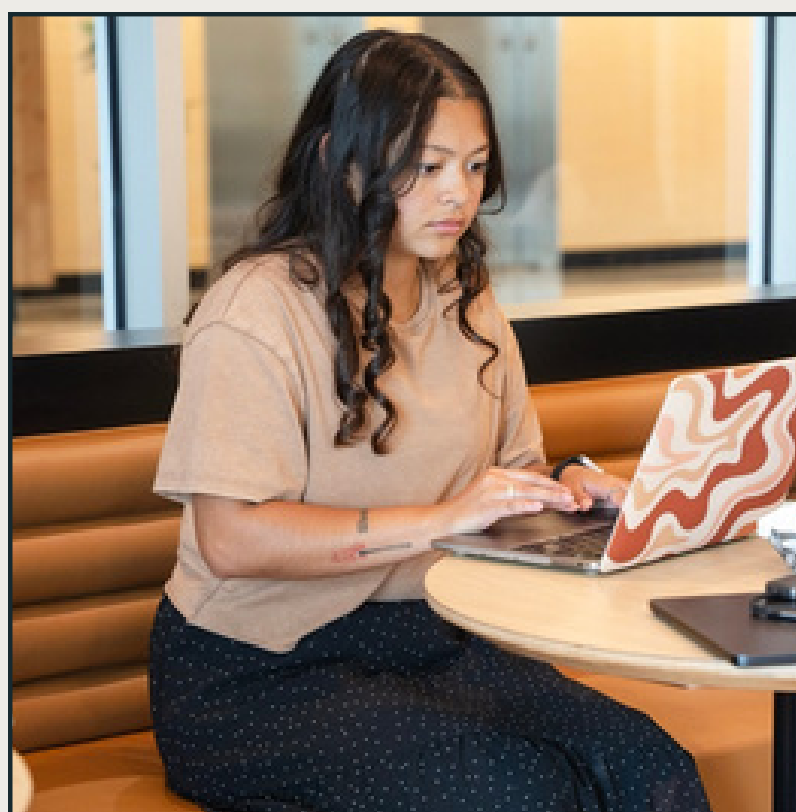

\$215/month

The classic coworking membership, plug & play from any of our shared space areas.

Team Pass



\$365/month

A recurring combination of day passes and meeting room hours for teams needing flexibility.

Location Amenities



24/7
Access



Fast & Secure
Wi-Fi



Chat
Booths



Showers &
Lockers



Café



Community
Events



A/V Equipped
Meeting Rooms



Podcast
Studio



Mail Services



Hospitable
Staff



Bottomless Craft
Coffee



Event Space



Wellness Room



Stocked
Kitchens



Printing Services



Dedicated
Parking



Highlights



A variety of meeting rooms up to 12 people



Builder's Green Urban Park accross the street



Private event space for up to 60 people



Social, educational & wellness events calendar



Fly Fitness (On-Site)



Patios & green spaces

Meet our Space

Legend

- Small Office (1-2)
- Medium Office (3-4)
- Large Office (5-8)
- XLarge Office (9+)
- Team Suite

Meeting Spaces

- Chat Booths 15
- Meeting Rooms 6
- Event Room 1
- Podcast Studio 1

Suite Specs

| Suite | LSF | Workstations |
|-------|-------|--------------|
| 1 | 1,476 | 23 |
| 2 | 624 | 12 |
| 3 | 829 | 14 |
| 16 | 704 | 16 |
| 31 | 342 | 7 |

1st Floor

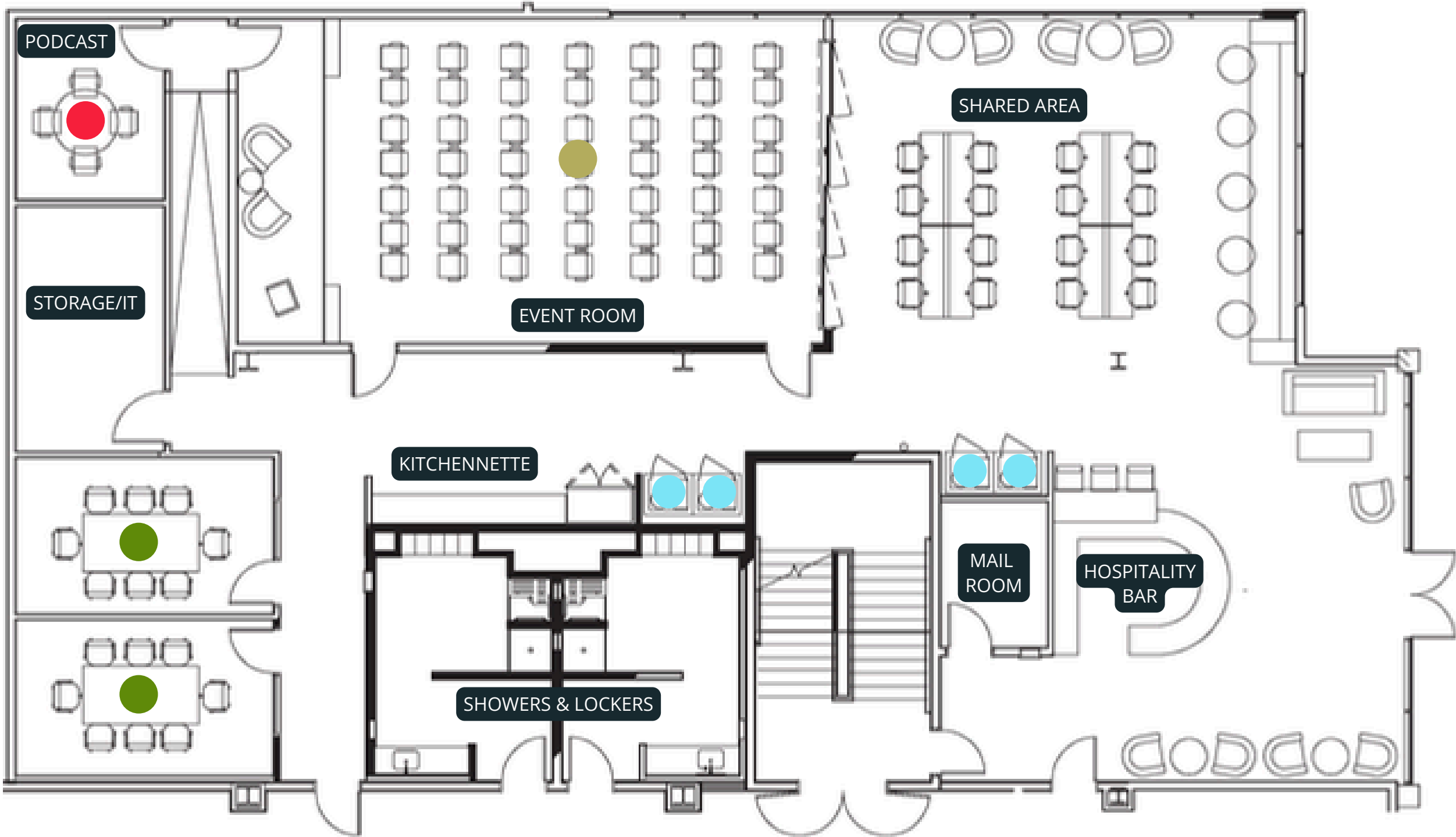

2nd Floor



Location

Located in dynamic Downtown Omaha, the Builders District offers a unique blend of urban convenience and community charm. The area is strategically positioned near the heart of the city, and a quick walk to numerous attractions, green spaces, restaurants, and nightlife fun.

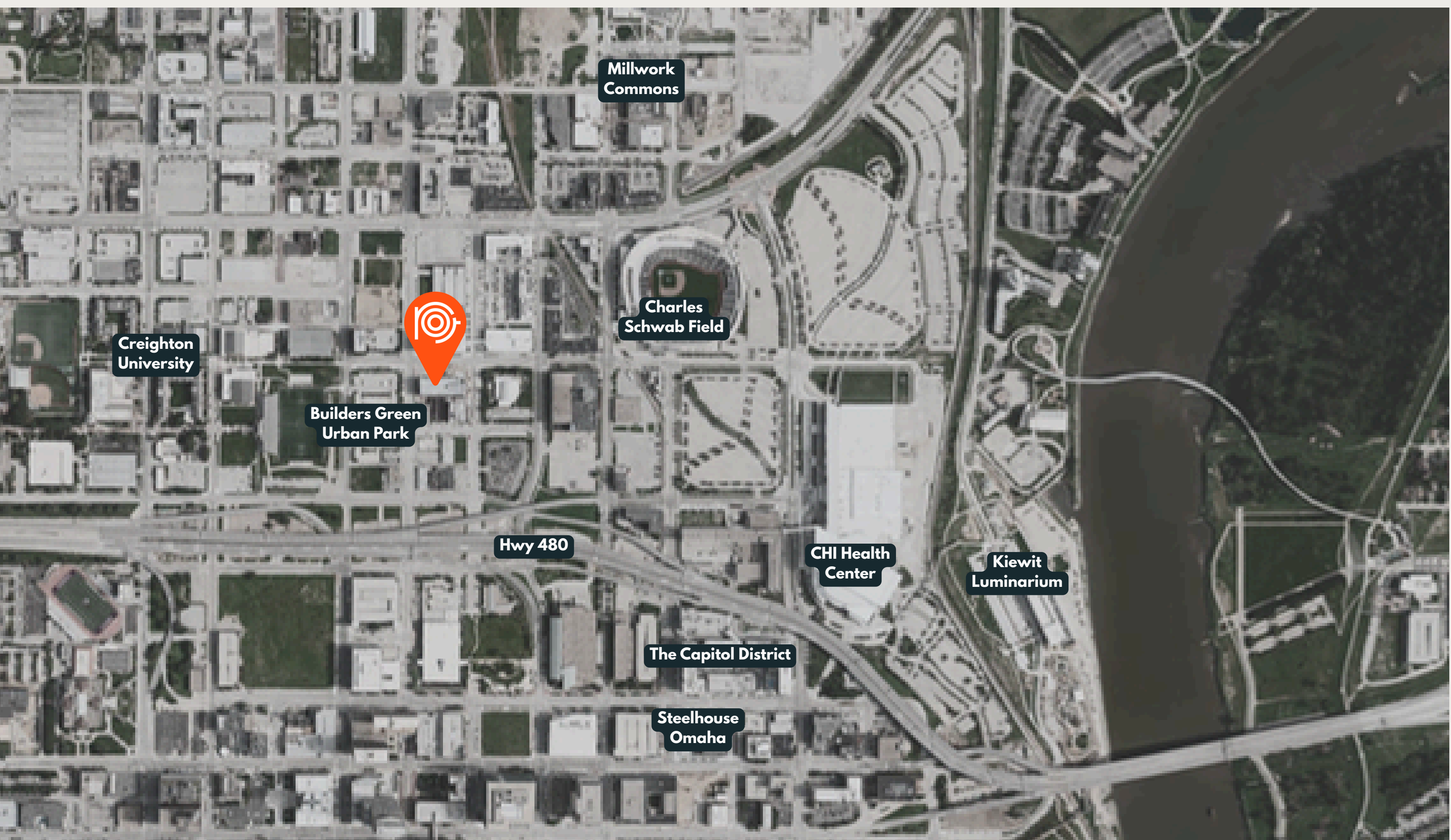

1 - 5 Minutes

Creighton University
Charles Schwab Field
CHI Health Center
Omaha Performing Arts Center
Highway 480 & 75
Kiewit Luminarium

5 - 10 Minutes

Eppley Airfield
Old Market
Dundee-Happy Hollow District
Blackstone District
Turner Park
University of Nebraska Medical Center

10 - 15 Minutes

Aksarben Village
University of Nebraska-Omaha

The Neighborhood

Omaha is an attractive area for everyone. Whether you are looking for great food, a team-building happy hour spot, or a night out on the town, Omaha has it all. Here are a few of our recommendations:

BREAKFAST/COFFEE

Archetype Coffee - Millwork
Rally Coffee Co
Fig.

HAPPY HOUR

Memoir
Blatt Beer & Table
Lefty's

ATTRACTIONS

Slowdown
Charles Schwab Field
Steelhouse

LUNCH SPOTS

Block 16
Hook & Lime
Dolomiti Pizzeria

HOTELS

Hilton Omaha
Cambria Hotel
The Cottonwood

FITNESS

Fly Fitness
Orangetheory
DTO Crossfit

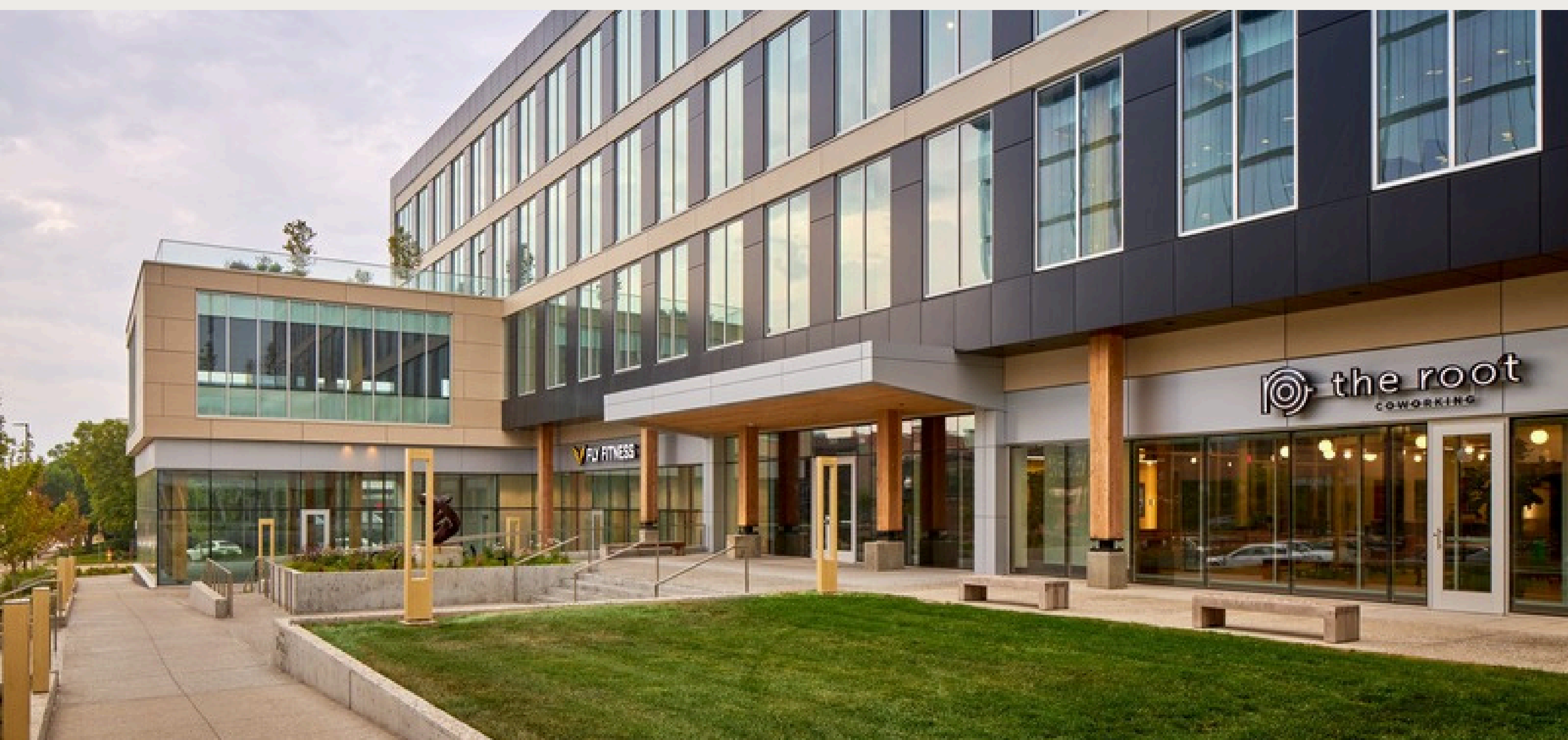



THE ROOT

BUILDERS

OMAHA, NE

1501 Mike Fahey

Brandi Boykin

brandi@therootcoworking.com

Patrick Boyhan

patrick@therootcoworking.com