

OFFICE BUILDING FOR LEASE

SWAN FINANCIAL – BAYLEN ANNEX

401 N BAYLEN ST
PENSACOLA, FL

stirling





PROPERTY DESCRIPTION

The Swan Financial – Baylen Annex is a ±8,100 SF boutique office building in Downtown Pensacola currently undergoing a comprehensive renovation with significant capital investment. Delivery is anticipated in Q2 2026. The redesigned layout features a combination of private offices, conference rooms, and a large flexible collaboration area with retractable walls, allowing the space to adapt to meetings, training, and group functions.

The building offers ample on-site parking and convenient client access, along with a walkable downtown location adjacent to the Swan Financial Tower. Its central positioning provides efficient access to Pensacola's CBD, I-110, and Gulf Breeze.

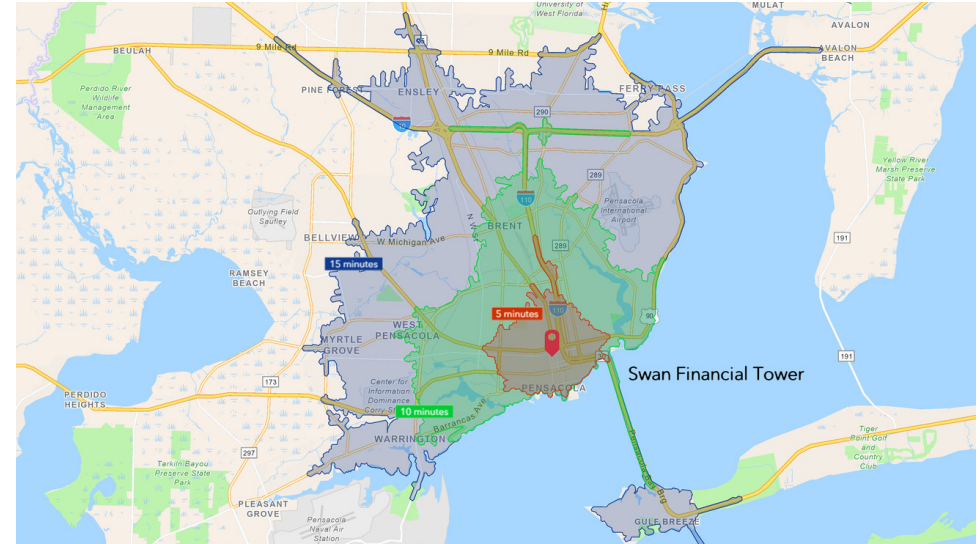

PROPERTY HIGHLIGHTS

- ±8,100 SF boutique office, potentially demisable (subject to layout and lease terms)
- Major renovation underway, delivery anticipated Q2 2026
- Private offices, conference rooms, and flexible collaboration space
- Ample on-site parking with easy client access
- Downtown Pensacola location adjacent to the Swan Financial Tower

OFFERING SUMMARY

Lease Rate:	\$26.00 SF/yr (Gross)
Available SF:	8,132 SF
Lot Size:	2.3 Acres

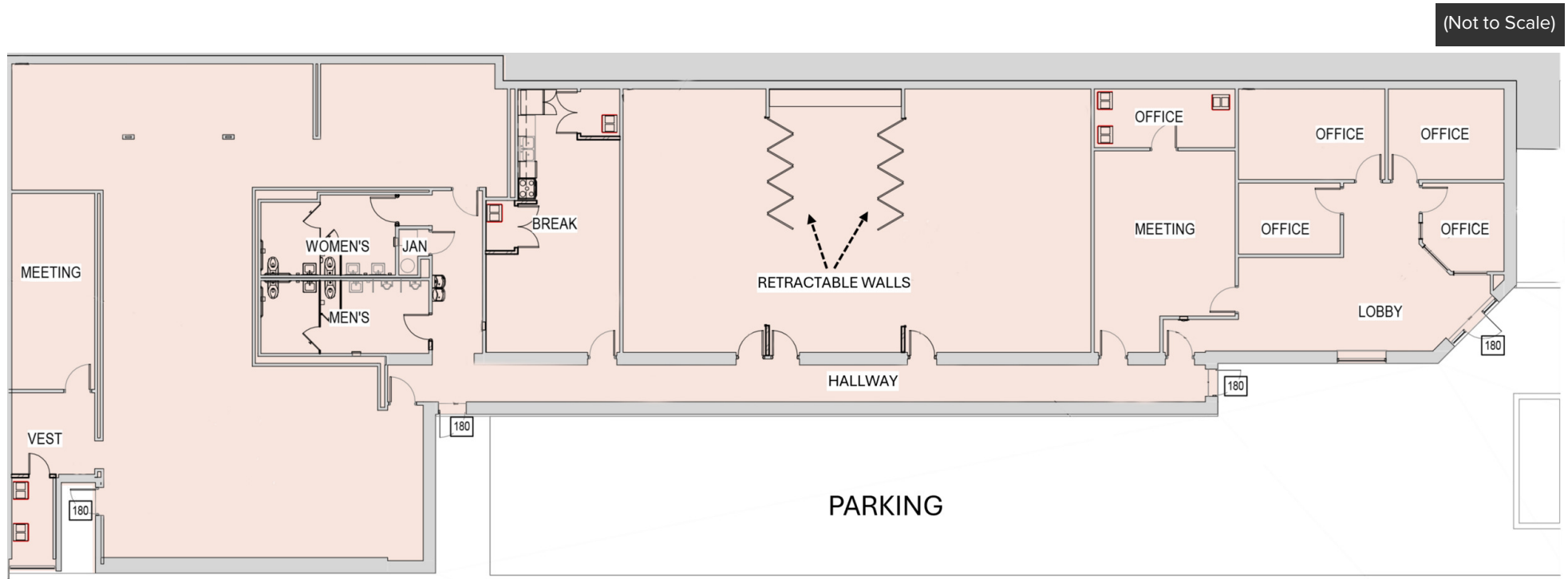

AVAILABLE SPACES

SIZE (SF)	LEASE TYPE	LEASE RATE	DESCRIPTION
8,132 SF	Gross	\$26.00 SF/yr	Tenant Responsible for Janitorial & Power



Why This Location Works For Retiree-Focused Professional Firms:

- Adjacent to Swan Financial Tower, serving an established retiree client base
- Easy access from Downtown Pensacola and Gulf Breeze without a high-rise feel
- Ample on-site parking and simple client arrival for older clientele
- Quiet, professional setting well suited for advisory, legal, and administrative uses

KYLLE SHOEMAKER

Licensed in FL

850.972.0161

kshoemaker@stirlingprop.com

STIRLINGPROPERTIES.COM / f t i in

Member of /4
RETAIL BROKERS NETWORK

The foregoing is solely for information purposes and is subject to change without notice. Stirling Properties makes no representations or warranties regarding the properties or information herein including but not Member of limited to any and all images pertaining to these properties. It is the obligation of each purchaser/lessee to investigate the condition and attributes of the properties and to verify the accuracy of the foregoing information to the extent such purchaser/lessee deems necessary. Also subject to errors, omissions, changes in terms and conditions, prior sale, lease or withdrawal, without notice.

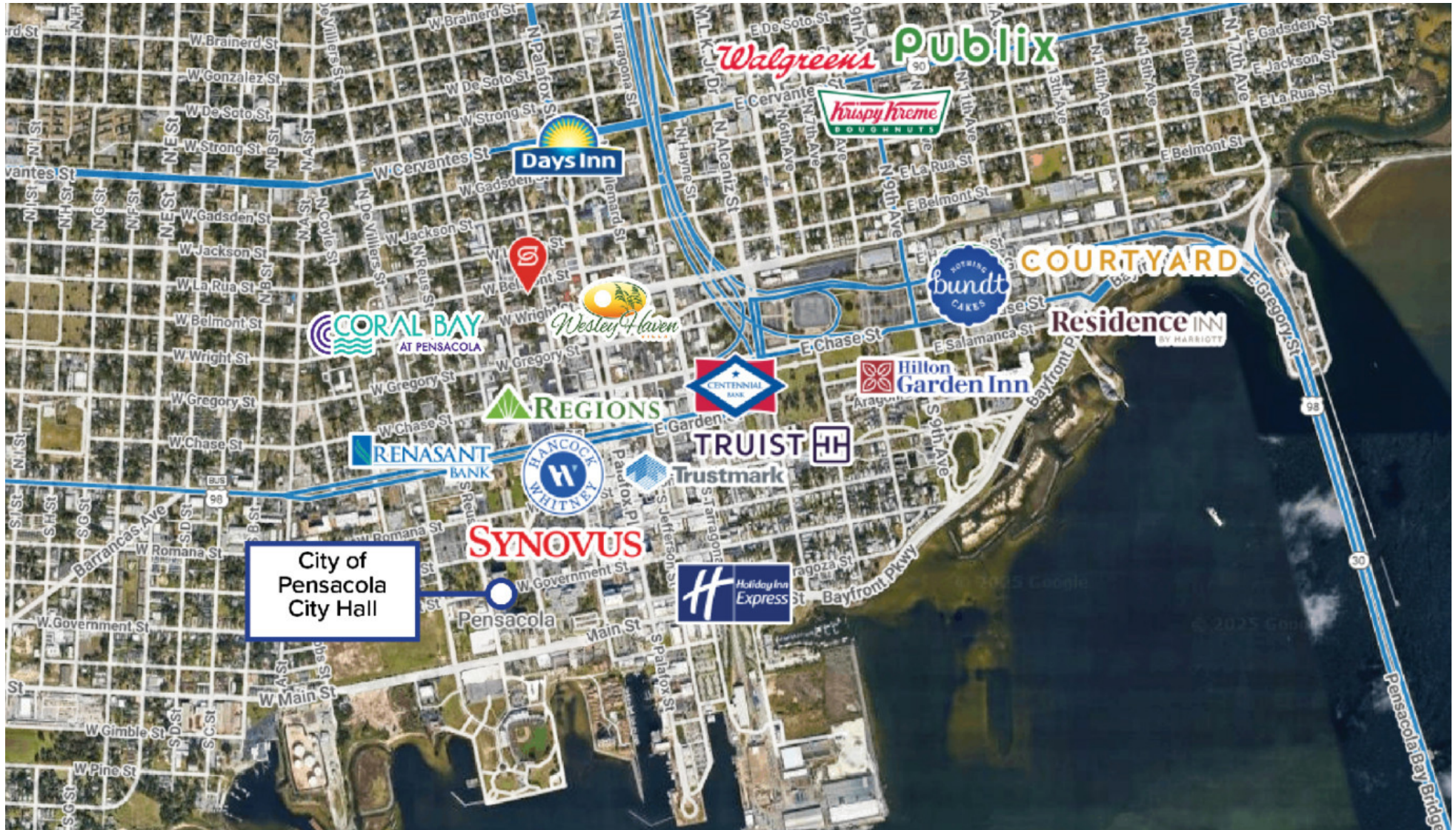

KYLLE SHOEMAKER

Licensed in FL

850.972.0161

kshoemaker@stirlingprop.com

STIRLINGPROPERTIES.COM / f t i in

Member of /5
RETAIL BROKERS NETWORK

The foregoing is solely for information purposes and is subject to change without notice. Stirling Properties makes no representations or warranties regarding the properties or information herein including but not limited to any and all images pertaining to these properties. It is the obligation of each purchaser/lessee to investigate the condition and attributes of the properties and to verify the accuracy of the foregoing information to the extent such purchaser/lessee deems necessary. Also subject to errors, omissions, changes in terms and conditions, prior sale, lease or withdrawal, without notice.