



SINGLE PROFESSIONAL OFFICE SUITES FOR LEASE IN WEST CHESTER



1234 WEST CHESTER PIKE | WEST CHESTER, PA



PILLAR REAL ESTATE ADVISORS

P: 484-887-8202 | www.PillarRealEstateAdvisors.com

535 N. Church Street, West Chester, PA 19380

PROPERTY HIGHLIGHTS

- Singles offices for sublet
- Large Windows
- Onsite Parking
- Access to shared Conference Rooms and Kitchenette
- Month to Month Leases Welcome

LEASE RATE:
\$850/MONTH FULL SERVICE



1234 WEST CHESTER PIKE | WEST CHESTER, PA



PILLAR REAL ESTATE ADVISORS

P: 484-887-8202 | www.PillarRealEstateAdvisors.com

535 N. Church Street, West Chester, PA 19380

SINGLE PROFESSIONAL OFFICE SUITES FOR LEASE IN WEST CHESTER

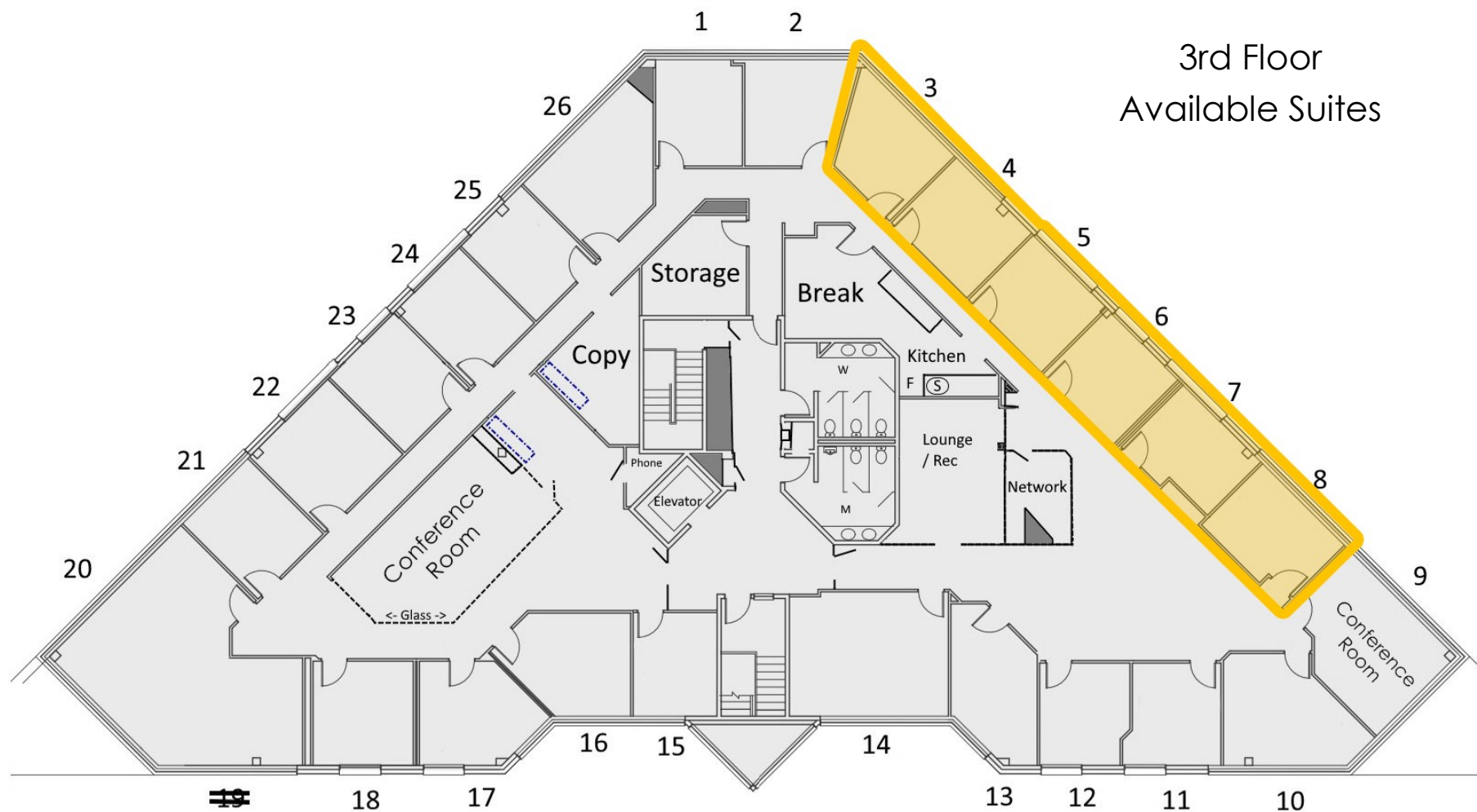

1234 WEST CHESTER PIKE | WEST CHESTER, PA



PILLAR REAL ESTATE ADVISORS

P: 484-887-8202 | www.PillarRealEstateAdvisors.com

535 N. Church Street, West Chester, PA 19380



SINGLE PROFESSIONAL OFFICE SUITES FOR LEASE IN WEST CHESTER

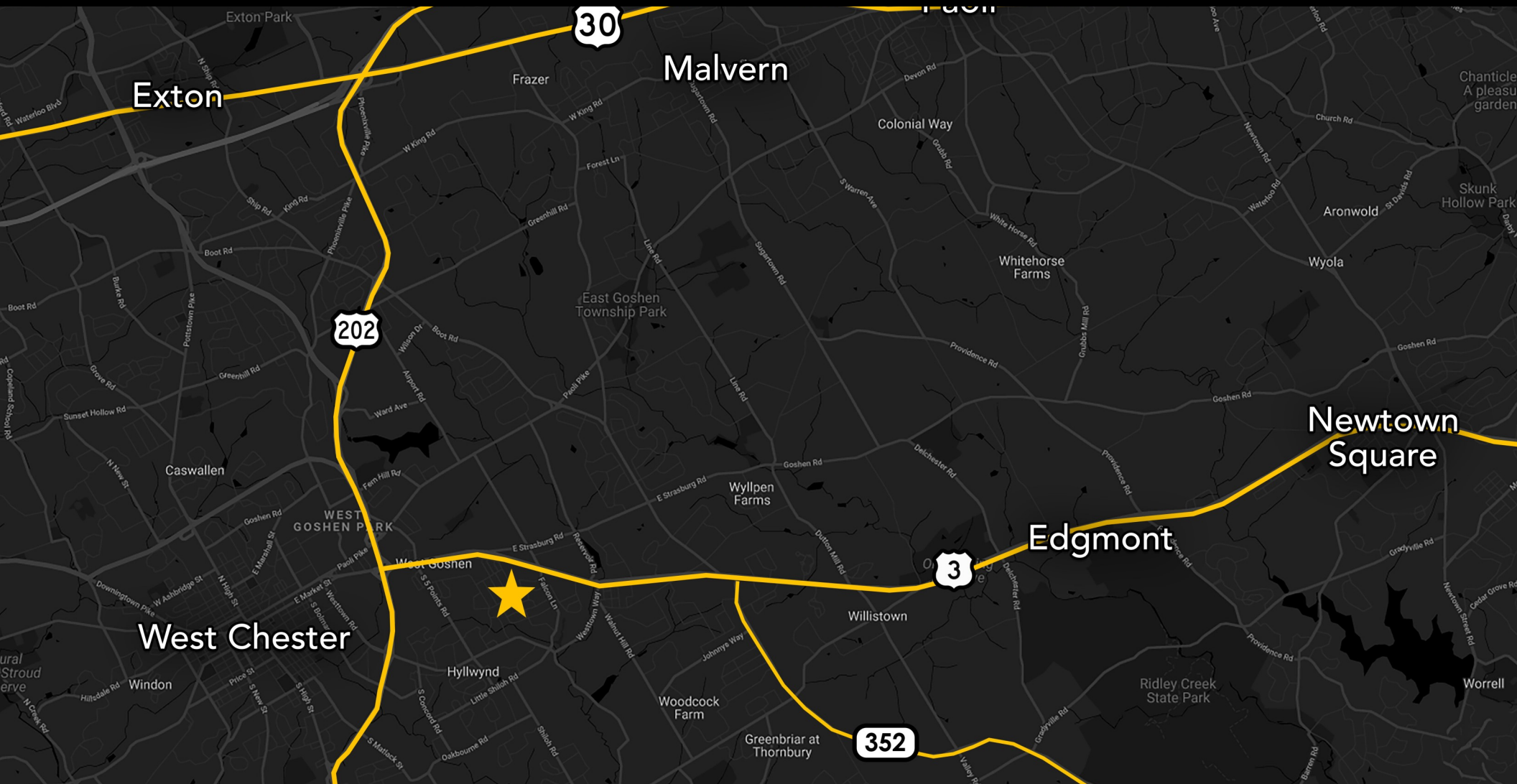

1234 WEST CHESTER PIKE | WEST CHESTER, PA



PILLAR REAL ESTATE ADVISORS

P: 484-887-8202 | www.PillarRealEstateAdvisors.com

535 N. Church Street, West Chester, PA 19380



SINGLE PROFESSIONAL OFFICE SUITES FOR LEASE IN WEST CHESTER

PILLAR REAL ESTATE ADVISORS

BRINGING EXPERIENCE, PROFESSIONALISM, AND INTEGRITY
TO COMMERCIAL REAL ESTATE BROKERAGE

ANDREW TURNER

ATURNER@PILLARREALESTATEADVISORS.COM

484-887-8202 | Ext. 102

RYAN DODDS

RDODDS@PILLARREALESTATEADVISORS.COM

484-887-8202 | Ext. 104

"The information contained in this document has been obtained from sources believed reliable. While Pillar Real Estate Advisors, LLC does not doubt its accuracy, Pillar Real Estate Advisors, LLC. has not verified it and makes no guarantee, warranty or representation about it. It is your responsibility to independently confirm its accuracy and completeness. Any projections, opinions, assumptions or estimates used are for example only and do not represent the current or future performance of the property. The value of this transaction to you depends on several factors which should be evaluated by your tax, financial and legal advisors to determine to your satisfaction the suitability of the property for your needs.

Photos herein are the property of their respective owners and use of these images without the express written consent of the owner is prohibited."

1234 WEST CHESTER PIKE | WEST CHESTER, PA



PILLAR REAL ESTATE ADVISORS

P: 484-887-8202 | www.PillarRealEstateAdvisors.com

535 N. Church Street, West Chester, PA 19380