

Mill Place Park

Colliers

Industrial for Lease

305 S 850 E Millpond Rd
Lehi | UT 84043



Jarrod Hunt
Vice Chair
+1 801 787 8940
jarrod.hunt@colliers.com

Lana Howell
Senior Associate
+1 801 453 6857
lana.howell@colliers.com

Andy Blunt
Vice President
+1 801 870 9648
andy.blunt@colliers.com



Property Overview

- Lease Rate: \$1.25 NNN
- 10,753 total SF available
- Includes office build-out
- HVAC in Warehouse
- 24' clear height
- 2 14' X 14' Grade Level doors
- Easy acces to freeway
- 3 phase power
- 2 Ground Level Doors

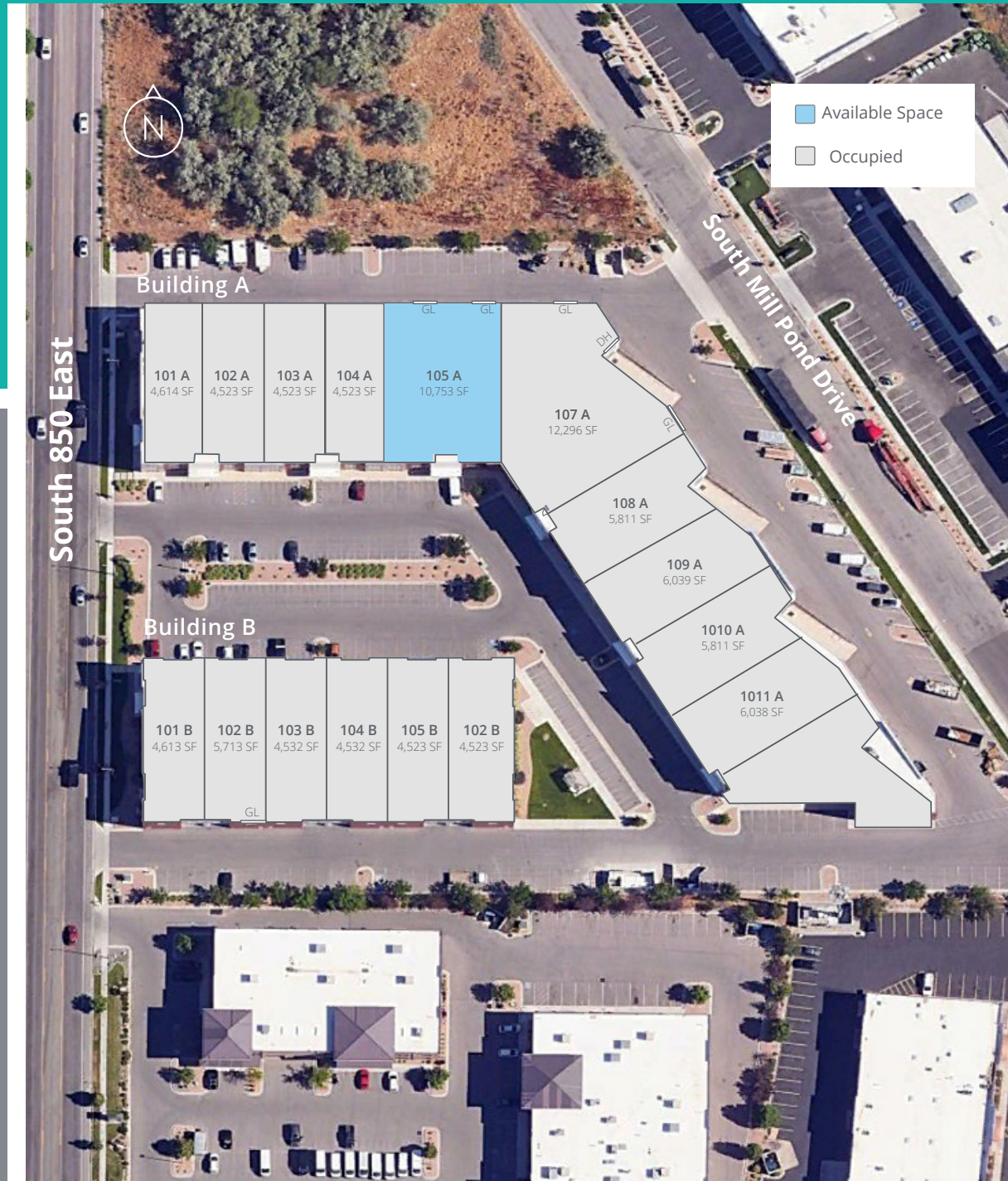

Floor Plans

Lehi Demographics

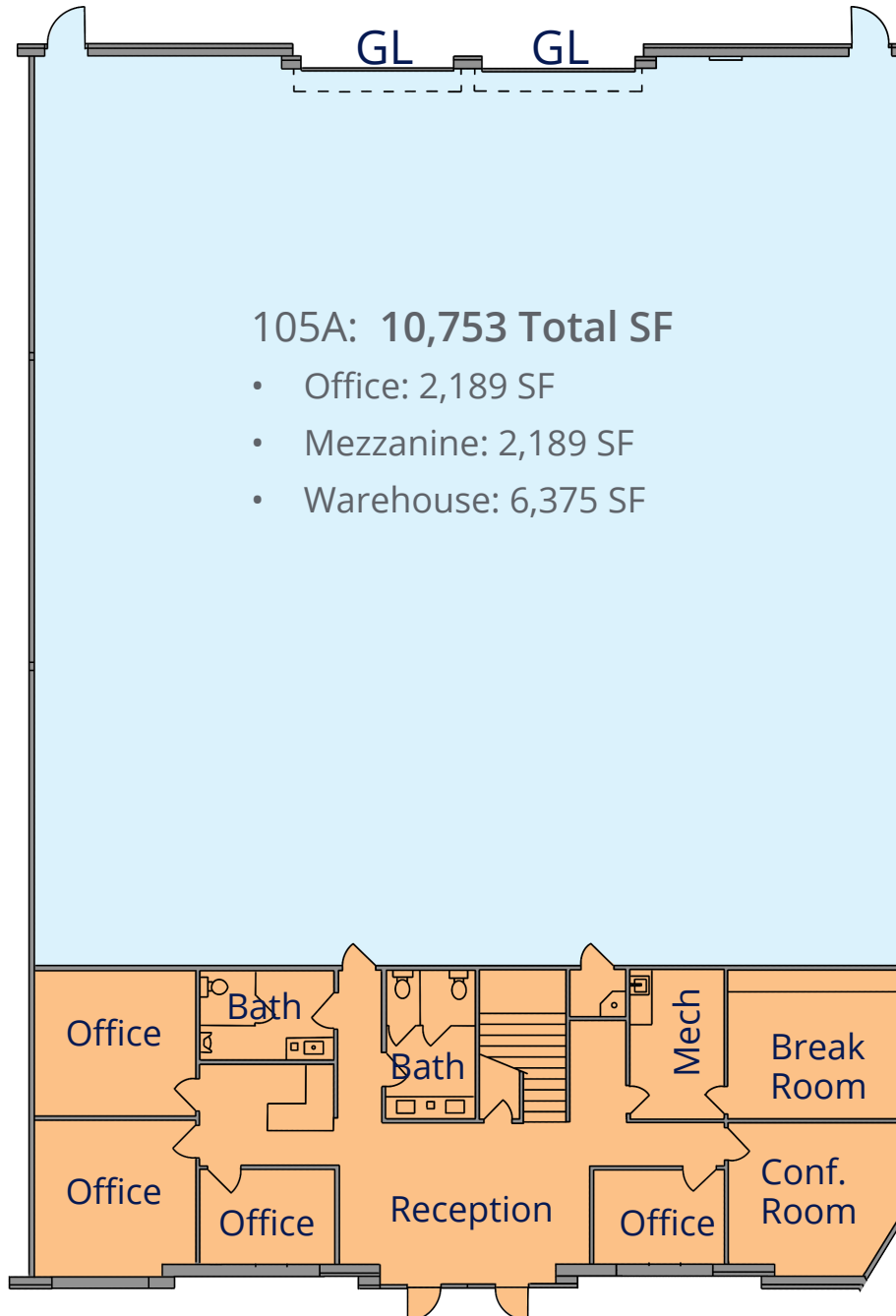

Key Facts

Population

82,735

Avg. Household Size

3.68

Median Age

27.0

Daytime Population

88,386

Education

No High School Diploma

2%

Some College

73%

High School Graduate

98%

College Degree

49%

Employment

White Collar

75%

Services

10%

Blue Collar

15%

Unemployment

1.2%

Business

Total Employees

32,950

Income

Median Household Income

\$106,735

Total Businesses

1,662

Median Net Worth

\$279,019

