

FOR LEASE

5,136 SF INDUSTRIAL UNIT



987 Jersey Avenue New Brunswick, NJ



FOR ADDITIONAL INFORMATION, PLEASE CONTACT:

Kenneth D. Lundberg, SIOR
Senior Vice President
201 488 5800 x138
klundberg@naihanson.com

Patrick Lennon
Vice President
201 488 5800 x109
plennon@naihanson.com

Lorenzo Lambiase, MBA
Associate Vice President
201 488 5800 x176
llambiase@naihanson.com

A PROJECT BY:

BRISTOL GROUP

NAI James E. Hanson
COMMERCIAL REAL ESTATE SERVICES, WORLDWIDE

FOLLOW US!      | NJ Offices: Teterboro | Parsippany | naihanson.com | Member of NAI Global with 300 Offices Worldwide

SERVICES OFFERED

Brokerage • Property Management • Corporate Services • Financing • Logistics • Government Services • Healthcare • Tenant Representation • Cold Storage • Investment Services

The information contained herein has been obtained from sources considered to be reliable, but no guarantee of its accuracy is made by NAI James E. Hanson

FOR LEASE

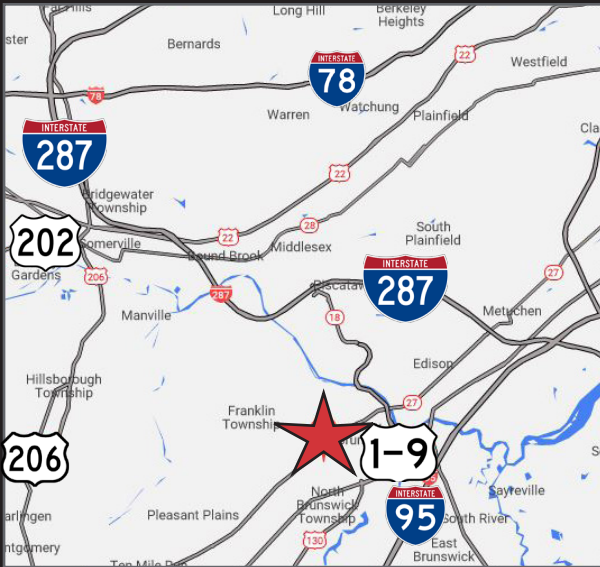
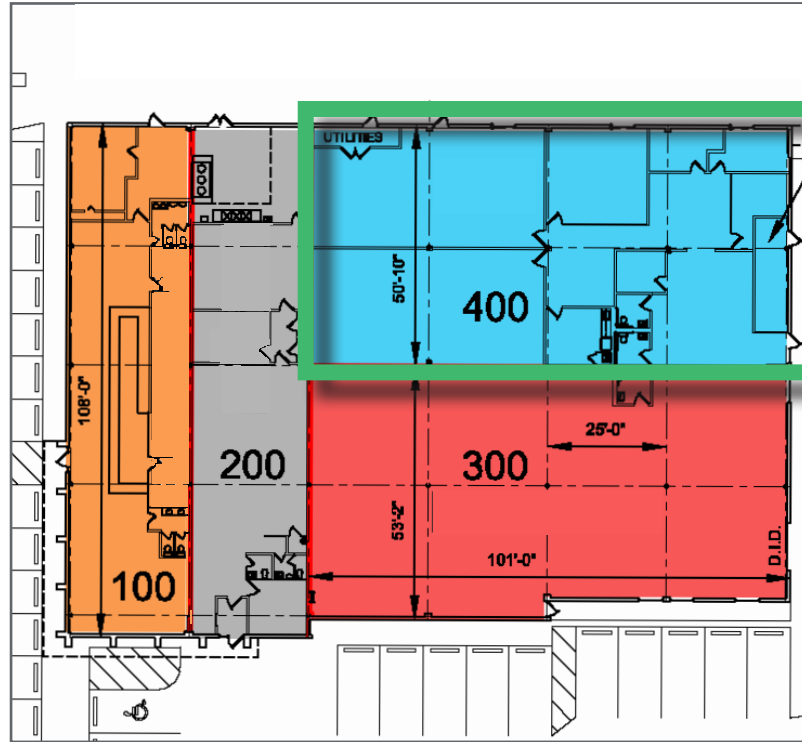

PROPERTY FEATURES

- Available: 5,136 SF
- Building Size: 16,250 SF
- Office Space: TBD
- One (1) Drive In
- Parking Spaces Available
- 14' Ceiling Height
- Fully Air Conditioned
- Sprinklers: Wet
- Easy Access to Routes 1, 18 and the NJ Turnpike

FOR ADDITIONAL INFORMATION, PLEASE CONTACT:

Kenneth D. Lundberg, SIOR
Senior Vice President
201 488 5800 x138
klundberg@naihanson.com

Patrick Lennon
Vice President
201 488 5800 x109
plennon@naihanson.com

Lorenzo Lambiase, MBA
Associate
201 488 5800 x176
llambiase@naihanson.com

A PROJECT BY:

BRISTOL GROUP

NAI James E. Hanson
COMMERCIAL REAL ESTATE SERVICES, WORLDWIDE