

3,357 sf

Unit 3192

1,546 sf

Unit 3168B (Storage)



## RETAIL SPACE FOR LEASE

### Dunmore Plaza

3158-3202 Dunmore Road SE, Medicine Hat

- » In the heart of Medicine Hat's commercial hub.
- » Great visibility from Dunmore Road.
- » Ample parking.

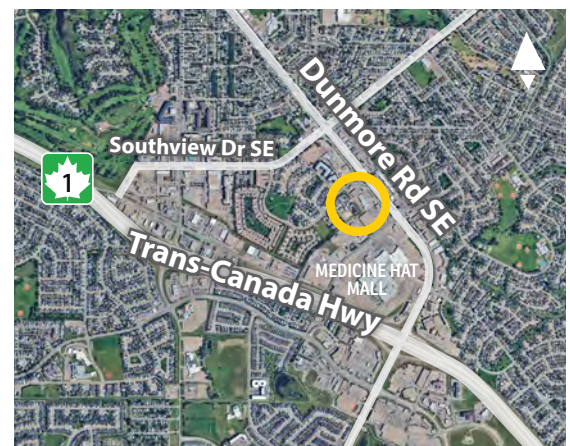

FOR MORE  
INFORMATION OR  
TO VIEW, PLEASE  
CONTACT:

**Andrew Sherbut**, VICE PRESIDENT, PARTNER

C: 403-607-1819

O: 403-290-0178

asherbut@barclaystreet.com



TCN  
WORLDWIDE  
REAL ESTATE SERVICES

LOCAL  
EXPERTISE  
MATTERS



## AREA DEMOGRAPHICS

(3 km radius)

Population **35,709** Median Age **41.7**

Average Household Income **\$101,240**

### Current Consumption / Household

FOOD **\$12,985** HEALTH CARE **\$5,737**

RECREATION **\$4,156** PERSONAL CARE **\$1,825**

LIQUOR/TOBACCO **\$3,600** CLOTHING **\$2,610**

Source: Statistics Canada

- » Well-established and well-maintained retail plaza next to Dollar Tree and Sport Chek.
- » Excellent location along major arterial, Dunmore Road, and benefits from great accessibility.
- » Its proximity to residential communities positions the property as a central hub for daily necessities, attracting a steady flow of foot traffic.

## LEASE INFORMATION

MUNICIPAL ADDRESS:  
3158-3202 Dunmore Road SE, Medicine Hat

ZONING: MU - Mixed Use

AVAILABLE FOR LEASE:

- 3,357 sq. ft. – Unit 3192
  - Available on 30-day notice
  - Showroom and warehouse
  - Loading dock
- 1,546 sq. ft. – Unit 3168B (Storage)
  - Available immediately

PARKING: 131 surface stalls

PYLON SIGNAGE: Available at market rate

OP. COSTS AND TAXES: \$12.75 psf (est., 2026)

NET RENT: Market

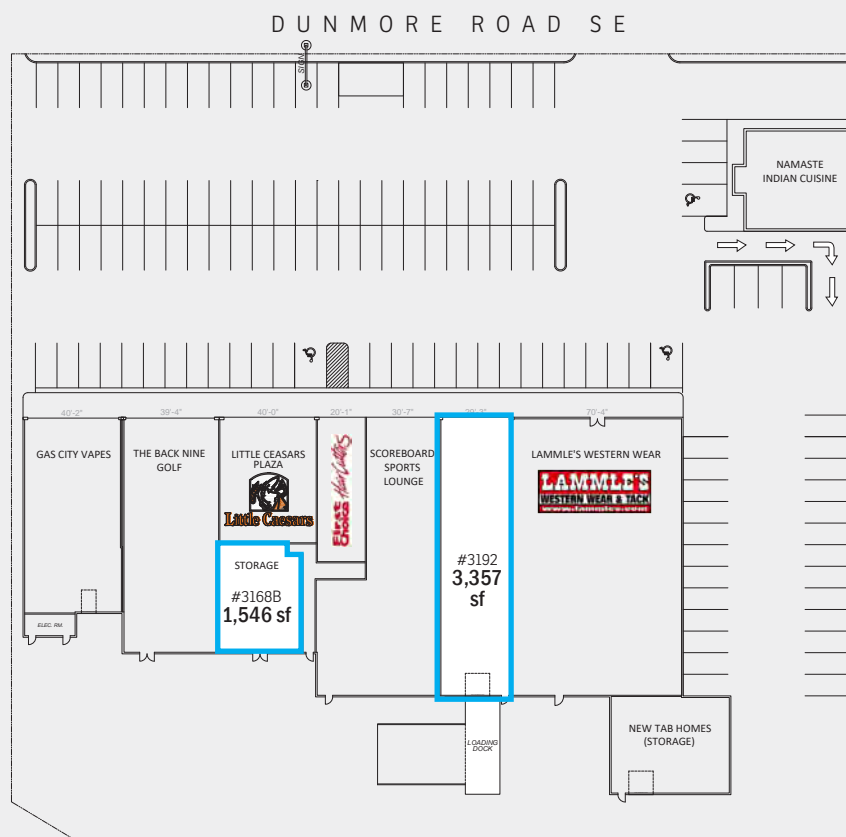

Prominent pylon signage and ample surface parking

UNIT 3192  
**3,357** SQ.FT.



3168B (STORAGE)  
**1,546** SQ.FT.



The information contained herein has been gathered from sources deemed reliable, but is not warranted as such and does not form any part of any future contract. This offering may be altered or withdrawn at any time without notice.

Copyright © 2026 Barclay Street Real Estate Ltd. All rights reserved.



LOCAL EXPERTISE MATTERS