

FOR
LEASE

4025 BOHANNON STREET

MENLO PARK, CALIFORNIA



CBRE

±15,105 SF FREESTANDING OFFICE/R&D BUILDING AVAILABLE NOW

FIRE LANE - NO PARKING

Property Highlights

- + ±15,105 SF
- + Power: 1,200 Amps
- + Freestanding Office/R&D/Lab building
- + LEED Silver Design and Construction
- + Class A Interiors throughout
- + LED Lighting with sensors
- + Wireless Hot Spots throughout
- + Card key security system in place
- + Fenced private parking lot with 44 parking spots
- + 5 EV Stations in Place
- + Free daily Marsh Road Shuttle to downtown Menlo Park Caltrain

Floor Plan



FLOOR PLAN NOT TO SCALE

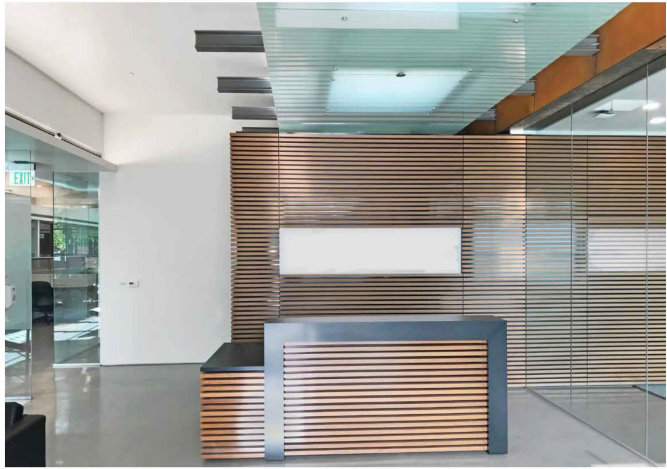

Parking & Transportation

- + Fenced private parking lot
- + 44 parking spots
- + 4 EV Stations in Place
- + Free daily Marsh Road Shuttle to downtown Menlo Park Caltrain

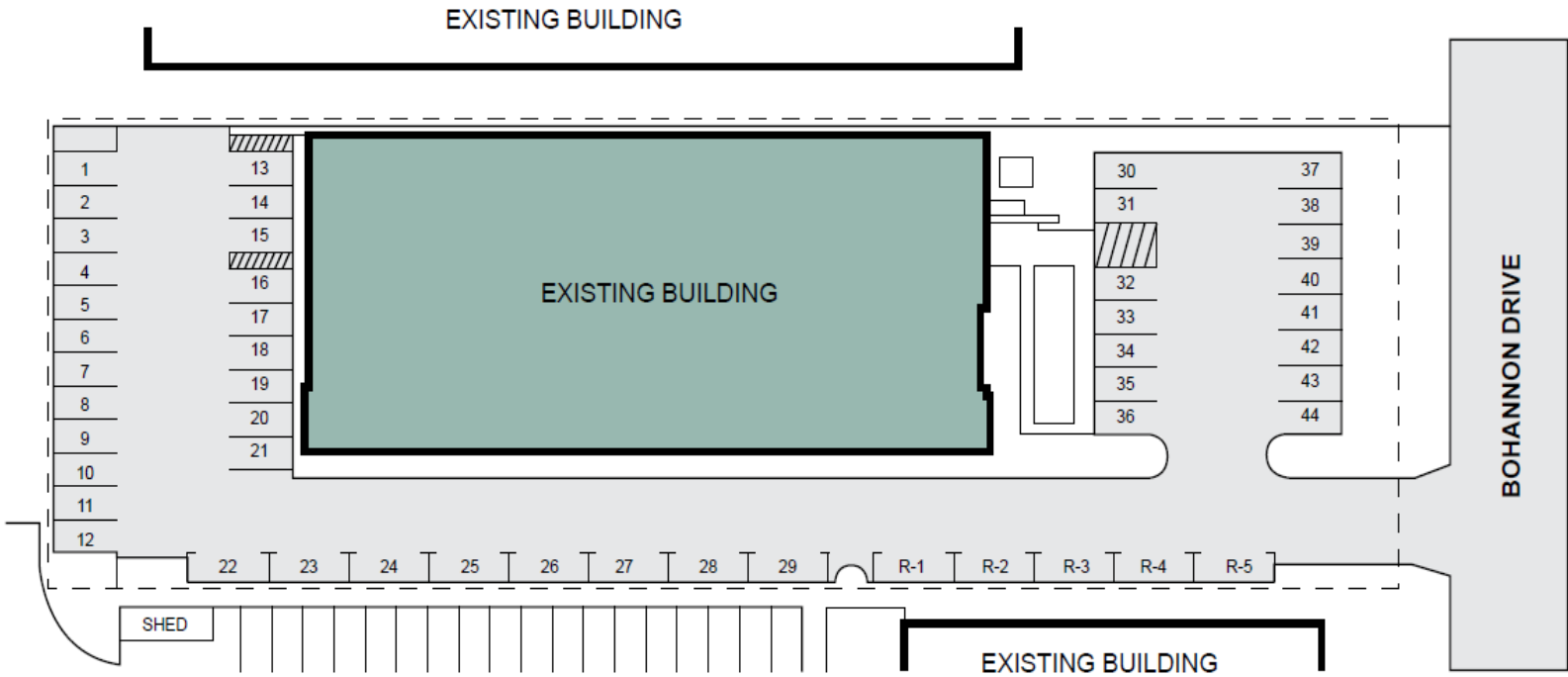



MARSH ROAD SHUTTLE

Menlo Park Caltrain to Marsh Road Business Parks

Effective April 1, 2019

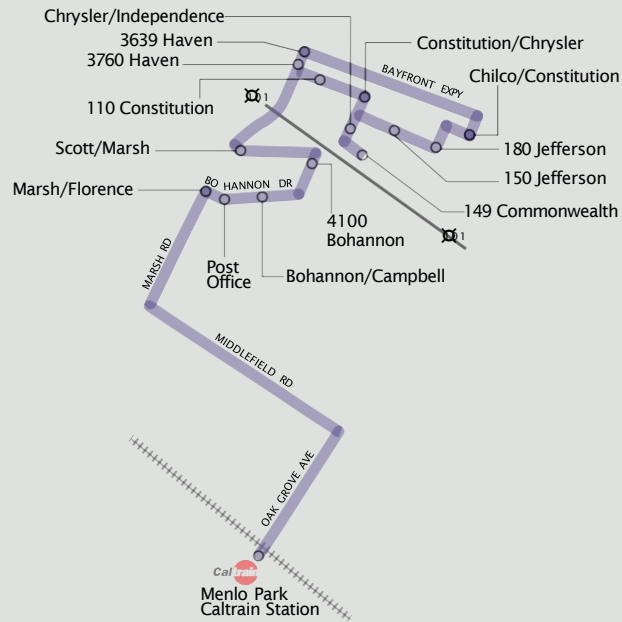

The M3-Marsh Road shuttle is FREE and open to everyone. Stanford Health Care's Bohannon Line also provides all day service to the Bohannon Drive area.

FOR MORE INFORMATION

Menlo Park Shuttles
650-330-6770
menlopark.org/shuttles

Caltrain
800-660-4287
caltrain.com

Regional Transit
Dial 5-1-1
511.org

Stanford Health Care
650-736-8000
bohshuttle.stanfordchildrens.org

Sign up for text alerts: smctd.com/shuttles/shuttle_text_alerts
Live Shuttle Tracker: peninsulashuttles.com

The M3-Marsh Road Shuttle is funded through generous grants from our partner agencies:



Morning Schedule

	RUN 1	RUN 2	RUN 3	RUN 4	RUN 5	RUN 6	RUN 7
Menlo Park Caltrain (Depart)	6:59	7:34	8:01	8:34	8:56	9:34	10:01
Post Office	7:06	7:41	8:08	8:41	9:03	9:41	10:08
Bohannon/Campbell	7:07	7:42	8:09	8:42	9:04	9:42	10:09
4100 Bohannon	7:08	7:43	8:10	8:43	9:05	9:43	10:10
Scott/Marsh	7:10	7:45	8:12	8:45	9:07	9:45	10:12
110 Constitution ^{Note 1}	--	--	--	--	--	--	--
Constitution/Chrysler ^{Note 2}	7:16	7:51	8:18	8:51	9:13	9:51	10:18
Chrysler/Independence	7:17	7:52	8:19	8:52	9:14	9:52	10:19
149 Commonwealth	7:18	7:53	8:20	8:53	9:15	9:53	10:20
150 Jefferson/180 Jefferson	7:20	7:55	8:22	8:55	9:17	9:55	10:22
Chilco/Constitution	7:22	7:57	8:24	8:57	9:19	9:57	10:24
3639 Haven (Anton Menlo)	7:28	8:03	8:30	9:03	9:25	10:03	10:30
3760 Haven (Quicken)	7:30	8:05	8:32	9:05	9:27	10:05	10:32
Marsh/Florence	7:35	8:10	8:37	9:10	9:32	10:10	10:37
Menlo Park Caltrain (Arrive)	7:44	8:19	8:46	9:19	9:41	--	--

Afternoon Schedule

	RUN 1	RUN 2	RUN 3	RUN 4	RUN 5	RUN 6
Menlo Park Caltrain (Depart)	--	--	3:44	4:12	5:16	5:27
110 Constitution ^{Note 1}	--	--	--	--	--	--
Constitution/Chrysler ^{Note 2}	--	--	--	--	--	--
Chrysler/Independence	3:10	3:38	4:42	4:53	5:42	5:53
149 Commonwealth	3:11	3:39	4:43	4:54	5:43	5:54
150 Jefferson/180 Jefferson	3:13	3:41	4:45	4:56	5:45	5:56
Chilco/Constitution	3:15	3:43	4:47	4:58	5:47	5:58
3639 Haven (Anton Menlo)	3:21	3:49	4:53	5:04	5:53	6:04
3760 Haven (Quicken)	3:23	3:51	4:55	5:06	5:55	6:06
Scott/Marsh	3:28	3:56	5:00	5:11	6:00	6:11
4100 Bohannon	3:30	3:58	5:02	5:13	6:02	6:13
Bohannon/Campbell	3:31	3:59	5:03	5:14	6:03	6:14
Post Office	3:32	4:00	5:04	5:15	6:04	6:15
Marsh/Florence	3:35	4:03	5:07	5:18	6:07	6:18
Menlo Park Caltrain (Arrive)	3:44	4:12	5:16	5:27	6:16	6:27

Caltrain Arrivals in Menlo Park

From San Francisco	From San Jose	Shuttle Connection
#206: 6:50	#207: 6:41 #211: 6:54	Run 1 Dep. 6:59
#310: 7:17 #212: 7:29	--	Run 2 Dep. 7:34
#216: 7:48	#217: 7:41 #221: 7:56	Run 3 Dep. 8:01
#320: 8:17 #222: 8:29	--	Run 4 Dep. 8:34
#226: 8:48	#227: 8:44 #231: 8:51	Run 5 Dep. 8:56
#330: 9:17 #232: 9:29	#233: 9:17	Run 6 Dep. 9:34
#134: 9:56	#135: 9:50	Run 7 Dep. 10:01

Shuttles will wait up to 5 minutes past scheduled departure times to meet late trains.

Caltrain Departures from Menlo Park

Shuttle Connection	To San Jose	To San Francisco
Run 1 Arr. 3:44	#156: 3:59	#159: 3:51
Run 2 Arr. 4:12	#258: 4:24	#261: 4:19
Run 3 Arr. 5:16	--	#269: 5:23
Run 4 Arr. 5:27	#264: 5:34 #268: 5:41	#375: 5:45
Run 5 Arr. 6:16	--	#279: 6:23
Run 6 Arr. 6:27	#274: 6:34 #278: 6:41	#385: 6:45

Note 1 Temporarily suspended due to construction/road closures.

Note 2 Dropoff in morning; for afternoon pickup use the stop at Chrysler/Independence.

FOR LEASE

4025

BOHANNON
STREET
MENLO PARK, CALIFORNIA

CONTACT US

DAMON SCHOR

Senior Vice President

+1 650 494 5121

damon.schor@cbre.com

Lic. 01317778

RYAN CARR

Vice President

+1 650 494 5115

ryan.carr@cbre.com

Lic. 01924765

CBRE

© 2026 CBRE, Inc. All rights reserved. This information has been obtained from sources believed reliable, but has not been verified for accuracy or completeness. You should conduct a careful, independent investigation of the property and verify all information. Any reliance on this information is solely at your own risk. CBRE and the CBRE logo are service marks of CBRE, Inc. All other marks displayed on this document are the property of their respective owners, and the use of such logos does not imply any affiliation with or endorsement of CBRE. Photos herein are the property of their respective owners. Use of these images without the express written consent of the owner is prohibited.