

For Sublease

Medical Office Space Lincoln, NE

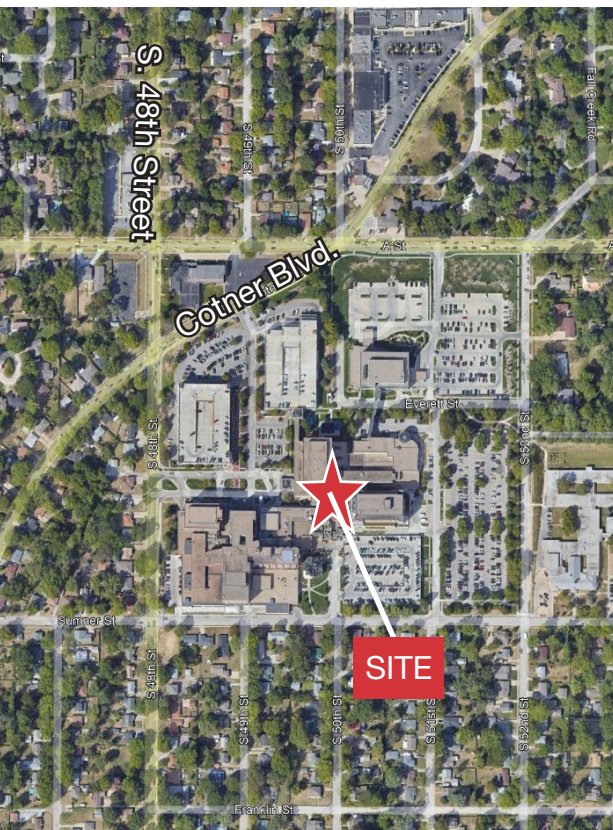

1500 S. 48th Street, Ste. 412

Lincoln, NE 68506

- \$23.00/SF MG
- 3,802 SF
- Class A medical office space for sublease on the Bryan Health campus
- The space includes exam rooms with sinks, nurse work stations, reception area, in-suite bathrooms, and private offices
- Available January 1, 2024

For more information, contact:

Mike Ball

402 441 5807 • mball@naifma.com

Richard Meginnis, SIOR

402 441 5828 • rmeginnis@naifma.com



Union Bank Place
1248 'O' Street, Suite 550
Lincoln, NE 68508
402 441 5800

naifmarealty.com

NO WARRANTY OR REPRESENTATION, EXPRESS OR IMPLIED, IS MADE AS TO THE ACCURACY OF THE INFORMATION CONTAINED HEREIN, AND THE SAME IS SUBMITTED SUBJECT TO ERRORS, OMISSIONS, CHANGE OF PRICE, RENTAL OR OTHER CONDITIONS, PRIOR SALE, LEASE OR FINANCING, OR WITHDRAWAL WITHOUT NOTICE, AND OF ANY SPECIAL LISTING CONDITIONS IMPOSED BY OUR PRINCIPALS NO WARRANTIES OR REPRESENTATIONS ARE MADE AS TO THE CONDITION OF THE PROPERTY OR ANY HAZARDS CONTAINED THEREIN ARE ANY TO BE IMPLIED.

For Sublease

1500 S. 48th St. Ste 412
Lincoln, NE 68506

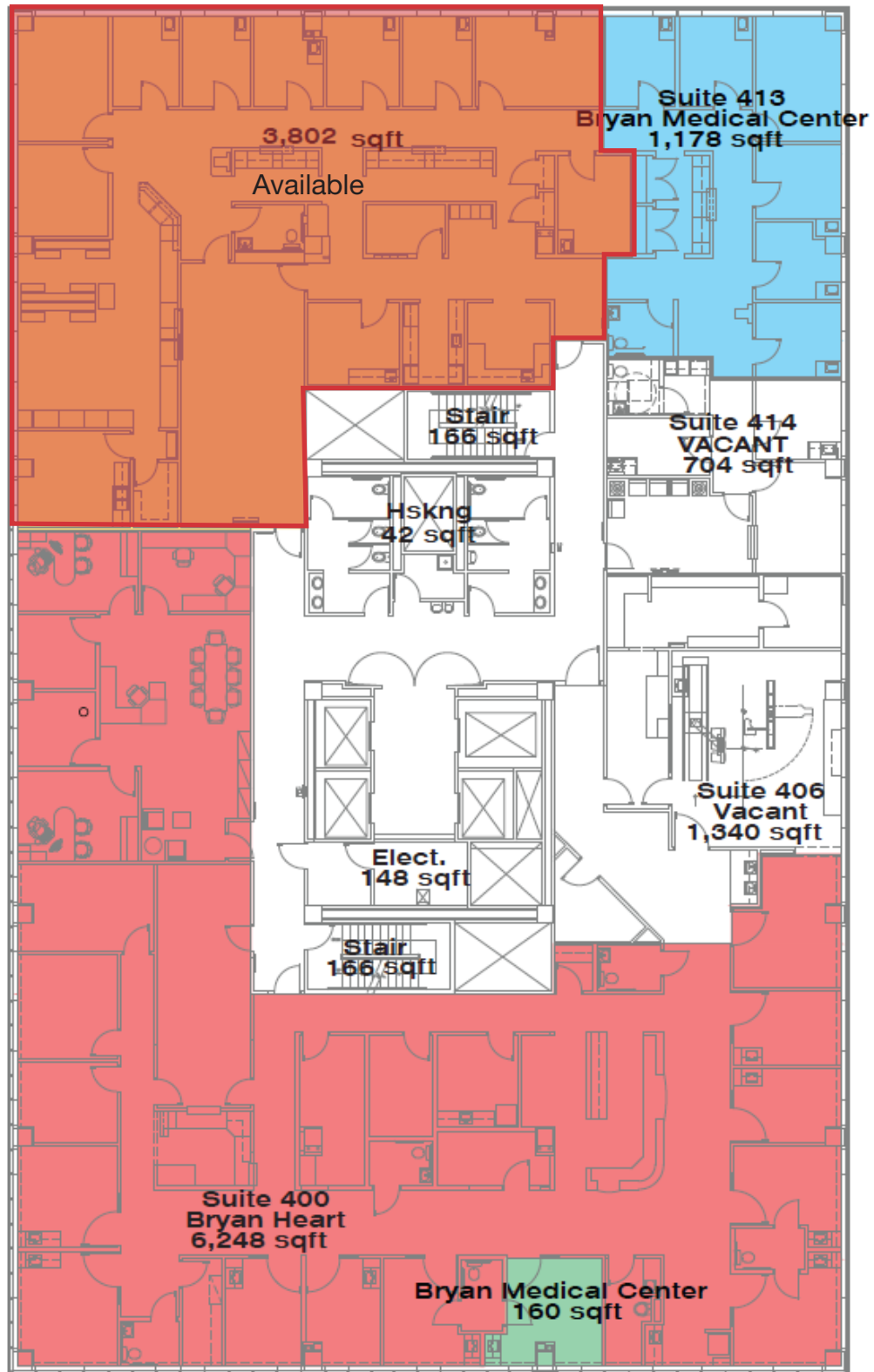

Union Bank Place
1248 'O' Street, Suite 550
Lincoln, NE 68508
402 441 5800
naifmarealty.com