

BAYSIDE REALTY PARTNERS PRESENTS

2680 Ocean Avenue San Francisco, California

Fully-equipped Dental Suite in Heart of Lakeside Village

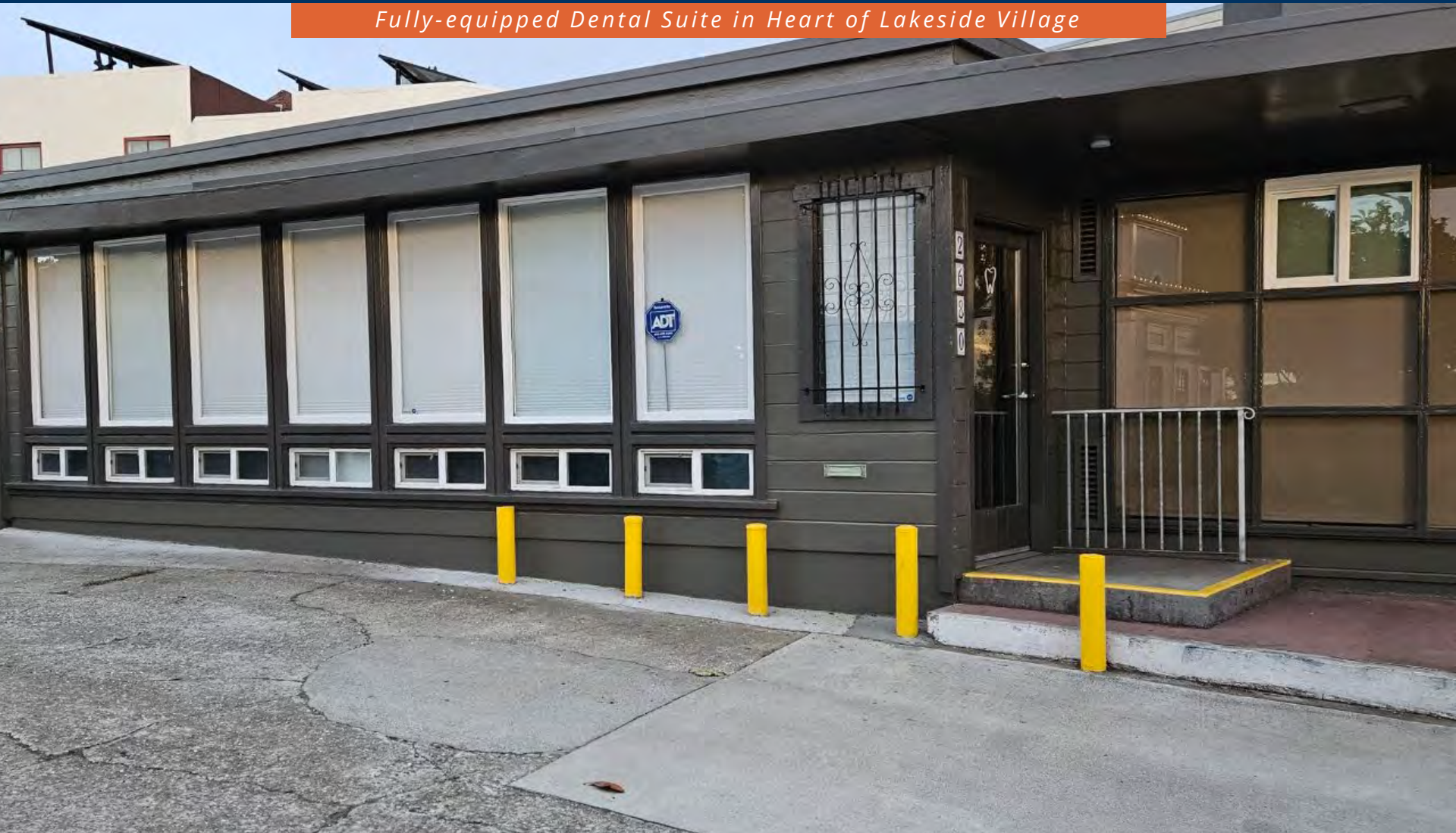

TRASK LEONARD
President and CEO
650.533.2591
tleonard@baysiderp.com
DRE#01152101



GRACE LINDBERG
Vice President
415.307.0252
glindberg@baysiderp.com
DRE#02230832

BAYSIDE
REALTY PARTNERS
MEDICAL/DENTAL PROPERTY SPECIALISTS

2680 Ocean Avenue San Francisco, California

LOCATION

- Located just east of 19th Avenue near Stonestown Galleria
- Close to Muni
- City parking lot across the street and plentiful street and neighborhood parking



BUILDING

- Approximately 1,026 rsf (area to be confirmed)
- Fully-equipped dental suite with reception area, 4 large operatories, restroom, lab, breakroom and spacious waiting area
- Equipment available includes chairs and compressor
- Move-in ready

2680 Ocean Avenue San Francisco, California

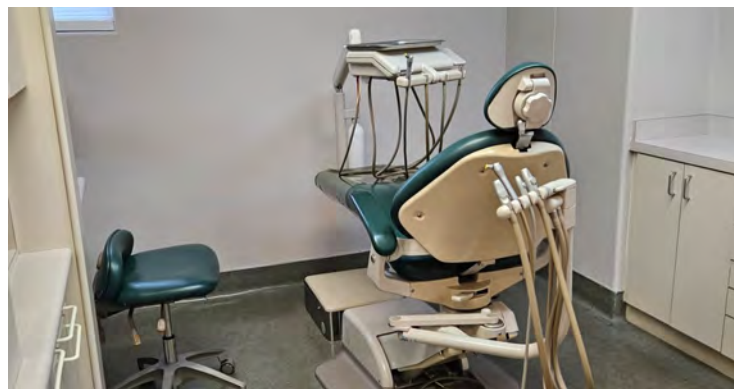
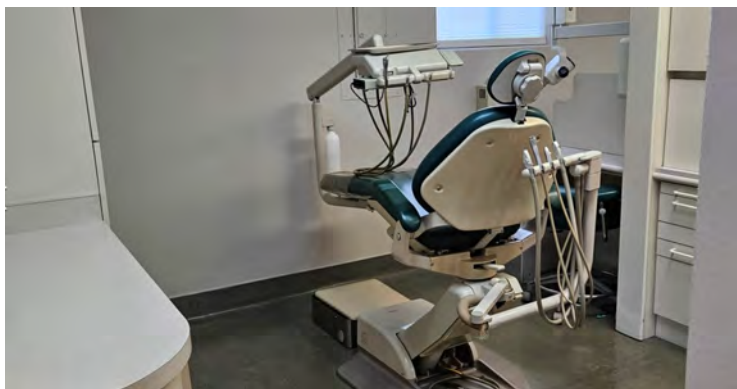

2680 Ocean Avenue San Francisco, California

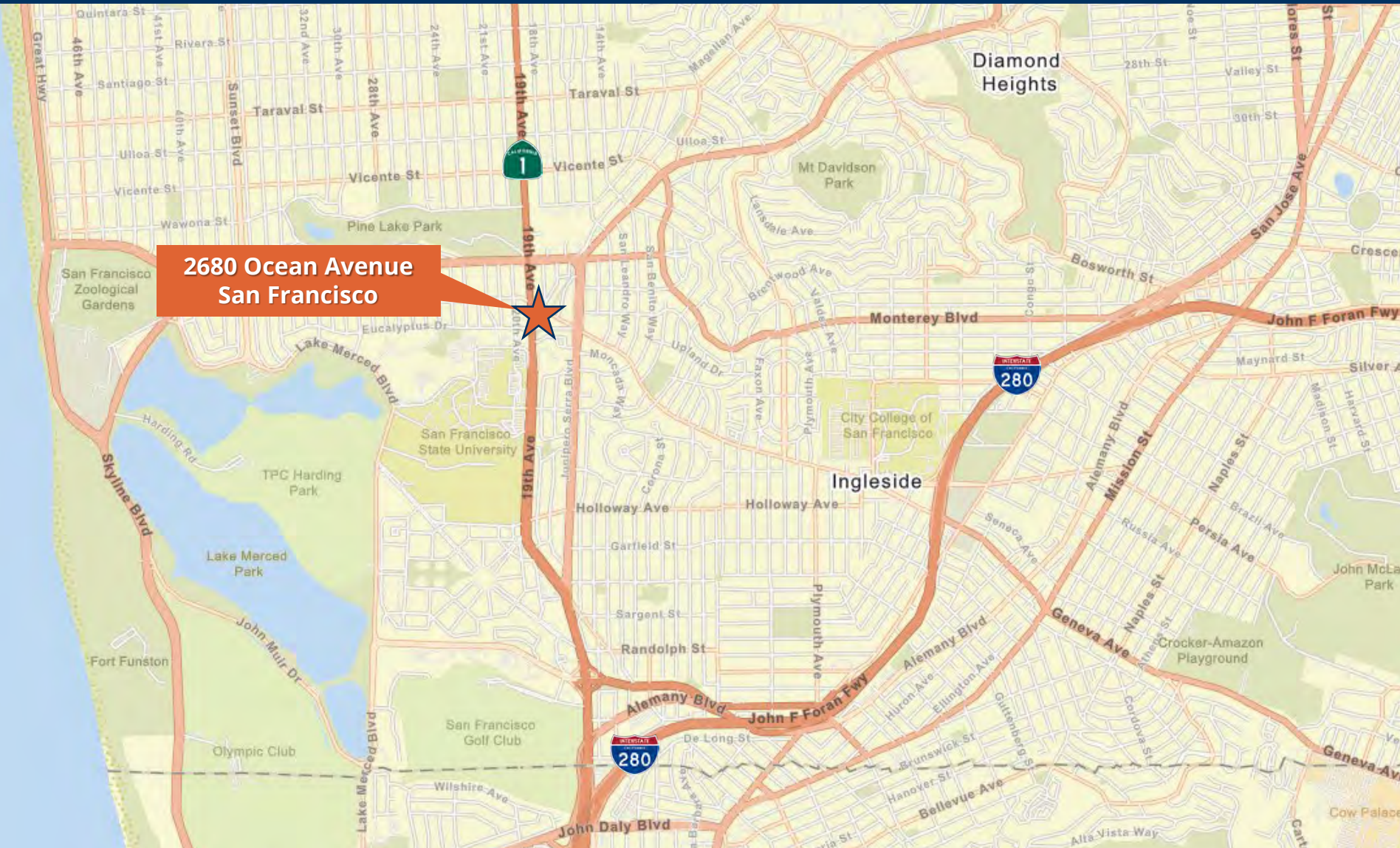

**2680 Ocean Avenue
San Francisco**

2680 Ocean Avenue San Francisco, California

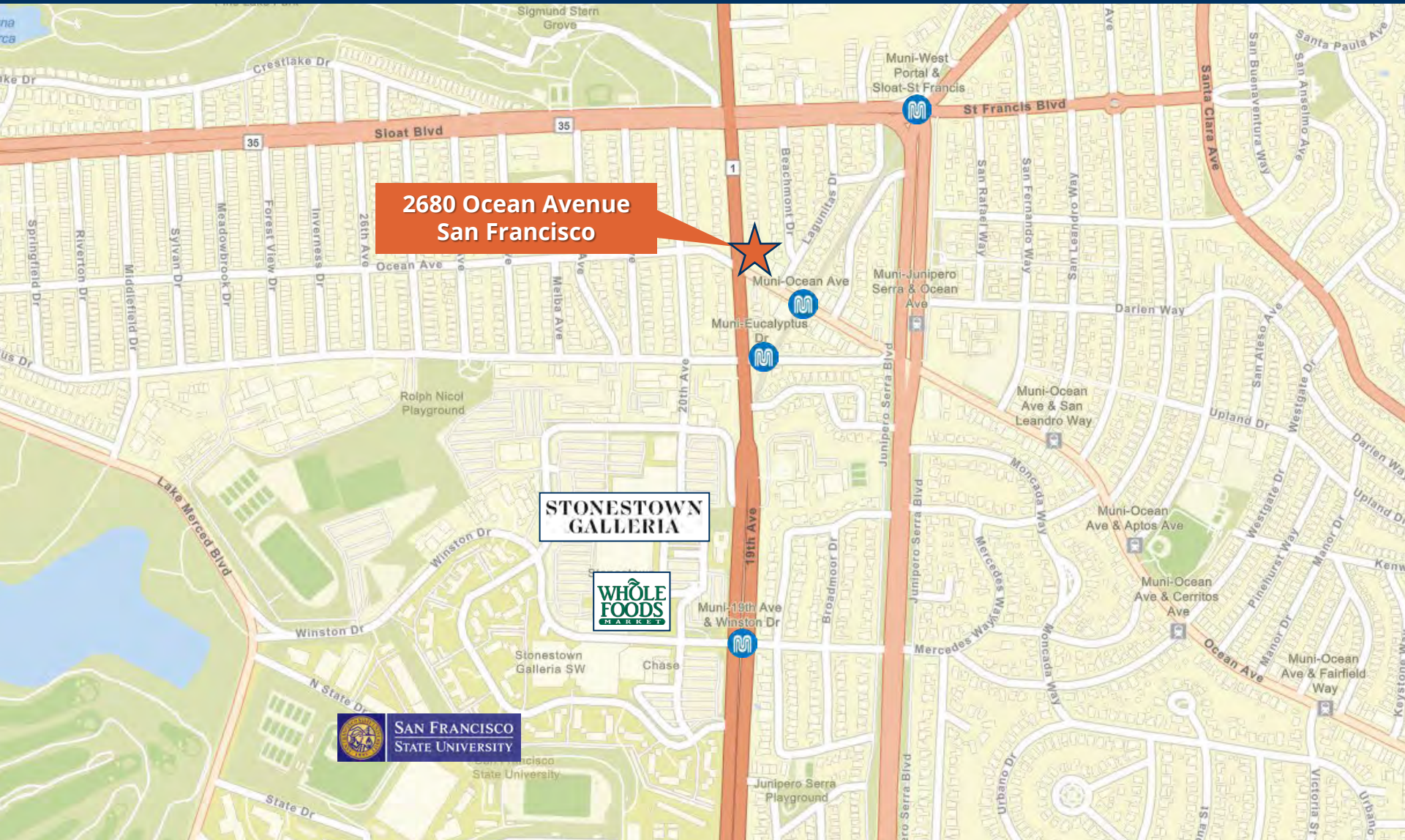

2680 Ocean Avenue

San Francisco, California

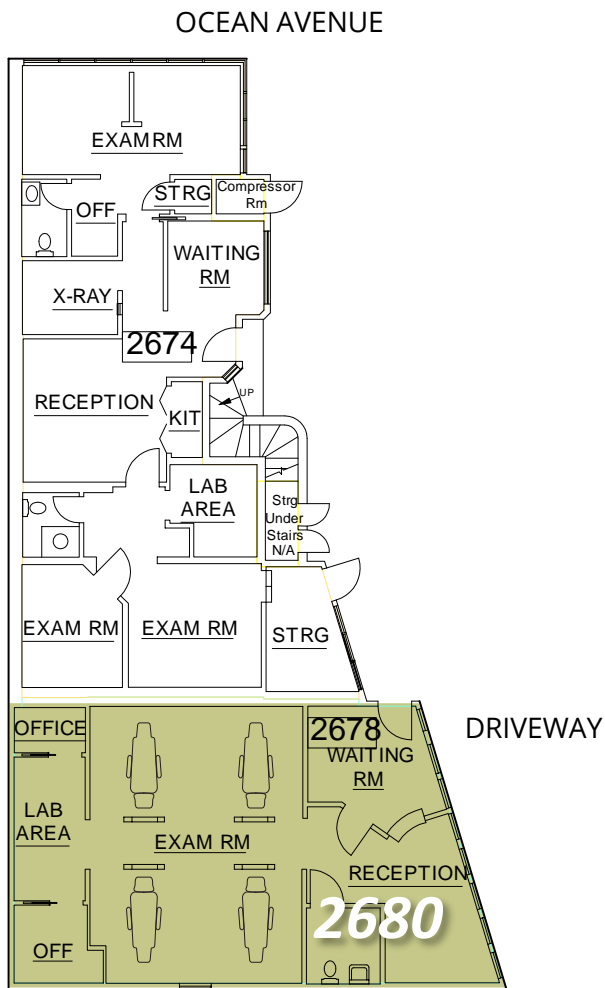

Suite 2680

1,026 RSF

- Fully-equipped dental suite with reception area, 4 large operatories, restroom, lab, breakroom and spacious waiting area
- Equipment available includes chairs and compressor
- Move-in ready

Meet Your Expert Team



TRASK LEONARD

President and CEO

650.533.2591

tleonard@baysiderp.com

DRE#01152101



GRACE LINDBERG

Vice President

415.307.0252

glindberg@baysiderp.com

DRE#02230832

BAYSIDE REALTY PARTNERS

The preeminent provider of management, leasing, construction management and accounting services for healthcare properties.



MARKET LEADER

- Leasing & Property Management
- Investment Sales
- Tenant Representation
- Construction Management
- Property Repositioning



INFLUENTIAL NETWORK

- Institutional Investors
- Healthcare Systems and Healthcare Districts
- Physicians & Districts
- Private Investors



DOMINANT FOOTPRINT

- 2 million SF leased & managed
 - 50+ MOB portfolio
 - 10,000-240,000 SF
 - 500,000 SF portfolio
- San Francisco's largest MOBs
- 950+ leases executed
- 500+ medical and dental tenants

DOMINANT. EXPERT. INFLUENTIAL.