

LEASE

**24' CLEAR INDUSTRIAL FACILITY W/
LARGE SECURED PARKING LOT
IDEAL FOR MANUFACTURING & DISTRIBUTION**

MAJOR PROPERTIES
REAL ESTATE
Commercial • Industrial

**663
E 22ND
STREET**

**≈25,500 SF
\$0.80/SF MODIFIED GROSS
INDUSTRIAL BUILDING**

PROPERTY HIGHLIGHTS

A Well-Located Infill Industrial Asset
Offering Scale, Power, and Flexibility



Manufacturing
or Distribution
uses allowed

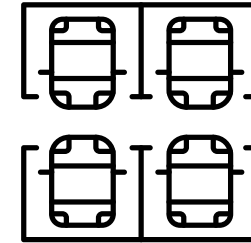

On-Site Parking &
Secured Lot



Drive-In
Loading Door

SUBJECT PROPERTY

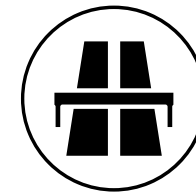

Excellent Freeway
& Transit Access



High
Ceiling



Prime
Location

PROPERTY DETAILS

Price / SF	\$20,400 per month or \$0.80/SF MG
Available Space	±25,500 SF Industrial
Clear Height	24'
Sprinklers	Yes
Drive-In Doors	2 total (10' W x 12' H)
Power	400A / 277-480V, 3-Phase, 4-Wire
Covered Parking	±70 Spaces
Frontage	San Pedro St & E 22 nd St
Year Built	1969
Zoning	LAM1
APNs	5127-005-014

***Buyer to verify all information**

An aerial photograph of a city block. A large industrial building with a red roof is outlined in black. A red line points from a red dot on the roof to a red label. Below the building is a large, rectangular area of green grass, also outlined in black. A red line points from a red dot on the grass to a red label. The surrounding area is filled with residential houses, streets, and parked cars.

INDUSTRIAL BLDG.

PARKING

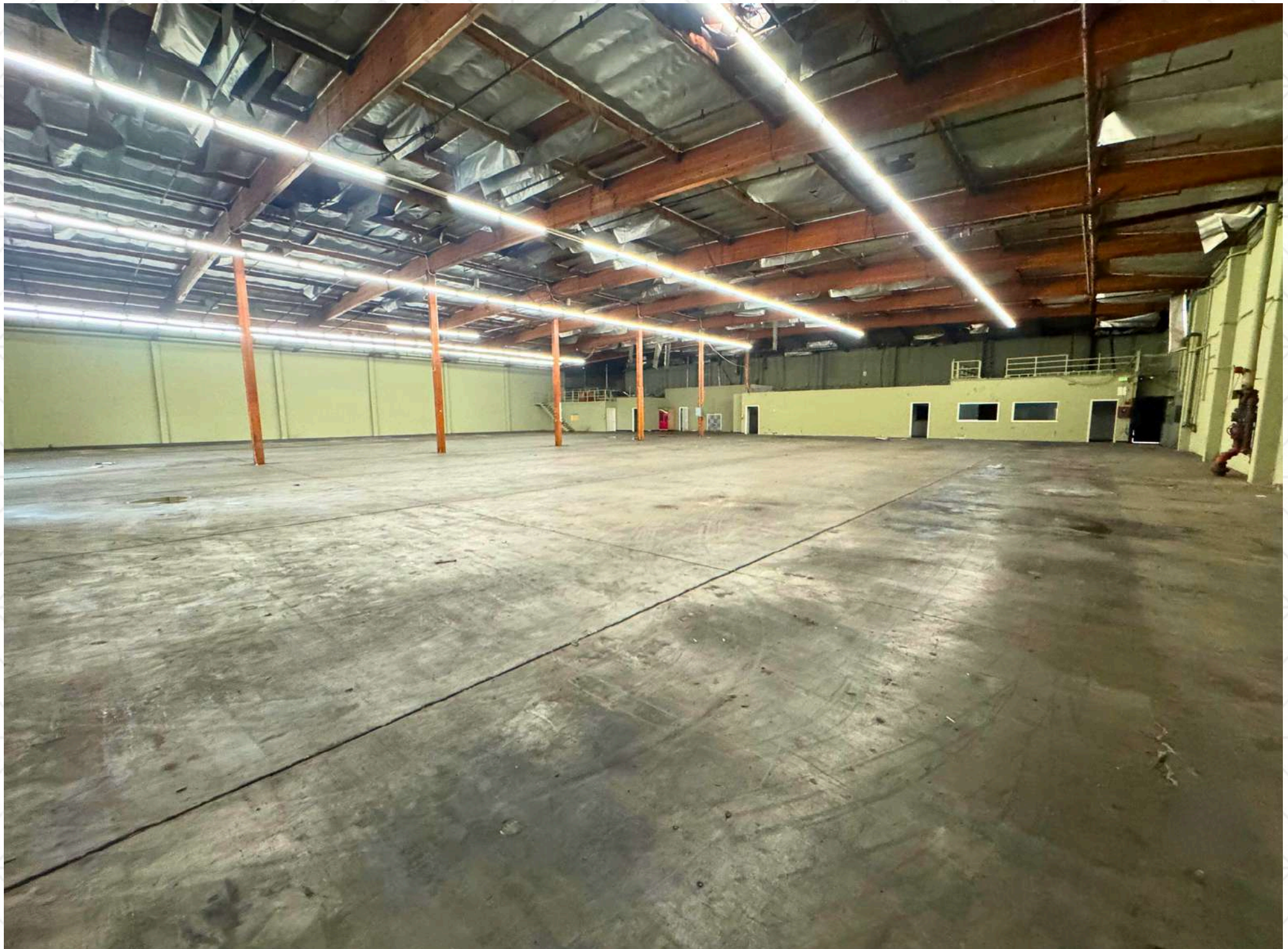

FLOOR LAYOUT

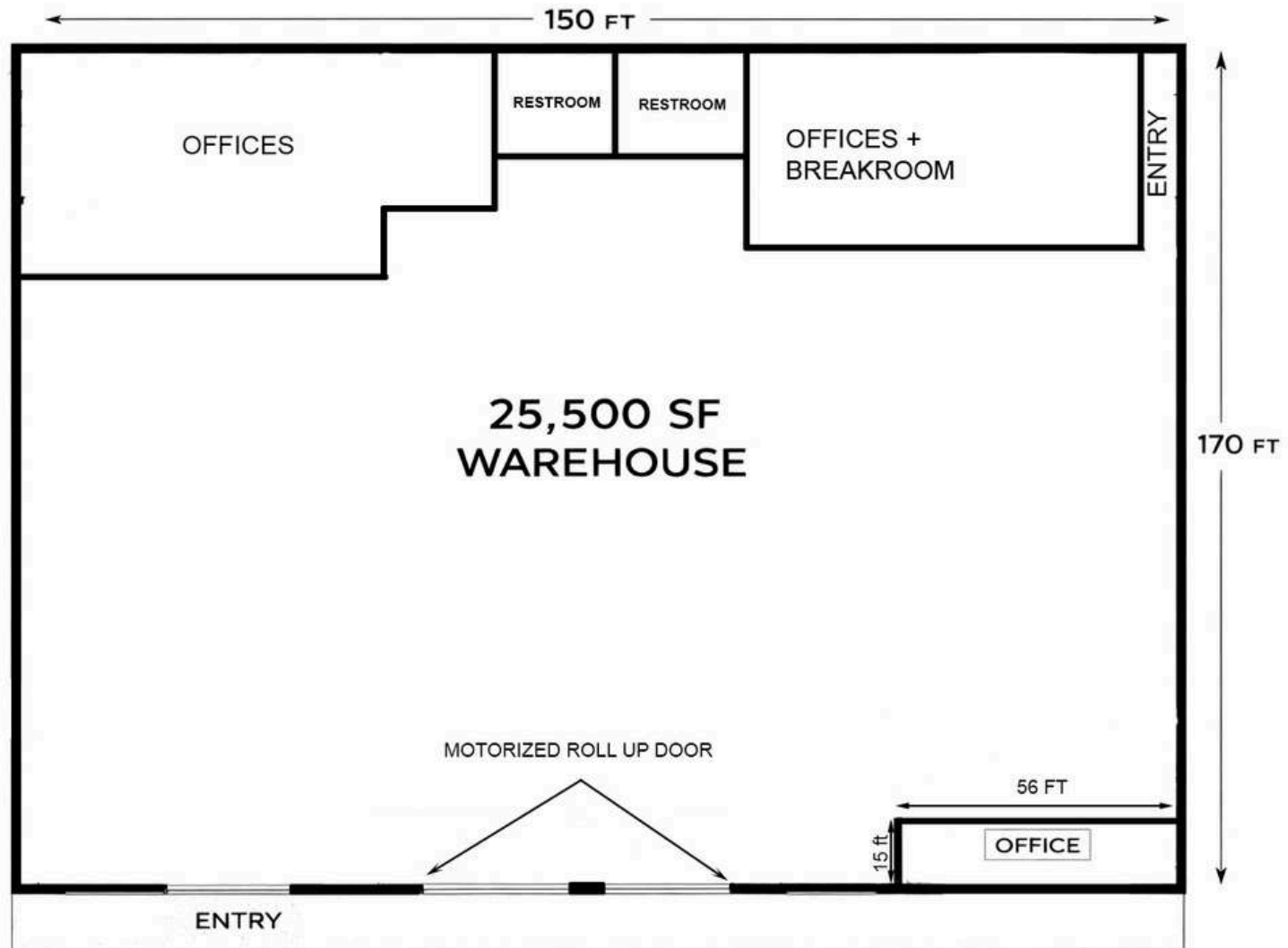

**Not drawn to scale and provided for visual representation purposes only.*

GREAT FREEWAY EXPOSURE



Collection Street	Cross Street	Traffic Volume (VPD)	DISTANCE FROM THE PROPERTY
S San Pedro St	E 20th St SW	25,706	0.15 mi
E 22nd St	S San Pedro St NW	23,919	0.07 mi

663 E 22nd St

**FOR MORE INFORMATION REGARDING THIS
OPPORTUNITY, PLEASE CONTACT:**



JESSE MCKENZIE

Senior Vice President

714.883.6875

jesse@majorproperties.com

License: CA # 01939062

The information contained in this offering material is confidential and furnished solely for the purpose of a review by prospective Buyers of the subject property and is not to be used for any other purpose or made available to any other person without the express written consent of Major Properties.

This Brochure was prepared by Major Properties. It contains summary information pertaining to the Property and does not purport to be all-inclusive or to contain all of the information that a prospective Buyer may desire. All information is provided for general reference purposes only and is subject to change. The summaries do not purport to be complete or accurate descriptions of the full documents involved, nor do they constitute a legal analysis of such documents.

This information has been secured from sources we believe to be reliable. We make no representations or warranties, expressed or implied, as to the accuracy of the information. References to square footage or age are approximate. Recipient of this report must verify the information and bears all risk for any inaccuracies.

MajorProperties.com

MAJOR PROPERTIES

1200 W Olympic Blvd

Los Angeles, CA 90015

