

9th & San Pedro Creative Use Campus Flower District



Creative Use Campus in the heart of Flower District / Fashion District at the corner of 9th Street and San Pedro Street.

- Retail Spaces - Creative Spaces - Warehouse - Single Offices
- 4,000 sq. ft. Retail Space
- 1,700 sq. ft. Retail Space
- 3,000 sq. ft. Warehouse.
- 3,000 sq. ft. Second Floor Office/ Showroom
- Single Offices (Starting \$425 per month)
- A Mile from either South Park or the Arts District
- Abundant Onsite Parking
- **[For A Virtual Tour Click Here](#)**



Kayhan Shakib
kayhan@shakib.com
(310)820-0700

9th & San Pedro Creative Use Campus



718 E. 9th Street

Size: 4,000 Sq. Ft..

Rental Rate: \$10,000

- Free Standing Building
- Exposed ceiling
- HVAC in Offices
- 400 AMP/ 3- Phase Electric Panel
- Great Visibility
- **AVAILABLE DECEMBER 1ST, 2024**



9th & San Pedro Creative Use Campus



711 E. 9th Place, Unit A

Size: 3,000 sq. ft.

Rental Rate: \$4,800

- Ground Floor Warehouse / Creative Space
- Concrete Floors
- Exposed ceiling
- 400 Amp / 3- Phase Electrical Panel
- Front and Back Entry
- Ceiling height 8 ft



9th & San Pedro Creative Use Campus



711 E. 9th Place, Unit C

Size: 3,000 sq. ft.

Rental Rate: \$4,800

- Second Floor Creative Space
- Currently set up as Photo Studio
- 400 Amp / 3- Phase Electrical Panel
- HVAC
- [For a Virtual Tour Click Here](#)

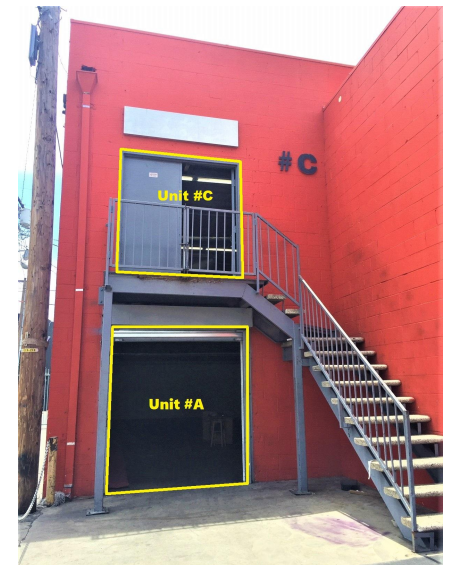

9th & San Pedro Creative Use Campus



926 S. San Pedro Street, Single Offices

Size: 150 sq. ft.

Rental Rate: Starting at \$421

- Private Single Offices
- Furnished and Unfurnished Options Available
- [For A Virtual Tour Click Here](#)

