



# SOUTHPOINTE AT FOLSOM RANCH

MEDICAL BUILDINGS | FOR SALE

WHITE ROCK ROAD & E BIDWELL ST



# THE OFFERING

Southpointe at Folsom Ranch is a premier 11.71-acre commercial and medical hub within the 3,585-acre Folsom Ranch master-planned community. Strategically positioned at East Bidwell Street and White Rock Road, this development serves as a high-end healthcare gateway in one of Northern California's fastest-growing corridors.

The project is supported by an affluent, rapidly expanding population that is growing at triple the regional average. With a high concentration of premium insurance holders—including active seniors and young families—Southpointe is perfectly positioned to meet the sophisticated healthcare demands of the Folsom Ranch community.

## PROPERTY HIGHLIGHTS



**High-Visibility Location**



**Fully Entitled**



**Multi-Story and Single-Story Floorplans**



**Adjacent to Regional Medical Campuses**



**Direct access to Capital Southeast Connector**



**Modern Professional Architectural Design**



**Condos Available**



**Onsite Dining and Retail Amenities (Coming Soon)**



# SITE PLAN

MEDICAL BUILDINGS FOR SALE

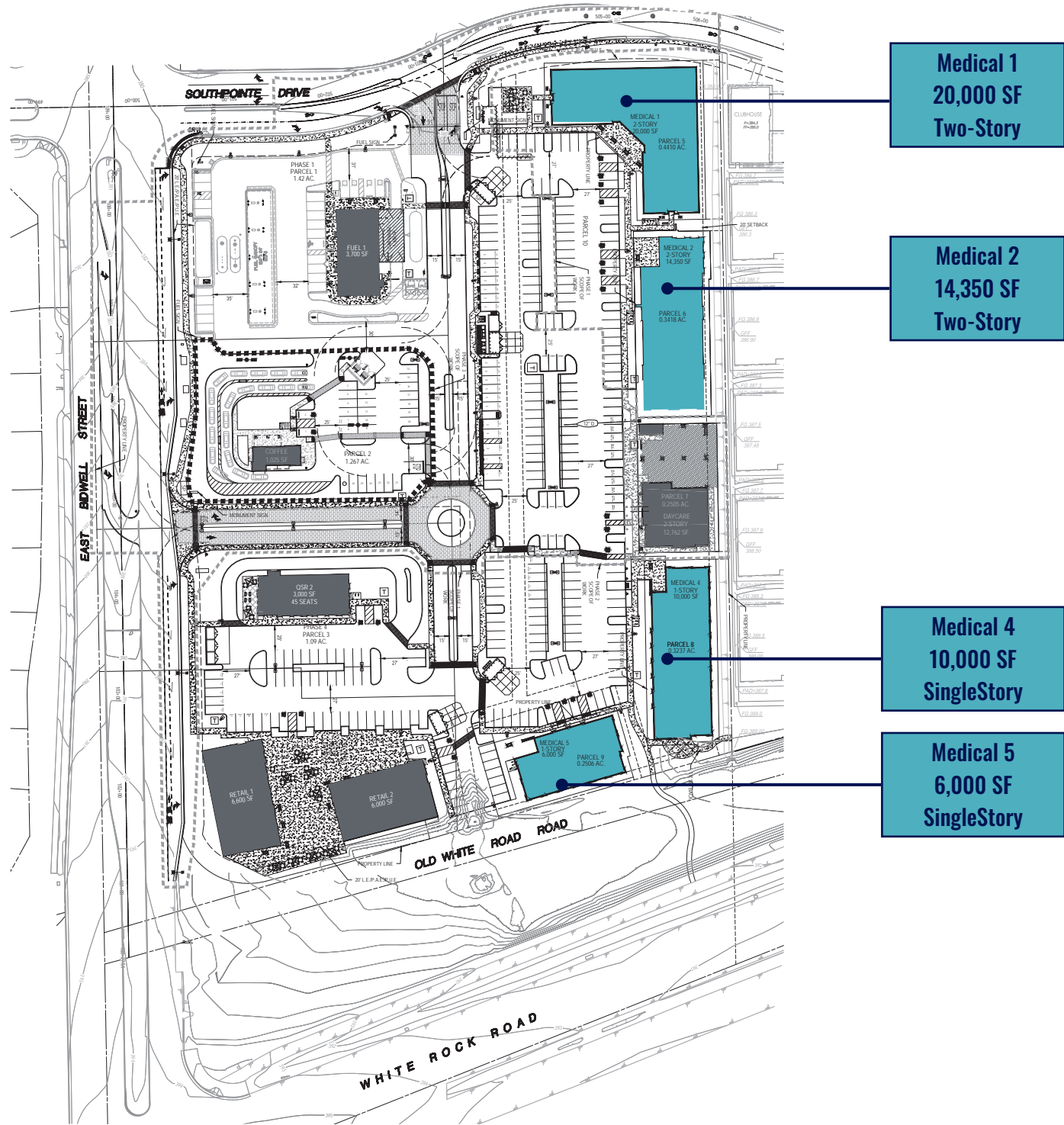

# CONCEPTUAL BUILDINGS



SITE VIDEO



# FOLSOM RANCH

**Folsom Ranch** represents a long-term demand driver for medical and office, and service-oriented commercial uses. The scale of residential growth and job creation supports sustained consumer spending, workforce expansion, and increased need for community-serving amenities — positioning **Southpointe** to benefit from strong demographic tailwinds.

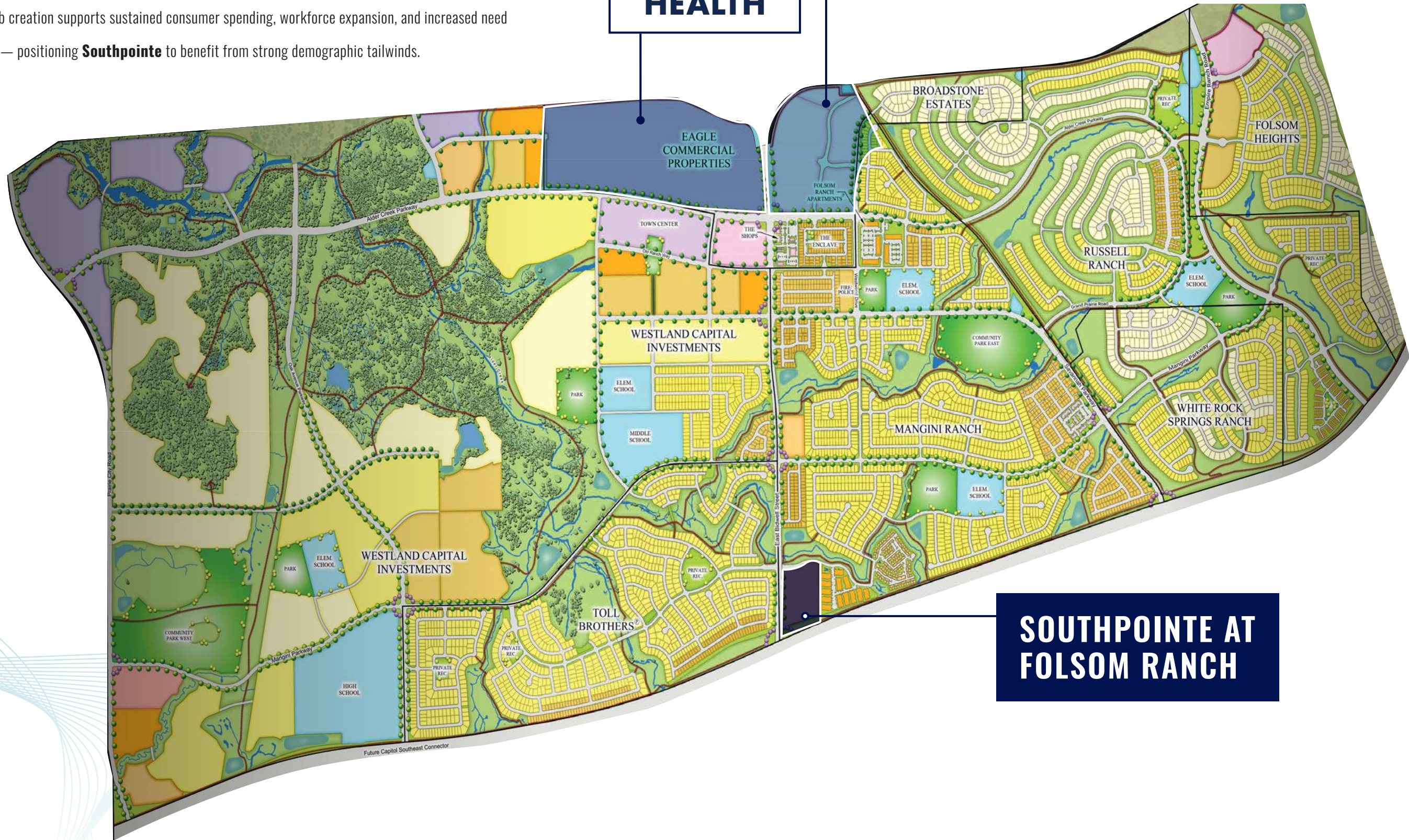

**SOUTHPOINTE AT FOLSOM RANCH**

# STRONG MARKET FUNDAMENTALS. SUSTAINABLE VALUE CREATION.

## FOLSOM BY THE NUMBERS



**\$154,082**  
Median Household Income

**49** Developed Parks Totaling  
**435 Acres**

**69.4%**  
Home Ownership Rate

**93,000+**  
Population and Growing



**267**  
Sunny Days

Folsom Is in One of the  
Sunniest Metro Areas  
in the Country.



**54.2%**  
Bachelor Degree or Higher



**50 Miles+**  
of Paved Trails



SOUTHPOINTE AT FOLSOM RANCH

# MAJOR MEDICAL DEVELOPMENTS



Dignity Health®



Sutter Health  
Sutter Medical Center



CAPITAL | SOUTHEAST  
CONNECTOR JPA  
Connecting Communities



KAISER PERMANENTE®



Dignity Health®



UC DAVIS  
HEALTH

## FOLSOM RANCH



SOUTHPOINTE AT  
FOLSOM RANCH



# SOUTHPOINTE AT FOLSOM RANCH

## **Eric Ortiz**

Executive Vice President  
+1 916 563 3095  
eric.ortiz@colliers.com  
CA Lic. 01821549

## **Curt Allen**

Associate Vice President  
+1 916 563 3019  
curt.allen@colliers.com  
CA Lic. 01959536



This document/email has been prepared by Colliers for advertising and general information only. Colliers makes no guarantees, representations or warranties of any kind, expressed or implied, regarding the information including, but not limited to, warranties of content, accuracy and reliability. Any interested party should undertake their own inquiries as to the accuracy of the information. Colliers excludes unequivocally all inferred or implied terms, conditions and warranties arising out of this document and excludes all liability for loss and damages arising there from. This publication is the copyrighted property of Colliers and /or its licensor(s). © 2026. All rights reserved. This communication is not intended to cause or induce breach of an existing listing agreement.