

# 1865

SECOND AVENUE

CORNER OF 96TH STREET  
UPPER EAST SIDE

LEASED

SPACE A



# 1865

## SECOND AVENUE

CORNER OF 96TH STREET  
UPPER EAST SIDE

Space A: 1,000 SF Ground Floor

Space B: 800-SF Ground Floor

LEASED

FRONTAGE: Space A: 60' Wraparound  
Space B: 42' on 96th St

CEILING HEIGHT: 17'

POSSESSION: Immediate

ASKING RENT: Upon Request

TRANSPORTATION: Q 6

HIGHLIGHTS:

- Formerly Capital One bank
- All uses considered
- Steps from the Second Avenue subway line
- Across the street fom Metropolitan Hospital
- High foot traffic area in dense residential neighborhood
- Neighboring tenants include: Dunkin', McDonald's, Perk Coffee, Azure Nails & Spa, Starbucks, Key Food, Madame Bonte Cafe, Go Cups, Merrion Square Pu, Soledad, NYC Health + Hospitals/Metropolitan: ER



All information supplied in this marketing presentation and/or flyer is from sources deemed reliable and is furnished subject to errors, omissions, modifications, removal of listings from sale/lease and to any listing condition. Any square footage, dimensions, floor plans and/or technical data set forth are approximations and are subject to further elaboration/confirmation.

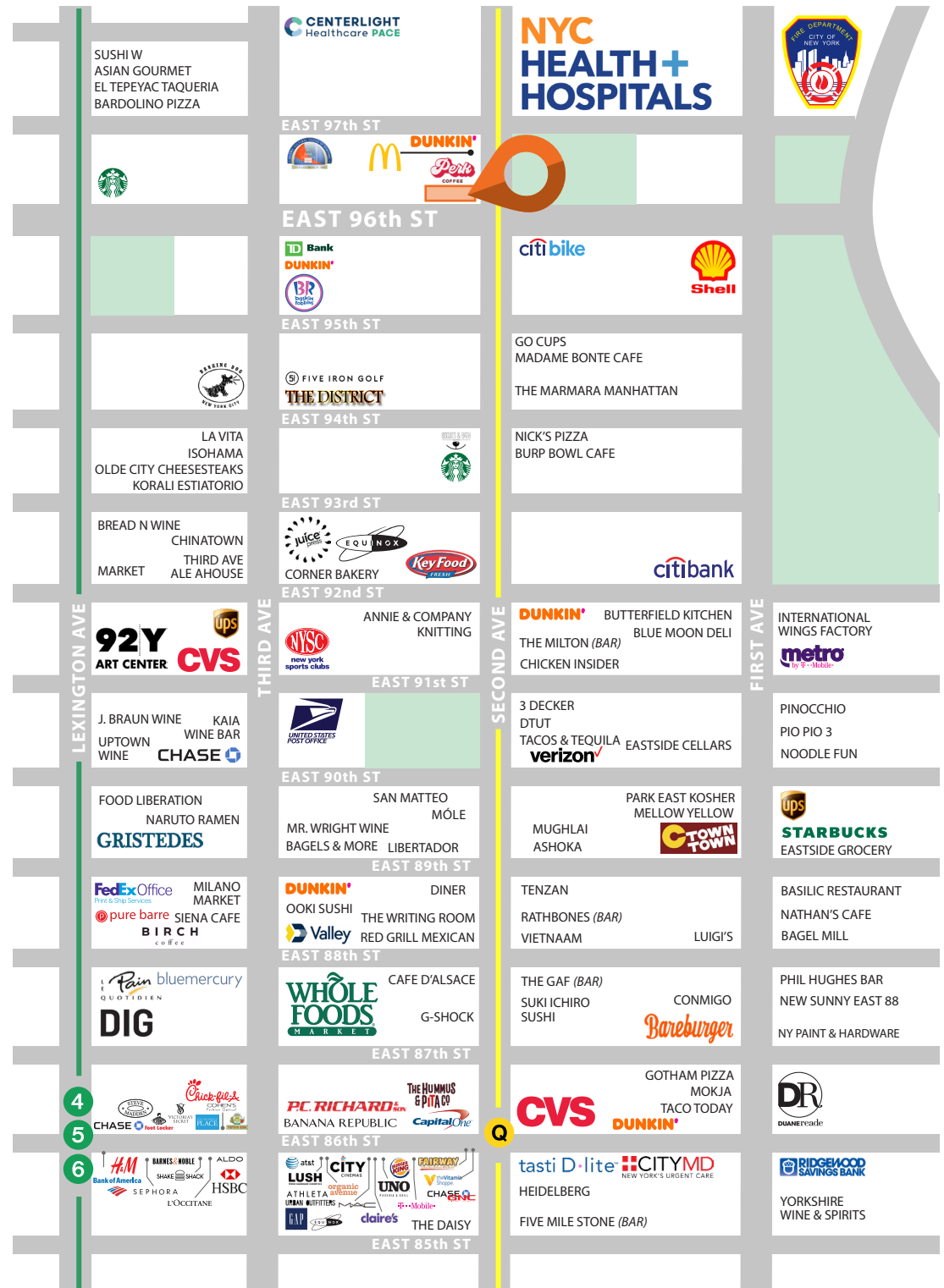

# 1865

SECOND AVENUE

FLOOR PLANS

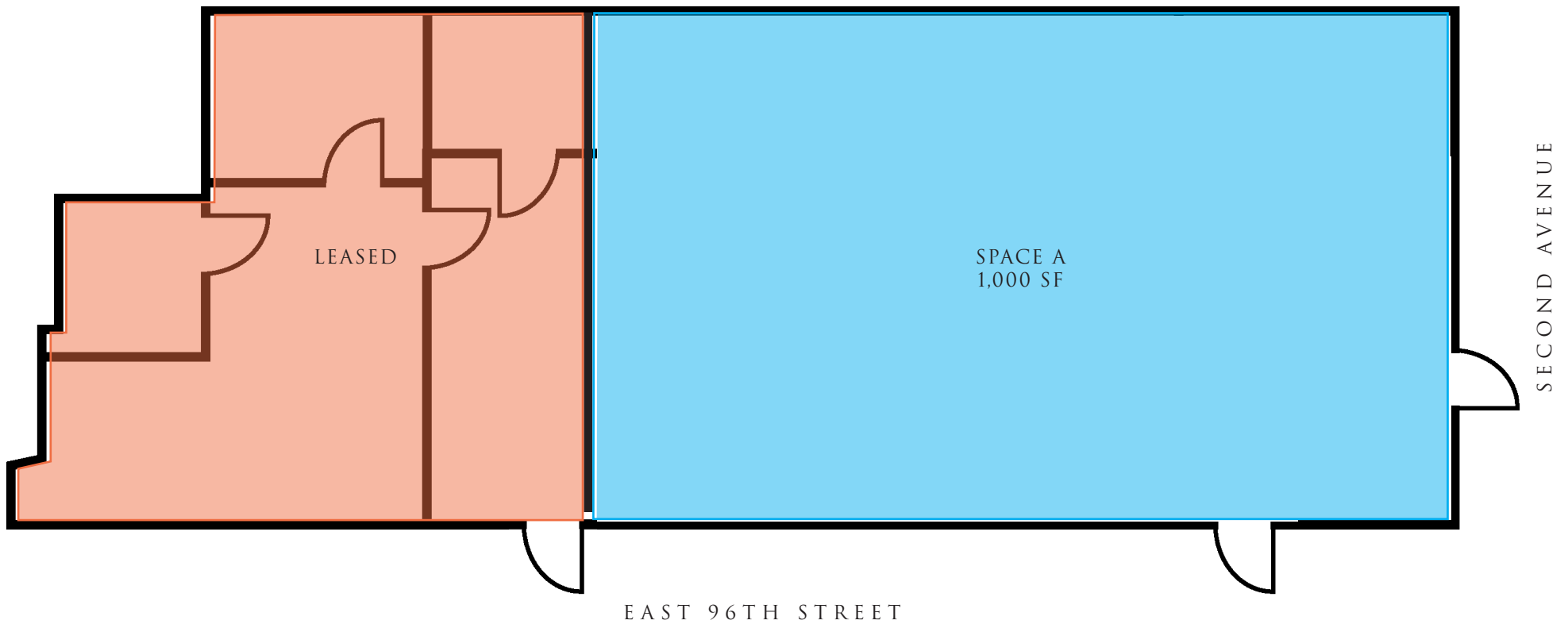

All information supplied in this marketing presentation and/or flyer is from sources deemed reliable and is furnished subject to errors, omissions, modifications, removal of listings from sale/lease and to any listing condition. Any square footage, dimensions, floor plans and/or technical data set forth are approximations and are subject to further elaboration/confirmation.

# 1865

SECOND AVENUE

CORNER OF 96TH STREET  
UPPER EAST SIDE

FOR MORE INFORMATION,  
PLEASE CONTACT:

**MALIK WILLIAMS WELLS**

929.260.8080 | [Malik@ksrny.com](mailto:Malik@ksrny.com)

**SAMUEL CHERA**

718.614.1731 | [SChera@ksrny.com](mailto:SChera@ksrny.com)

**NATHAN ABALLI**

917.915.8763 | [NAballi@ksrny.com](mailto:NAballi@ksrny.com)

