



LAB / WAREHOUSE

4,615± SF Available
Lease Rate: 95¢/SF Per Month, MG

Address	SF Available	Lease Rate
325 S. Euclid Ave Suite 115	4,615± SF	\$4,384.25 / Mo, MG

Property Highlights

- Office/lab spaces
- Floor plan can be remodeled to suit
- Nicely maintained business park
- Close proximity to Downtown and the U of A
- Located in the Opportunity Zone



Stephen D. Cohen
Principal, Industrial Properties
+1 520 546 2750
scohen@picor.com

PICOR Commercial Real Estate Services
5151 E. Broadway Blvd, Suite 115
Tucson, Arizona 85711
phone: +1 520 748 7100
picor.com

Floor Plan

325 S. Euclid Ave Suite 115

LAB/WAREHOUSE

Property Details

Available SF	4,615± SF
Ceiling Height	14'
Loading	10x10 Grade Level
Power	120/240 volt, 3 Phase (Heavy)
HVAC	100% A/C
Construction	Concrete Tilt-Up
Year Built	1988
Zoning	I-1 (Light Industrial, City of Tucson)

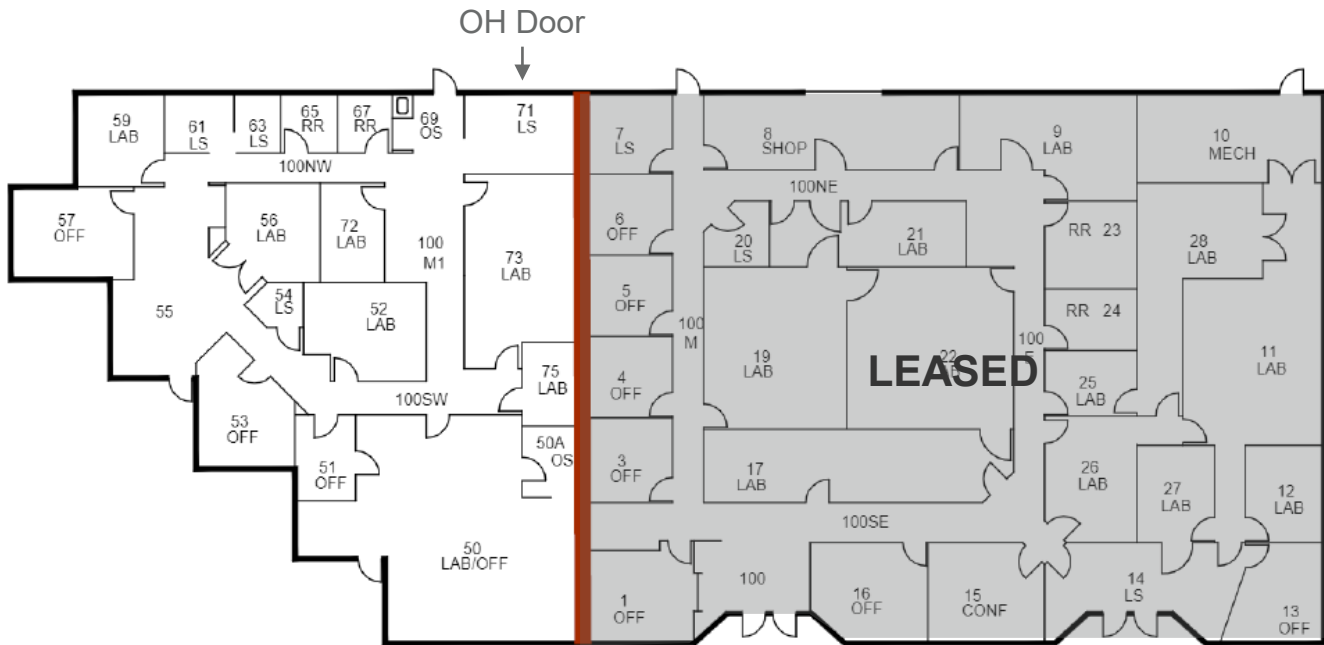

Stephen D. Cohen
 Principal, Industrial Properties
 +1 520 546 2750
 scohen@picor.com

PICOR Commercial Real Estate Services
 5151 E. Broadway Blvd, Suite 115
 Tucson, Arizona 85711
 phone: +1 520 748 7100
 picor.com

Site Plan

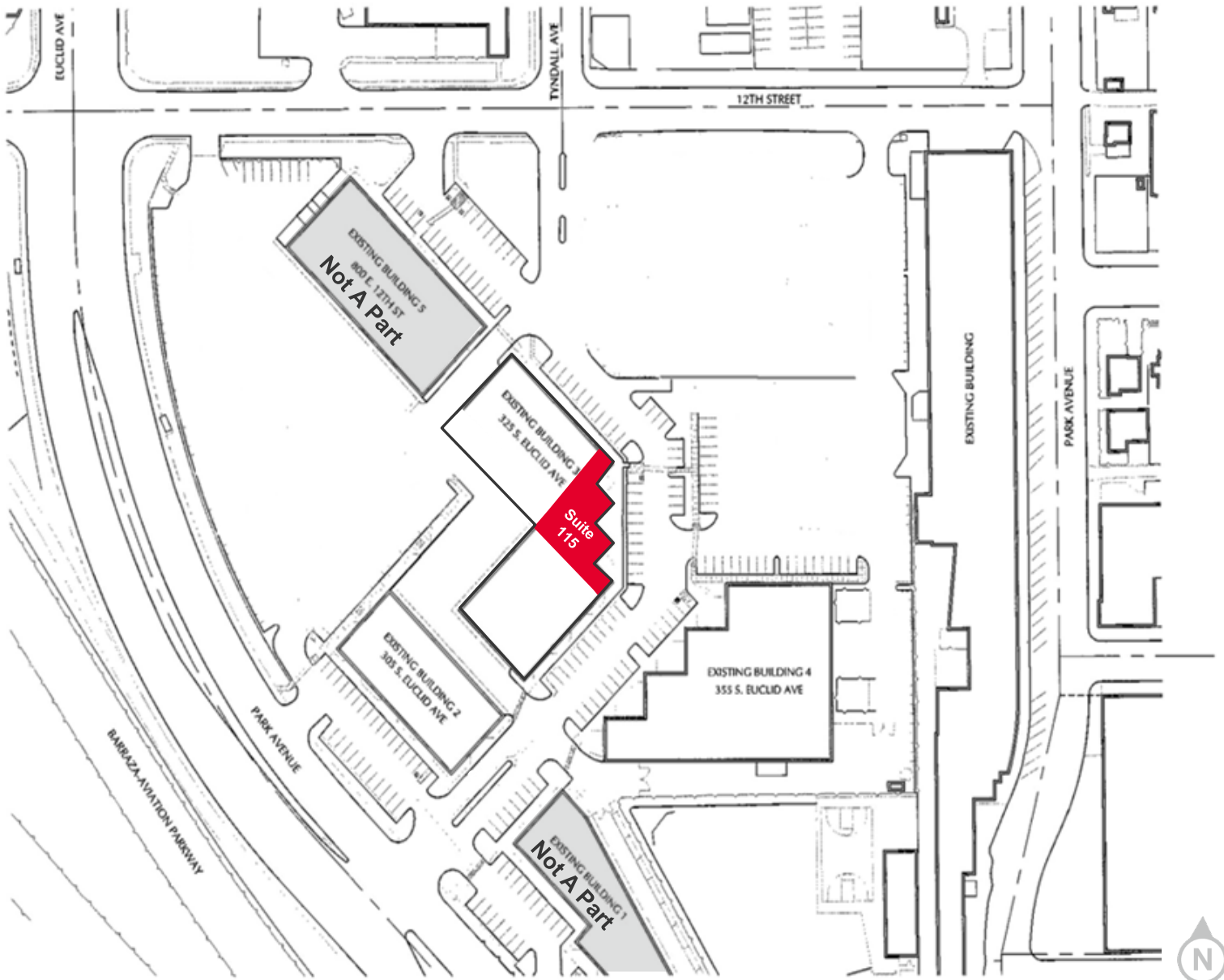

*NOT TO SCALE

Stephen D. Cohen
Principal, Industrial Properties
+1 520 546 2750
scohen@picor.com

PICOR Commercial Real Estate Services
5151 E. Broadway Blvd, Suite 115
Tucson, Arizona 85711
phone: +1 520 748 7100
picor.com

Independently Owned and Operated / A Member of the Cushman & Wakefield Alliance

Cushman & Wakefield Copyright 2021. No warranty or representation, express or implied, is made to the accuracy or completeness of the information contained herein, and same is submitted subject to errors, omissions, change of price, rental or other conditions, withdrawal without notice, and to any special listing conditions imposed by the property owner(s). As applicable, we make no representation as to the condition of the property (or properties) in question.

7/19/2024

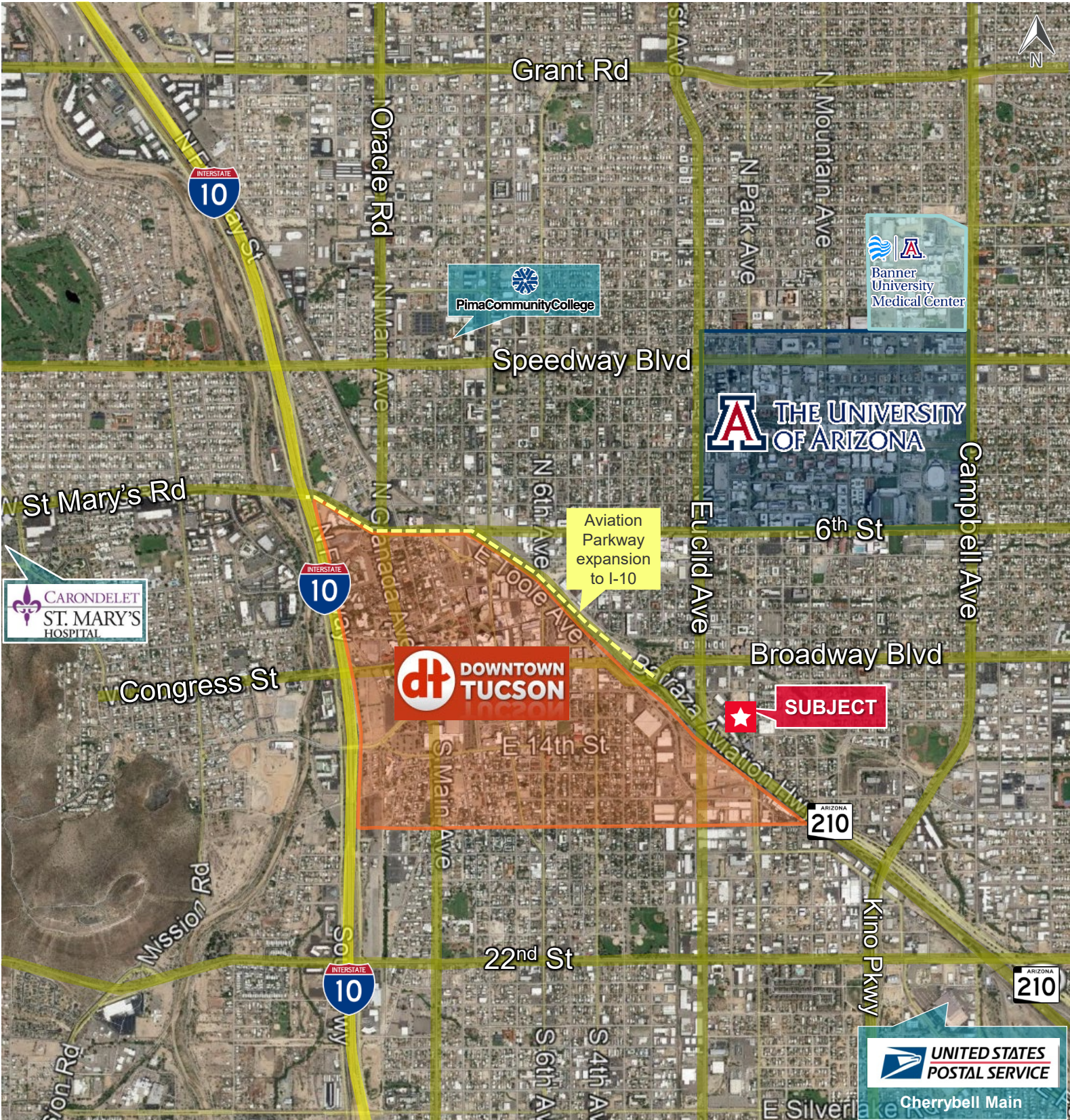

CUSHMAN & WAKEFIELD | PICOR
TUCSON
At a Glance

 **1.072M**
 TUCSON MSA
 POPULATION

 **437,780**
 TOTAL HOUSEHOLDS

 **30%**
 COLLEGE
 EDUCATION

 **1.3%**
 POPULATION
 GROWTH RATE

 **\$59,215**
 MEDIAN HOUSEHOLD
 INCOME

 **3.2%**
 UNEMPLOYMENT
 RATE

Source: arizona.edu, BLS, ACS 02/19/24

LARGEST EMPLOYERS

1. UNIVERSITY OF ARIZONA- 16,699
 2. RAYTHEON MISSILE SYSTEMS- 13,000
 3. DAVIS-MONTHAN AFB- 11,769
 4. STATE OF ARIZONA – 8,580
- www.arizona.edu, suncorridorinc.com

RECENT INDUSTRY ARRIVALS & EXPANSIONS

1. AMAZON
2. CATERPILLAR SURFACE MINING & TECHNOLOGY
3. HEXAGON MINING
4. BECTON DICKINSON
5. AMERICAN BATTERY FACTORY

Cushman & Wakefield | PICOR



46,932

**UNIVERSITY OF ARIZONA
 TOTAL ENROLLMENT, 2024**

- #3 MANAGEMENT INFORMATION SYSTEMS
- #10 SPACE SCIENCE
- #17 MEDICINE
- #18 EDUCATION
- #48 TOP PUBLIC SCHOOL
- #54 UNDERGRAD ENGINEERING PROGRAMS
- #67 COLLEGES FOR VETERANS
- #47 BEST BUSINESS SCHOOLS
- #99 BEST GLOBAL UNIVERSITY

UNIVERSITY OF ARIZONA TOP PROGRAMS
 U.S. News & World Report