

Centerpoint IOS

Adjacent to MIA Cargo / NW 32nd St and NW 67th Ave



Centerpoint IOS | Adjacent to MIA Cargo / NW 32nd St and NW 67th Ave

THE PARK



Highlights

- +/- 2.99 - 17.156 Acres
- +/- 130,244 - 746,451 SQ FT
- +/- 1,200 parking stalls
- Option to Subdivide
- Strategic Location
- Truck Accessibility
- Security Features

Asking Rate

\$5.00 PSF NNN



Centerpoint IOS

Adjacent to MIA Cargo / NW 32nd St and NW 67th Ave



Centerpoint IOS | Adjacent to MIA Cargo / NW 32nd St and NW 67th Ave

THE LOCATION

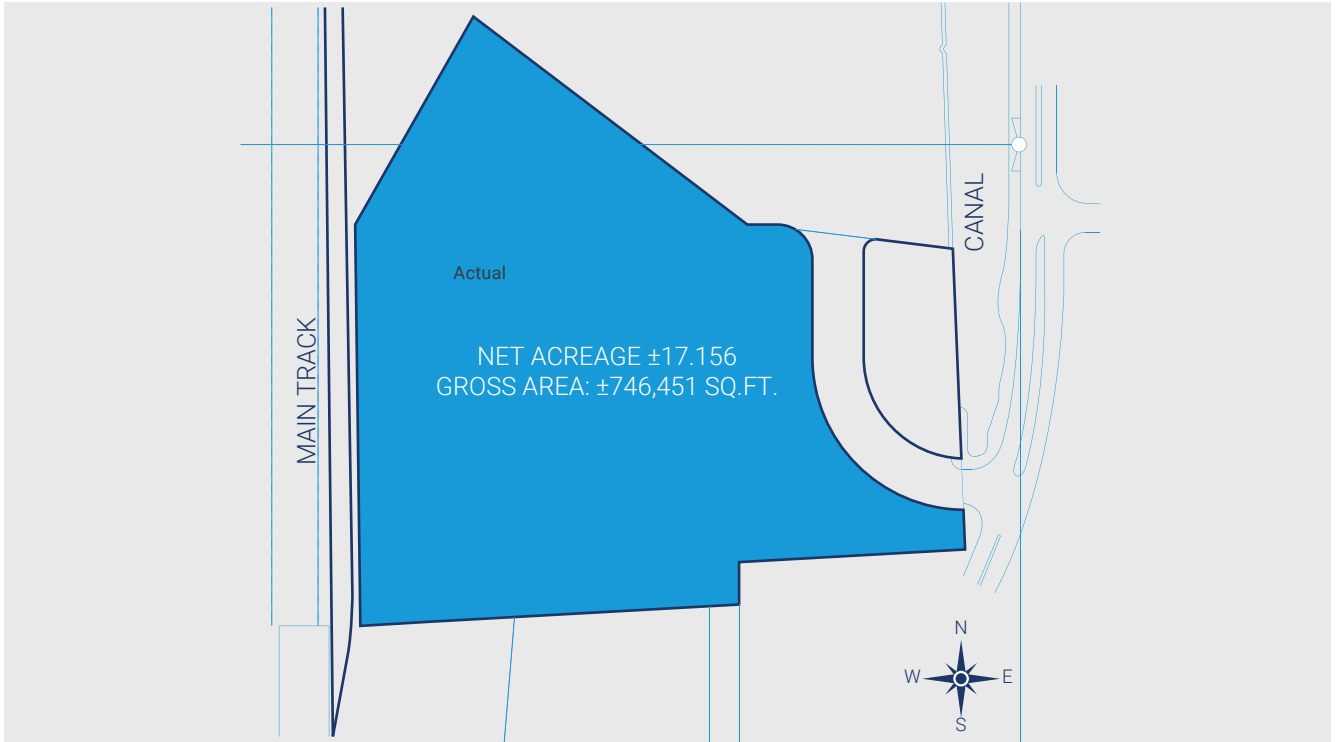

Key Advantages

Proximity to Major Highways and Transport Links:

- Florida East Coast Railway Hialeah Yard
- Palmetto Expressway
- MIA Cargo
- MIA Cargo Viaduct

Accessibility:

- Easy Access for trucks
- Wide road
- Turning areas

Security Features:

- Fenced Perimeter
- Gated Access
- Lighting
- Asphalt/ Paved Parking Surface



Sub-divisible:
+/- 2.99 - 17.156 acres



Carlos Velasquez, SIOR

786.547.4483

cvelasquez@vsre.net

Chris Sutton, SIOR

305.781.0340

csutton@vsre.net



Jonathan Guffey

Vice President

Asset Management

jguffey@centerpoint.com

centerpoint.com