



FOR LEASE

1633 MARKET ST.

WAREHOUSE
* SPACE



±10,000 SF WITH ±5,000 SF OUTDOOR SPACE

Rare freestanding
corner warehouse
opportunity in Downtown
San Diego

UPG **URBAN**
PROPERTY
GROUP est. 1989





FOR LEASE $\pm 10,000$ SF WAREHOUSE PLUS $\pm 5,000$ SF OUTDOOR SPACE

LOCATION

This prime location offers immediate proximity to Downtown San Diego and is strategically positioned near the I-5 & 94 on- and off-ramps allows for easy access and decreased drive times to larger population density.

HIGHLIGHTS

- Available Now
- Rare freestanding corner warehouse/office
- 4 overhead doors
- 24' ceiling height
- Market Street is a major corridor with a daily traffic count of over 14,200 cars per day
- Fantastic visibility, signage, and ability to brand entire building



LEASING DETAILS

Pasquale Ioele
pasquale@upgsocal.com
Lic. ID 01488187

Andrew Shemirani
andrew@upgsocal.com
Lic. ID 02038814

Serena Patterson
serena@upgsocal.com
Lic. ID 01721040





A LITTLE BIT ABOUT 1633 MARKET ST.

*FOR
LEASE

±10,000 SF WAREHOUSE
PLUS ±5,000 SF
OUTDOOR SPACE

Class	C
Zoning	CCPD-R
Land SF	15,420 SF
Drive Ins	3 tot./14' w x 12' h
Clear Height	20'
Power	Available
Parking Spaces	Surface - 6
Fire Sprinklers	Yes

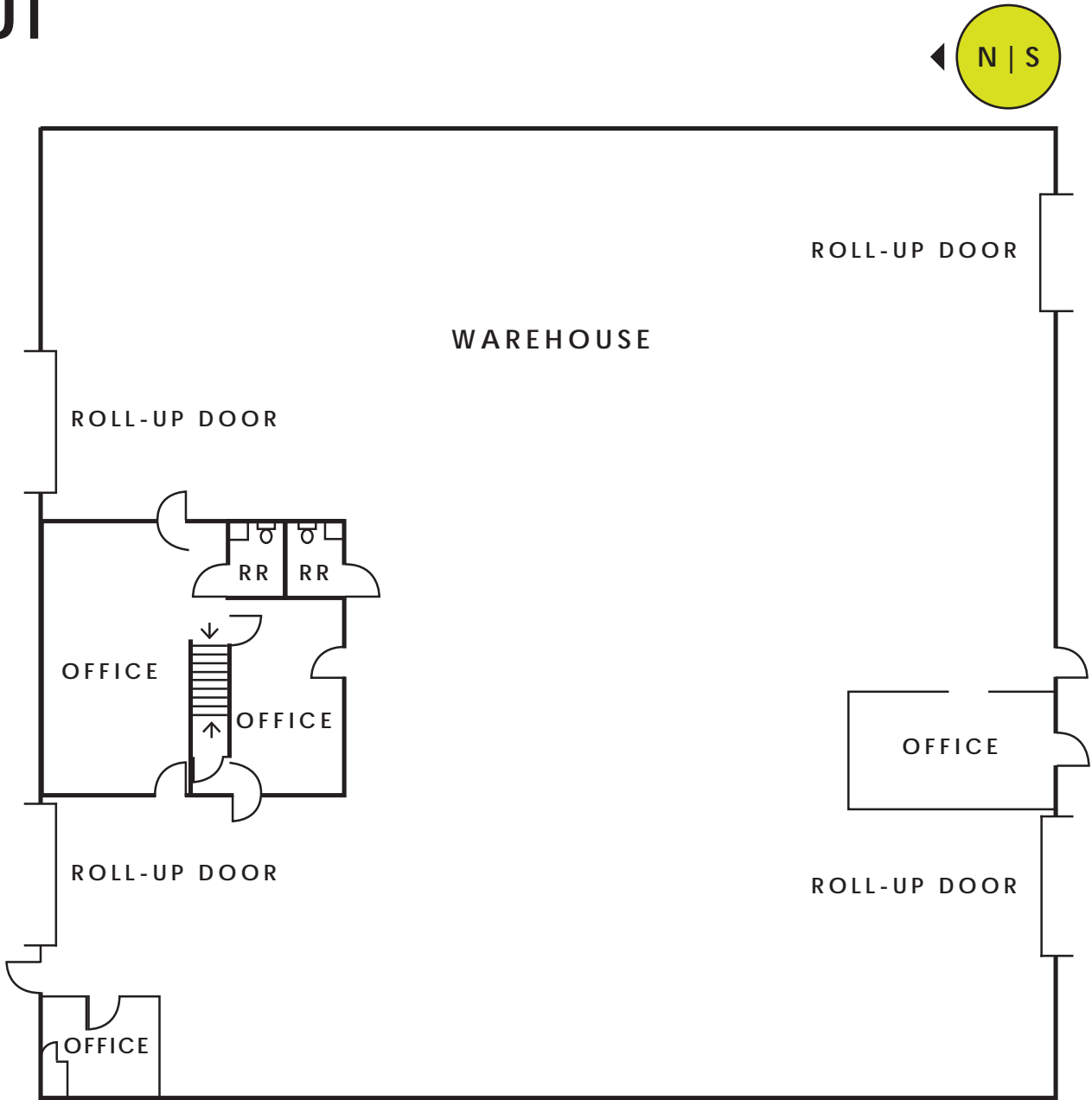

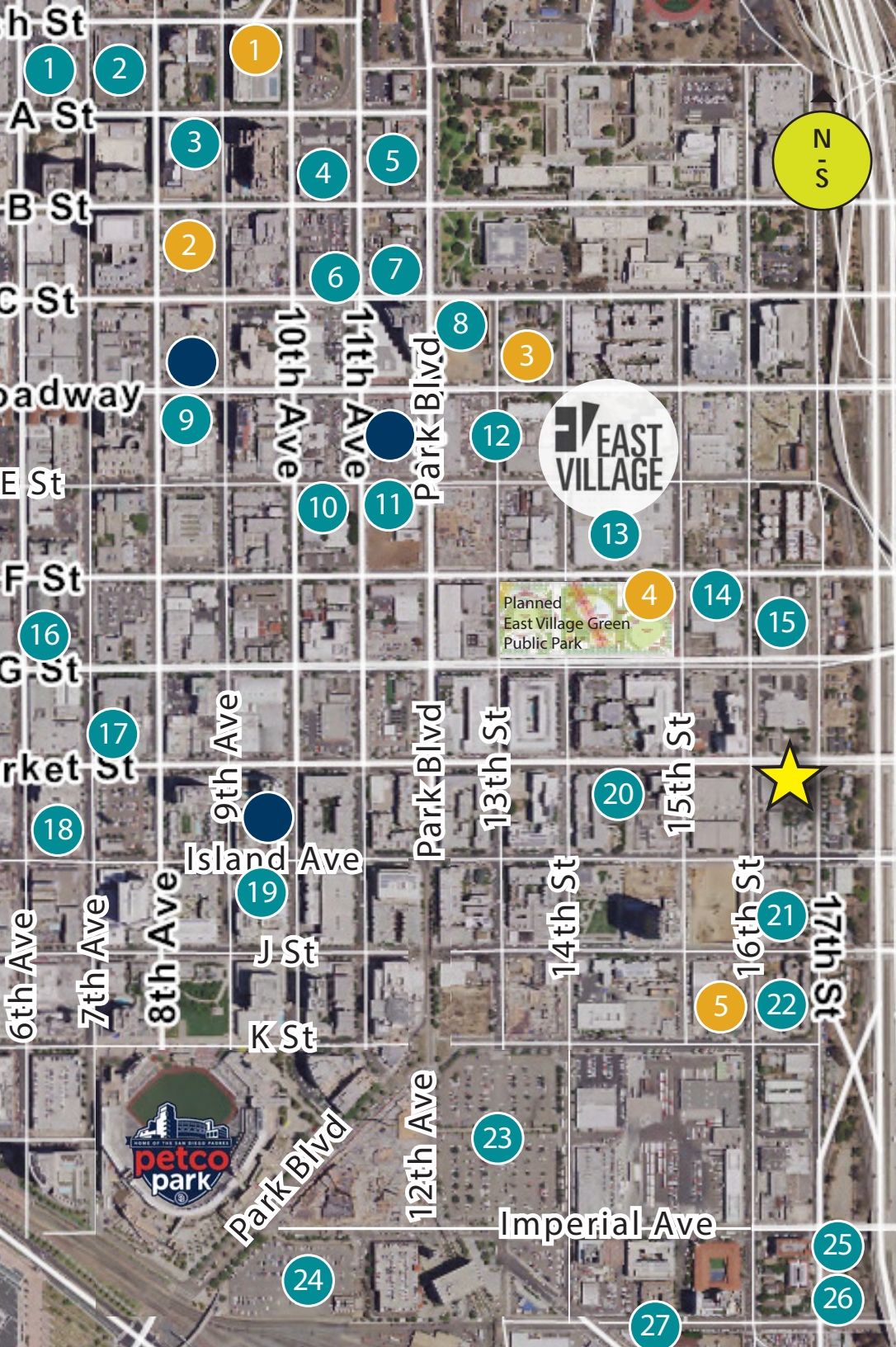

E A S T V I L L A G E

DEVELOPMENT PIPELINE

Q 4 - 2 0 2 5

- Recently Completed
- Pipeline
- Under Construction



**CA Ventures;
800 Broadway**
422 units; 5,800 sf retail



**Pinnacle International;
Broadway Tower 2**
395 units; 4,300 sf retail



**K Elevate 10th Street Property,
LLC; Elevate Hotel**
135 rooms



**Jacaranda on 9th
Apartments**
88 units

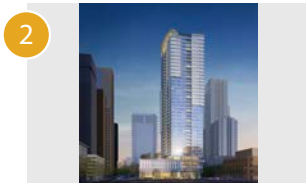

Bosa; 8th & B
398 units; 9,400 sf retail;
.5-acre public park



**Chelsea Investment Co.;
13th & Broadway**
273 units; 1,600 sf retail



East Village Green Public Park
4.1-acre public park including: a children's playground; dog park; community center; public green space; 180-space underground parking



Riaz Capital
259 units

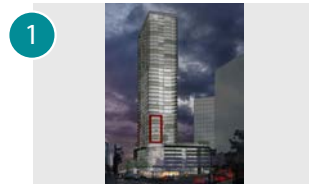

**Ghods Builders;
6th & A**
389 units; 7,000 sf retail



XJD; 7th & A
281 units; 9,000 sf retail



**Wood Partners;
The Rey Phase II**
459 units

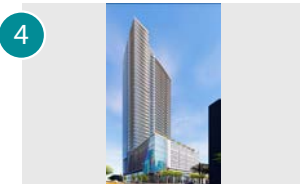

**Liberty National;
10th & B**
542 units; 4,200 sf retail



**Pinnacle International;
Pacific Heights**
492 units; 6,500 sf retail



**Liberty National;
1060 C Street**
72 units; 1,150 sf retail



**Pinnacle International;
Park & C**
444 units; 10,933 sf retail



**Liberty National;
Park and Broadway**
613 units; 18,850 sf retail



**Reef Point Hospitality LLC;
Broadway Suites**
317 rooms



**Capexco Funds;
10th & E**
365 units; 2,600 sf retail

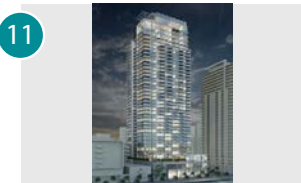

**Pinnacle International;
11th & E**
462 units; 6,000 sf retail



**Kilroy Realty;
Kilroy East Village**
840,000 sf office with retail



Navarra Properties; SuperBlock
4,905 sf retail; 550,000 sf office



Foulger-Pratt; Block F
405 units; 19,000 sf retail;
48,518 sf office

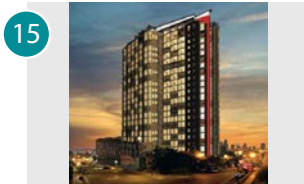

**SD Mega Block LLC;
Lucia nel Cielo**
424 units; 3,000 sf retail



**J Street Hospitality;
Motto by Hilton**
180 rooms; 2,500 sf retail



**San Diego Gaslamp Properties
LLC; Citizen M Hotel**
302 rooms



**J Street Hospitality; Tapestry &
Homewood Suites by Hilton**
324 rooms



**J Street Hospitality; Hampton Inn
by Hilton**
132 rooms



**Bahia View Condominiums;
Bahia View**
95 units; 6,600 sf retail



**Cast Development;
The Fellow**
129 units; 1,000 sf retail



Fabric Investments; Creativo
13 units; 1,000 sf retail;
2,000 sf office



**Tishman Speyer & Padres; East
Village Quarter**
1,800 units; 50,000 sf retail



JMI; The Landing
793 units; 120,000 sf retail;
683,000 sf office



1707 Imperial; Zonevest LLC
113 units



17th & Commercial
109 units



Mirka Tower
318 units

1 6 3 3 M A R K E T S T .



FOR LEASE

1633 MARKET ST.

WAREHOUSE
* SPACE

LEASING DETAILS

Pasquale Ioele
pasquale@upgsocal.com
Lic. ID 01488187

Andrew Shemirani
andrew@upgsocal.com
Lic. ID 02038814

Serena Patterson
serena@upgsocal.com
Lic. ID 01721040



upgsocal.com
858 874 1989

©2025 Urban Property Group, Inc. Information herein has been obtained from sources deemed reliable, however its accuracy cannot be guaranteed. The user is required to conduct their own due diligence and verification.

