

# 22520 - 22522 Ventura Boulevard

## Woodland Hills, CA 91364

### RETAIL SUITES FOR LEASE



**PACIFIC PARTNERS**  
COMMERCIAL, INC.

23901 Calabasas Rd., Suite 2024  
Calabasas, CA 91302  
Office 818.798.3090  
Corp ID: #02063112

#### **Lisa Shirliff**

Investment Sales & Leasing

Direct: 818.878.8853

[lisa@pacificpartnerscre.com](mailto:lisa@pacificpartnerscre.com)

CA DRE: 01891301

The information herein has been furnished from sources which we deem reliable, but has not been verified by Pacific Partners Commercial, Inc. or its agents and for which we assume no liability. This marketing material is to be used for conceptual purposes only. All measurements and numerical data are approximate and to be verified by the prospective buyer.

22520 - 22522 Ventura Boulevard  
Woodland Hills, CA 91364



## AVAILABLE FOR LEASE

SUITE NO.	SQUARE FEET	MODIFIED GROSS
22520 (1 <sup>st</sup> floor)	1414 SF	\$2.50 MG
22522 (1 <sup>st</sup> floor)	1,939 SF	\$2.50 MG
22522 (2 <sup>nd</sup> floor)	665 SF	\$2.50 MG



The plan and its contents are furnished for informational purposes only and are intended only as a general description (but not represented, covenanted or warranted). The size and location of the project, the identity or nature of any occupant and all features, matters and other information included herein are subject to change without notice and should not be relied upon by any party. No representation or warranty, express or implied, is made as to the accuracy or reliability of this plan or its contents.



**Lisa Shirliff**  
Investment Sales & Leasing  
Direct: 818.878.8853  
[Lisa@pacificpartnerscre.com](mailto:Lisa@pacificpartnerscre.com)  
CA DRE: 01891301

PACIFIC PARTNERS COMMERCIAL  
23901 Calabasas Rd., Suite 2024  
Calabasas, CA 91302  
Office 818.798.3090

# 22520 – 22522 Ventura Boulevard Woodland Hills, CA 91364



## Plat Map

- \*Prime Woodland Hills Location on Ventura Blvd.
- \*Rare Large Monument Sign Space
- \*Traffic Vehicle Counts: +35,000/Daily

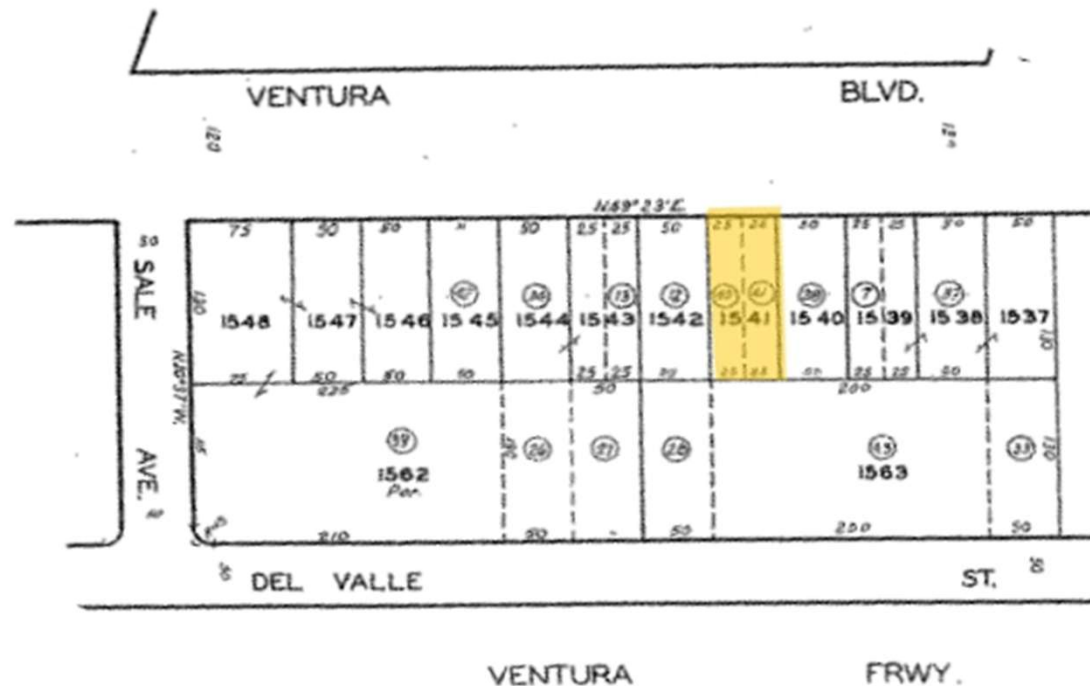

**Lisa Shirliff**  
Investment Sales & Leasing  
Direct: 818.878.8853  
[Lisa@pacificpartnerscre.com](mailto:Lisa@pacificpartnerscre.com)  
CA DRE: 01891301

PACIFIC PARTNERS COMMERCIAL  
23901 Calabasas Rd., Suite 2024  
Calabasas, CA 91302  
Office 818.798.3090

22520 – 22522 Ventura Boulevard  
Woodland Hills, CA 91364

## Map Overview

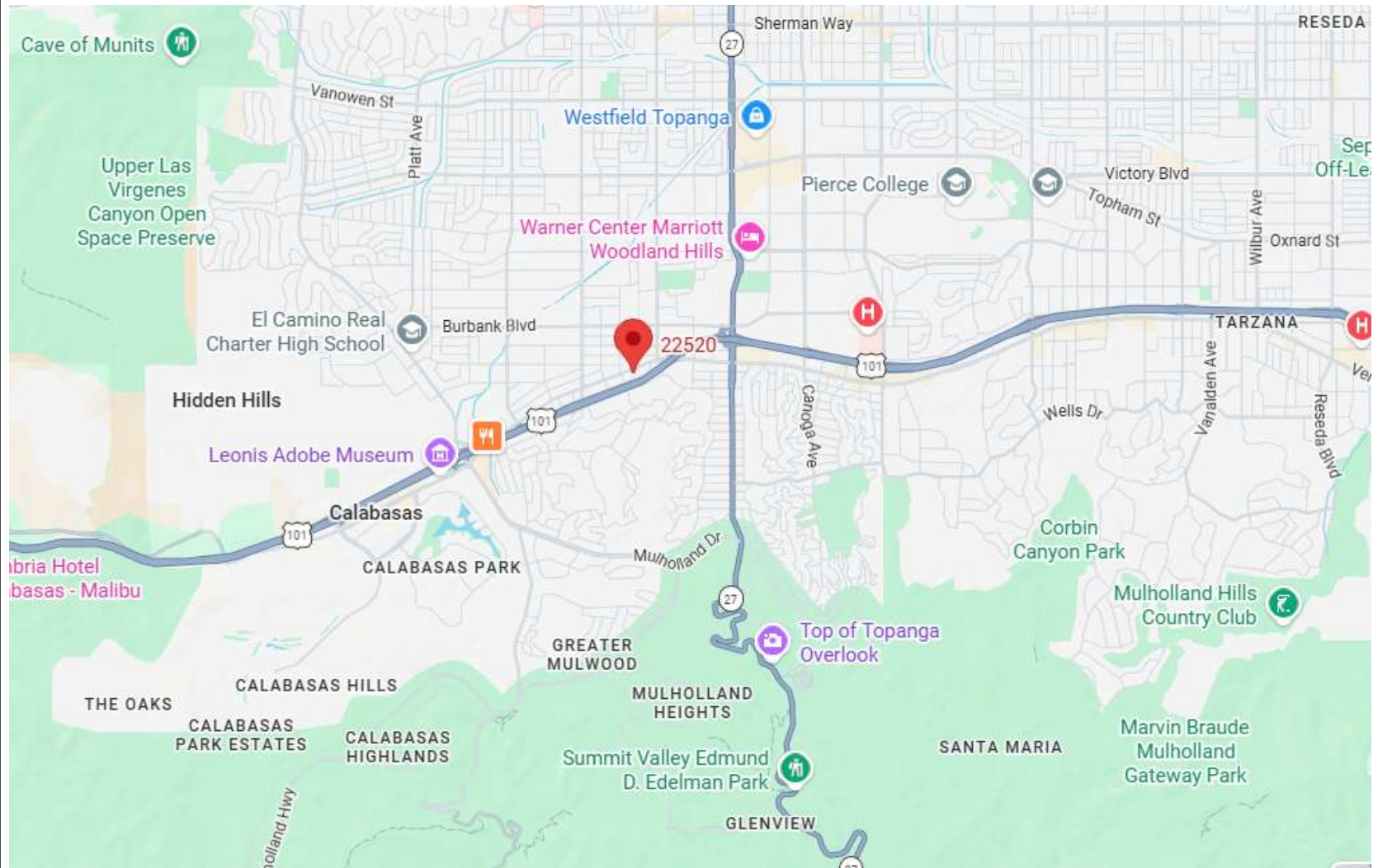

**Lisa Shirliff**

Investment Sales & Leasing

Direct: 818.878.8853

[Lisa@pacificpartnerscre.com](mailto:Lisa@pacificpartnerscre.com)

CA DRE: 01891301

PACIFIC PARTNERS COMMERCIAL

23901 Calabasas Rd., Suite 2024

Calabasas, CA 91302

Office 818.798.3090