

2709 BOND STREET  
UNIT B  
ROCHESTER HILLS, MICHIGAN

HI-TECH FOR LEASE  
9,903 Square Feet Available



**SIGNATURE  
ASSOCIATES**  
KNOW SIGNATURE | KNOW RESULTS

## ROCHESTER HILLS EXECUTIVE PARK



### PROPERTY FEATURES

- 9,903 square feet available
- 2,500 square feet of office
- 18' ceiling height
- (1) 12' x 14' grade level door, (1) scissor lift
- Zoned Industrial
- 2000 amps, 480 volts power
- Premier industrial park with direct access to M-59
- Energy saving setback thermostats throughout
- Lease Rate: \$8.95/sq.ft NNN

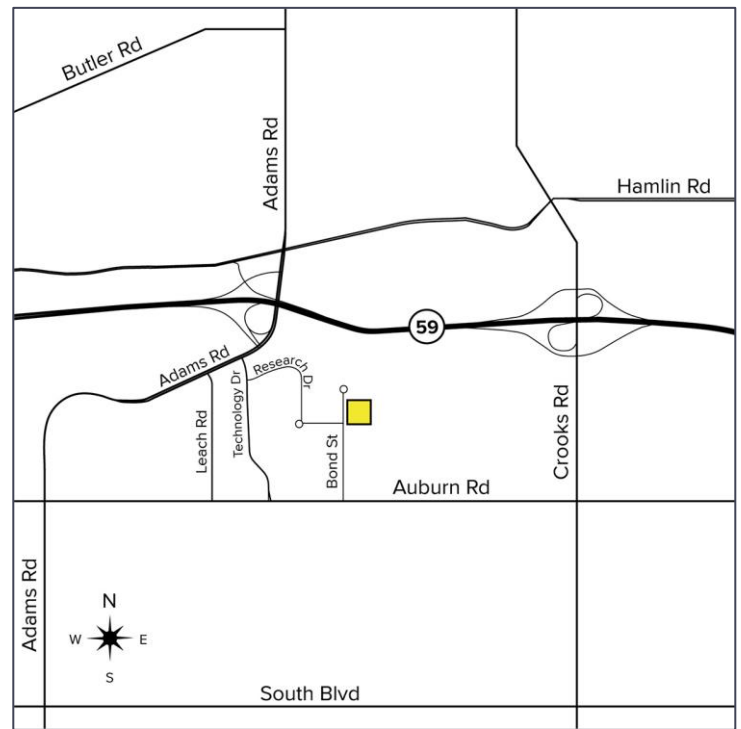

For more information, please contact:

**KRIS PAWLOWSKI**  
(248) 359 3801  
kpawlowski@signatureassociates.com

**JOHN DROZE**  
(248) 948 4191  
jdroze@signatureassociates.com

**SIGNATURE ASSOCIATES**  
One Towne Square, Suite 1200  
Southfield, MI 48076  
www.signatureassociates.com

# 2709 Bond Street, Unit B – Rochester Hills, Michigan Hi-Tech For Lease

9,903  
Square Feet  
AVAILABLE

## Site Plan

AVAILABILITY			
UNIT	TOTAL SF	OFFICE SF	RATE
Unit B	9,903	2,500	\$8.95

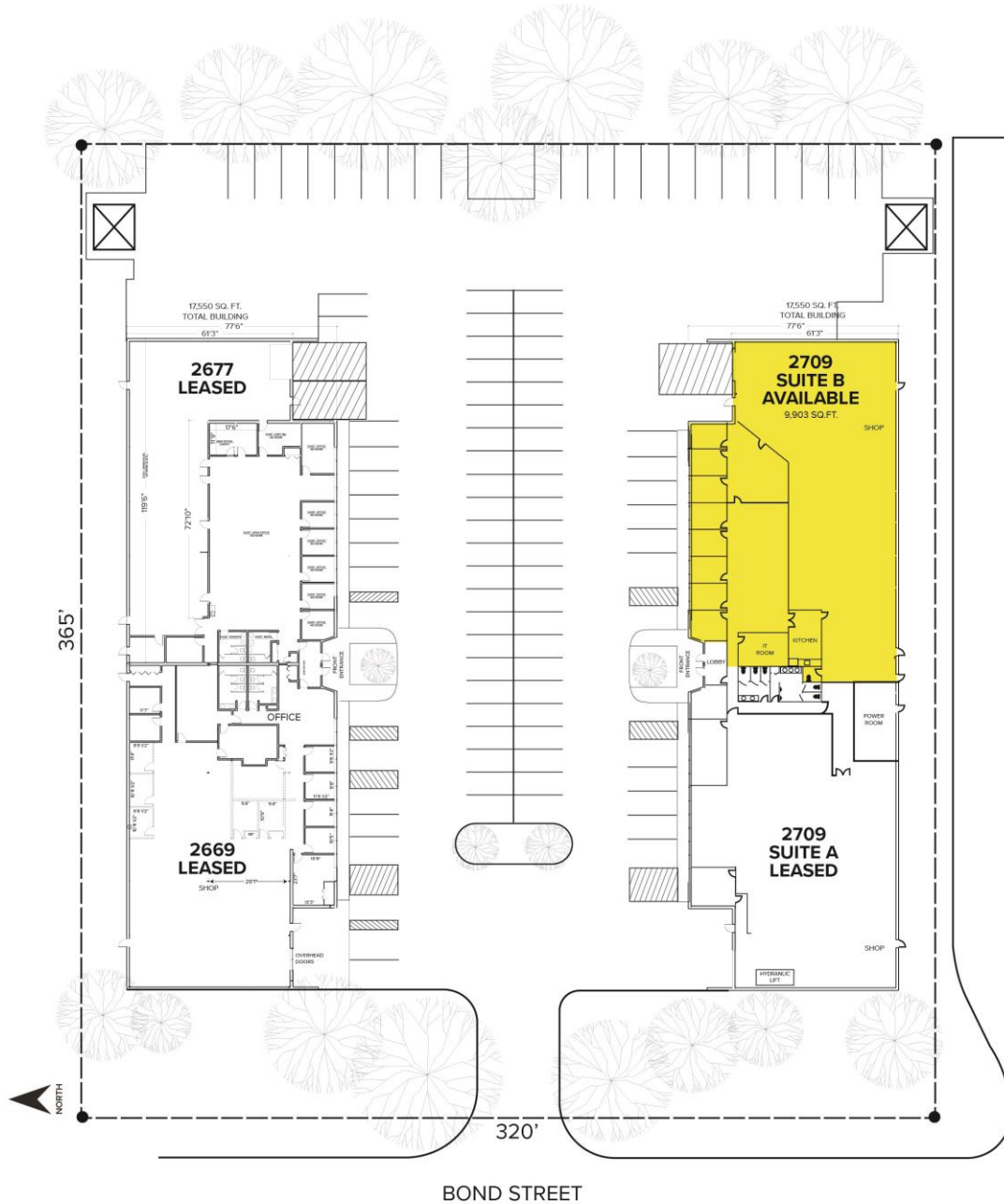

For more information, please contact:

**KRIS PAWLOWSKI**  
(248) 359 3801  
kpawlowski@signatureassociates.com

**JOHN DROZE**  
(248) 948 4191  
jdroze@signatureassociates.com

**SIGNATURE ASSOCIATES**  
One Towne Square, Suite 1200  
Southfield, MI 48076  
www.signatureassociates.com

# 2709 Bond Street, Unit B – Rochester Hills, Michigan Hi-Tech For Lease

9,903  
Square Feet  
AVAILABLE

## Floor Plan

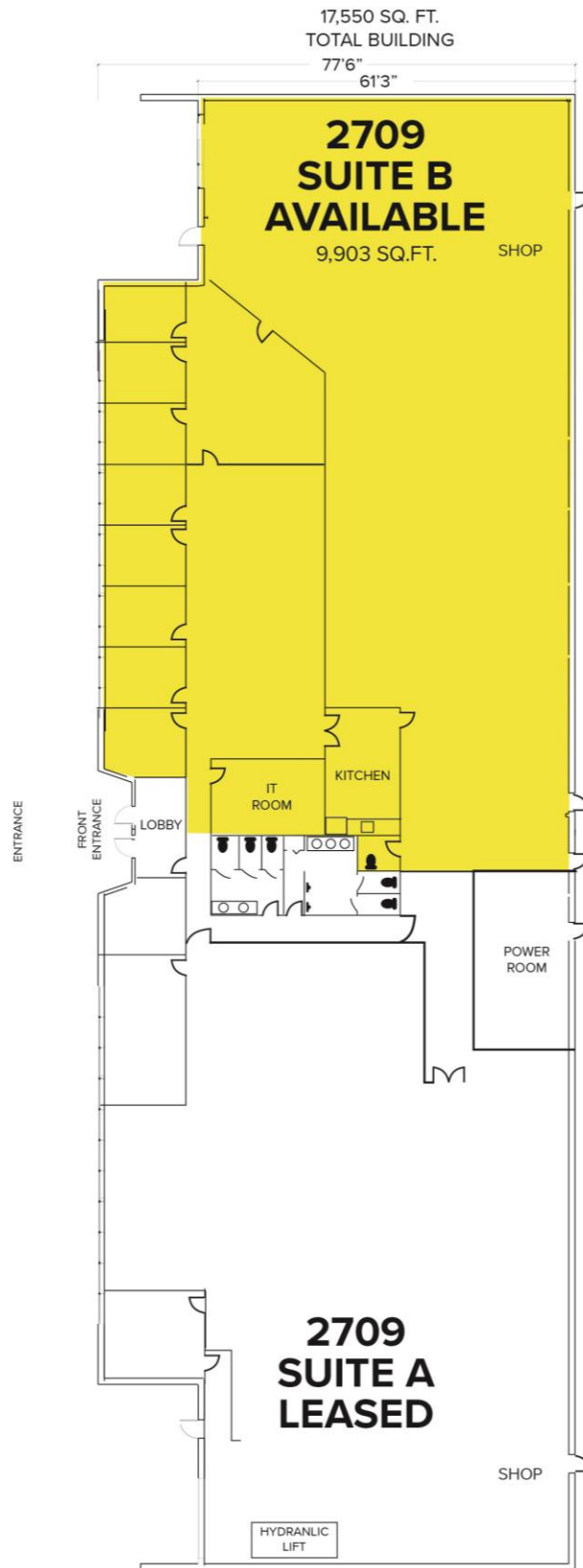

For more information, please contact:

**KRIS PAWLOWSKI**  
(248) 359 3801  
kpawlowski@signatureassociates.com

**JOHN DROZE**  
(248) 948 4191  
jdroze@signatureassociates.com

**SIGNATURE ASSOCIATES**  
One Towne Square, Suite 1200  
Southfield, MI 48076  
www.signatureassociates.com

# 2709 Bond Street, Unit B – Rochester Hills, Michigan

Hi-Tech For Lease

9,903  
Square Feet  
AVAILABLE

Aerial



For more information, please contact:

**KRIS PAWLOWSKI**  
(248) 359 3801  
kpawlowski@signatureassociates.com

**JOHN DROZE**  
(248) 948 4191  
jdroze@signatureassociates.com

**SIGNATURE ASSOCIATES**  
One Towne Square, Suite 1200  
Southfield, MI 48076  
www.signatureassociates.com

Information is subject to verification and no liability for errors or omissions is assumed. Price is subject to change and listing withdrawal.