



# 2203 PHILADELPHIA ROAD

EDGEWOOD, MARYLAND 21040

FOR  
SALE



**MACKENZIE**

COMMERCIAL REAL ESTATE SERVICES, LLC



# PROPERTY OVERVIEW

## HIGHLIGHTS:

- Great visibility along Philadelphia Road (12,454 AADT)
- Direct access to Philadelphia Road
- Potential for owner occupier opportunity
- Versatile use (office, contractor, medical, church)
- On site parking
- Option for a drive-in door to be installed



BUILDING SIZE:

4,420 SF ±

LOT SIZE:

0.30 ACRES ±

YEAR BUILT:

1964

PARKING:

2.27/1,000 SF

ZONING:

B1

SALE PRICE:

\$950,000



GOOGLE STREET VIEW



# INTERIOR PHOTOS





# SITE PLAN

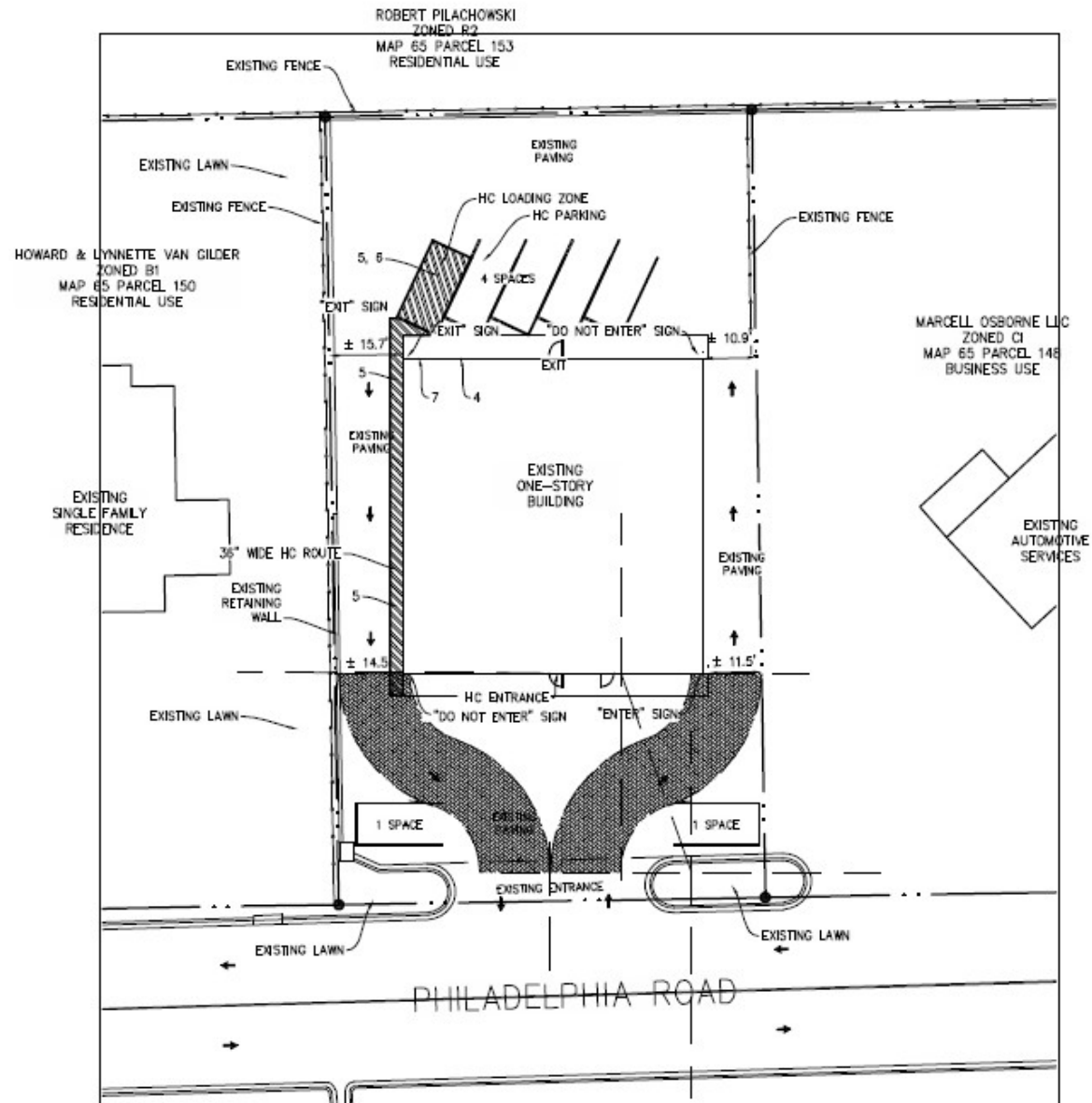



# MARKET AERIAL

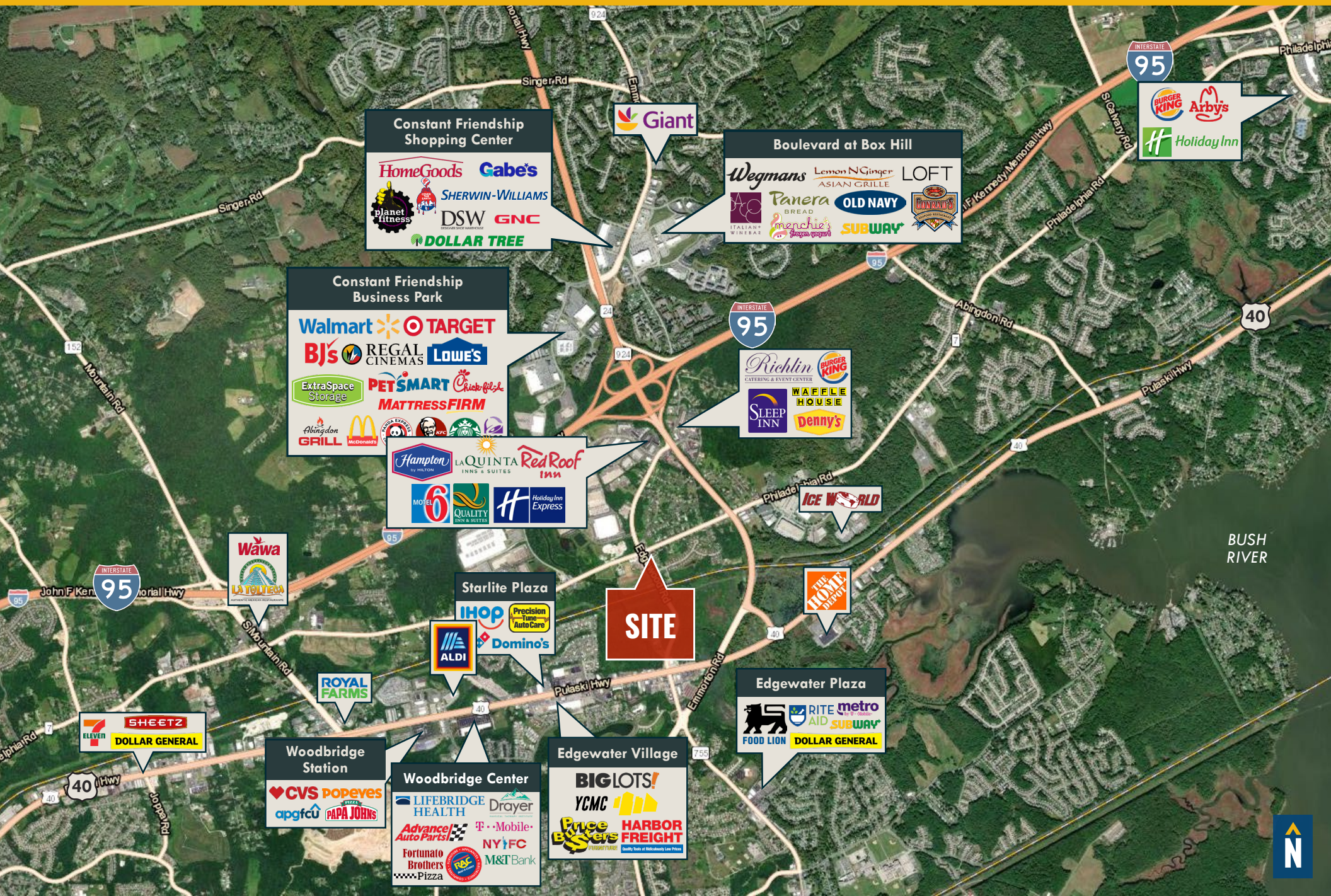



# DEMOGRAPHICS

2025

RADIUS:

1 MILE

3 MILES

5 MILES

## RESIDENTIAL POPULATION



3,003

58,267

103,480

## DAYTIME POPULATION



5,442

46,870

84,026

## AVERAGE HOUSEHOLD INCOME



\$82,110

\$113,541

\$123,162

## NUMBER OF HOUSEHOLDS



1,038

21,959

39,316

## MEDIAN AGE



37.2

37.6

39.3

FULL DEMOS REPORT





# FOR MORE INFO CONTACT:



## **TOM MOTTLEY**

*SENIOR VICE PRESIDENT & PRINCIPAL*

**443.573.3217**

**TMOTTLEY@mackenziecommercial.com**



## **BEETLE SMITH**

*SENIOR VICE PRESIDENT*

**443.573.3219**

**BSMITH@mackenziecommercial.com**



## **JOHN MICHAEL**

*REAL ESTATE ADVISOR*

**443.573.3207**

**JMICHAEL@mackenziecommercial.com**



VISIT **PROPERTY PAGE** FOR MORE INFORMATION.



# **MACKENZIE**

COMMERCIAL REAL ESTATE SERVICES, LLC

**410-879-1900**

**3465 Box Hill Corporate Center Drive, Suite F  
Abingdon, MD 21009**

OFFICES IN: ANNAPOLIS, MD BALTIMORE, MD **BEL AIR, MD** COLUMBIA, MD LUTHERVILLE, MD CHARLOTTESVILLE, VA

**www.MACKENZIECOMMERCIAL.com**

No warranty or representation, expressed or implied, is made as to the accuracy of the information contained herein, and same is submitted subject to errors, omissions, change of price, rental or other conditions, withdrawal without notice, and to any specific listing conditions imposed by our principals.