

For sublease

15,834 SF Available

6224 Lakeland Avenue N
Brooklyn Park, MN 55428



6224 Lakeland Avenue N, Brooklyn Park, MN

15,834 SF

Office/Warehouse space for lease

- 15,834 SF available (office/warehouse)
- Date available: 60 days after lease execution
- Sublease term: through 3/31/2027
- Rate: \$8.50 PSF Gross
- 19'8" clear height
- Gated truck court
- Two (2) docks (8' x 10") with bumpers and levelers
- Two (2) drive-ins (12' x 10")
- LED lighting
- 2.56/1,000 SF parking ratio



Floor plan

15,834 SF
available

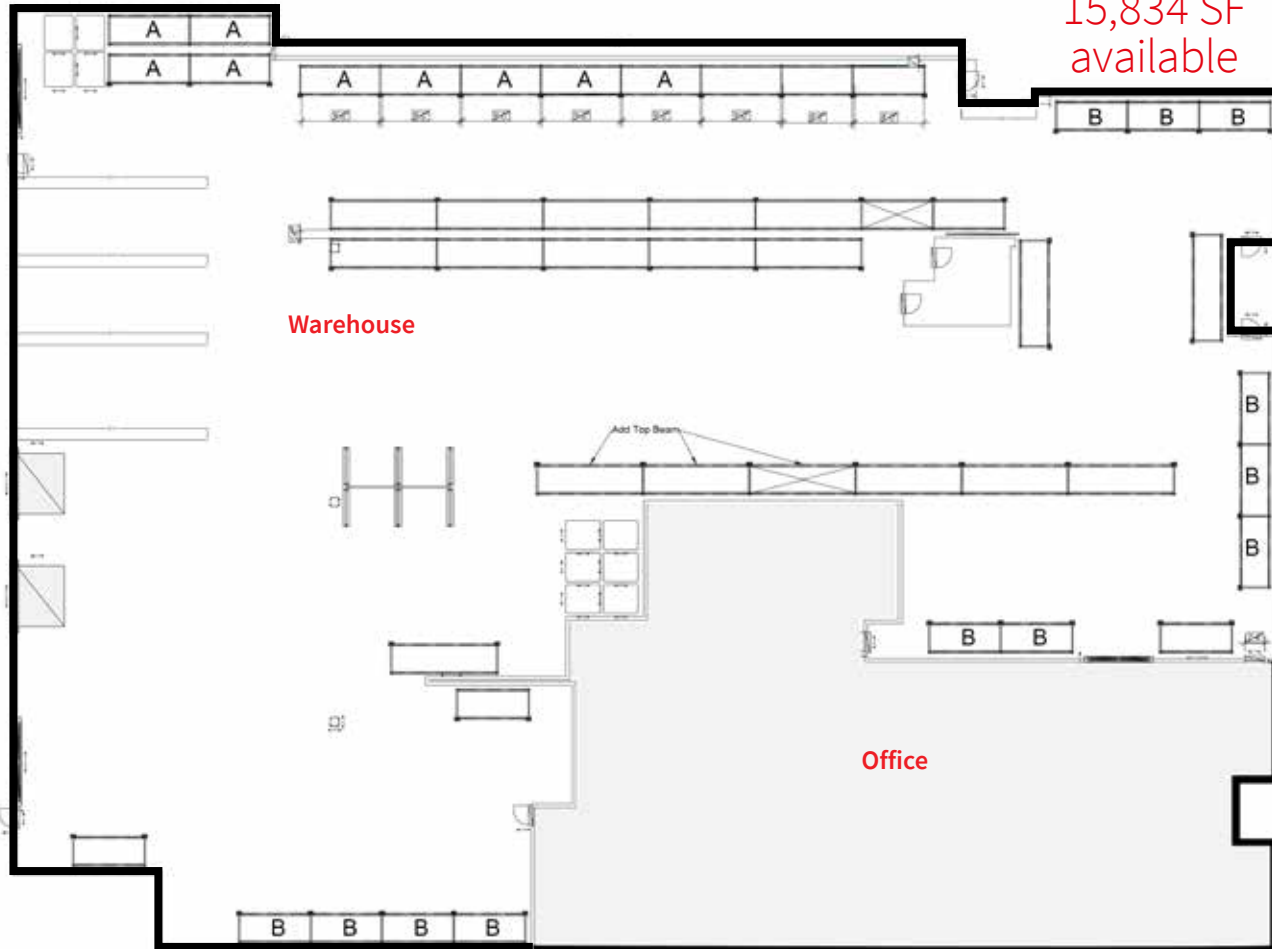

Prime access

**6224 Lakeland Avenue N
Brooklyn Park, MN 55428**

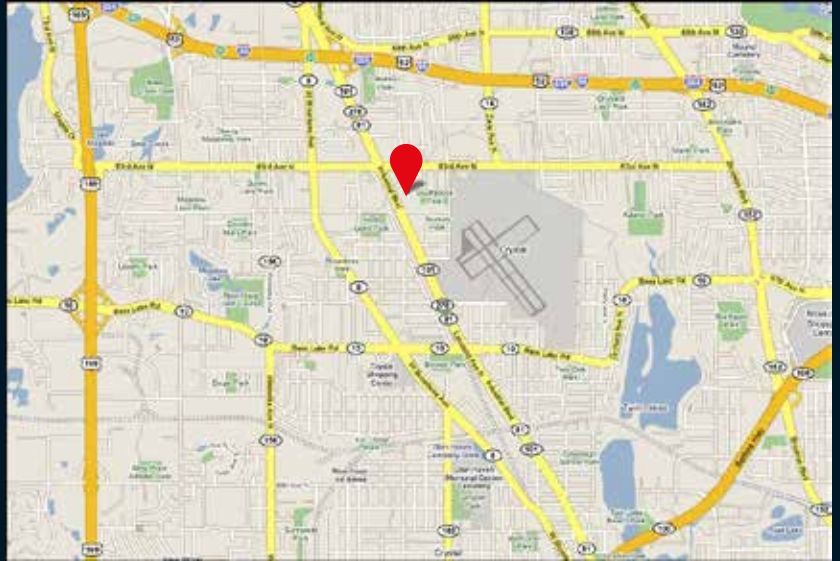

Kyle Rafshol

+1 612 217 6780

kyle.rafshol@jll.com

Dan Larew

+1 612 217 6726

dan.larew@jll.com

© 2024 Jones Lang LaSalle IP, Inc. All rights reserved.

Although information has been obtained from sources deemed reliable, neither Owner nor JLL makes any guarantees, warranties or representations, express or implied, as to the completeness or accuracy as to the information contained herein. Any projections, opinions, assumptions or estimates used are for example only. There may be differences between projected and actual results, and those differences may be material. The Property may be withdrawn without notice. Neither Owner nor JLL accepts any liability for any loss or damage suffered by any party resulting from reliance on this information. If the recipient of this information has signed a confidentiality agreement regarding this matter, this information is subject to the terms of that agreement.

©2024 Jones Lang LaSalle IP, Inc. All rights reserved.