

FOR SALE



160 N MILL - CRESWELL, OREGON 97426

COMMERCIAL/RETAIL BUILDING

- BUILDING SIZE: 2,400 SQUARE FEET
- LOT SIZE: 20,9000 SF
- BUILT IN 1973
- TWO (10'x12') GRADE-LEVEL DOORS
- 14 PARKING SPOTS
- CMU WITH 18' WALLS
- CRESWELL GENERAL COMMERCIAL ZONING

Purchase Price: **\$450,000**



For more information contact:

SUZANNE KINTZLEY
suzannek@campbellre.com
(541) 484-2214

Licensed in the State of Oregon

The information in this package was obtained from sources deemed reliable, and is not guaranteed by agent. Package is subject to change, error or omission, prior sale or lease, correction or withdrawal. Any party contemplating purchase is urged to conduct their own independent study and inspection.

BUILDING SITE PLAN

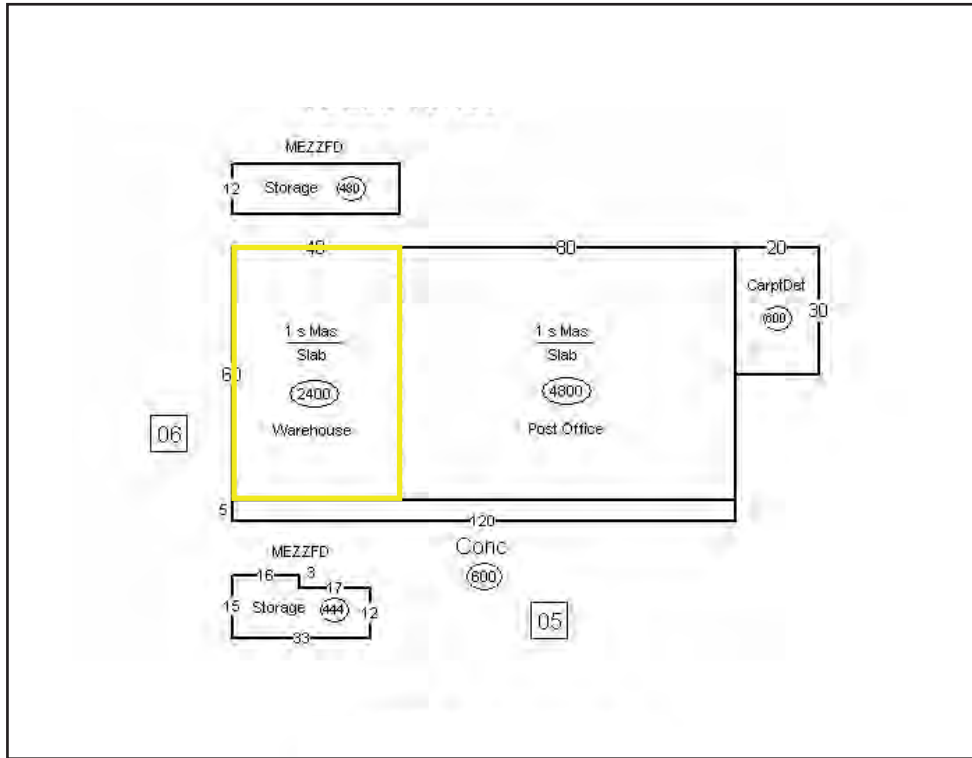

The information in this package was obtained from sources deemed reliable, and is not guaranteed by agent. Package is subject to change, error or omission, prior sale or lease, correction or withdrawal. Any party contemplating purchase is urged to conduct their own independent study and inspection.

PROPERTY LOCATION

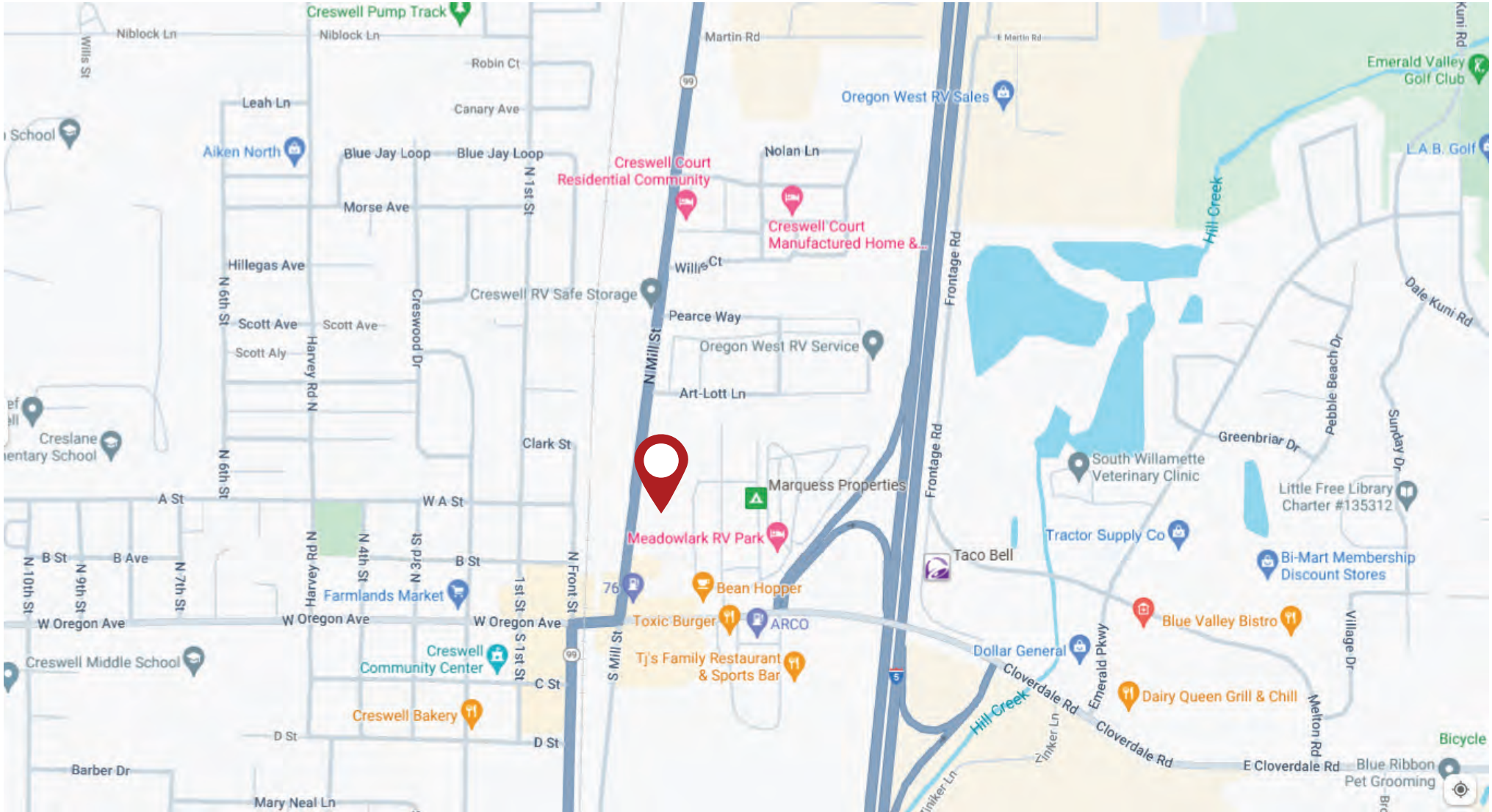

The information in this package was obtained from sources deemed reliable, and is not guaranteed by agent. Package is subject to change, error or omission, prior sale or lease, correction or withdrawal. Any party contemplating purchase is urged to conduct their own independent study and inspection.