

OFFICE/WAREHOUSE SPACE FOR SALE

I-430 & COLONEL GLENN | LITTLE ROCK, AR

Commercial
Realty LLC

New
Construction



Contact Us:

JACQUELINE BOYETTE

M: 501.519.4008 | D: 501.219.0919

jboyette@commercialrealtyllc.com

Commercial Realty, LLC

#1 Remington Drive, Suite 100

Little Rock, Arkansas 72204

501.219.0919

The statements, terms and conditions set forth in this advertisement are deemed reliable but not guaranteed and remain, at all times, subject to change by the property owner(s) without notice. The property owner(s) reserve the right, at its sole and absolute discretion to adjust the price and remove the property from the market at any time without notice. The property owner(s) reserves the right to reject any and all offers and transactions are subject to the execution of the definitive agreements. Commercial Realty, LLC makes no guarantees, representations or warranties regarding its accuracy.

Property Info

#9 Remington Drive | Little Rock, AR

Commercial
Realty LLC

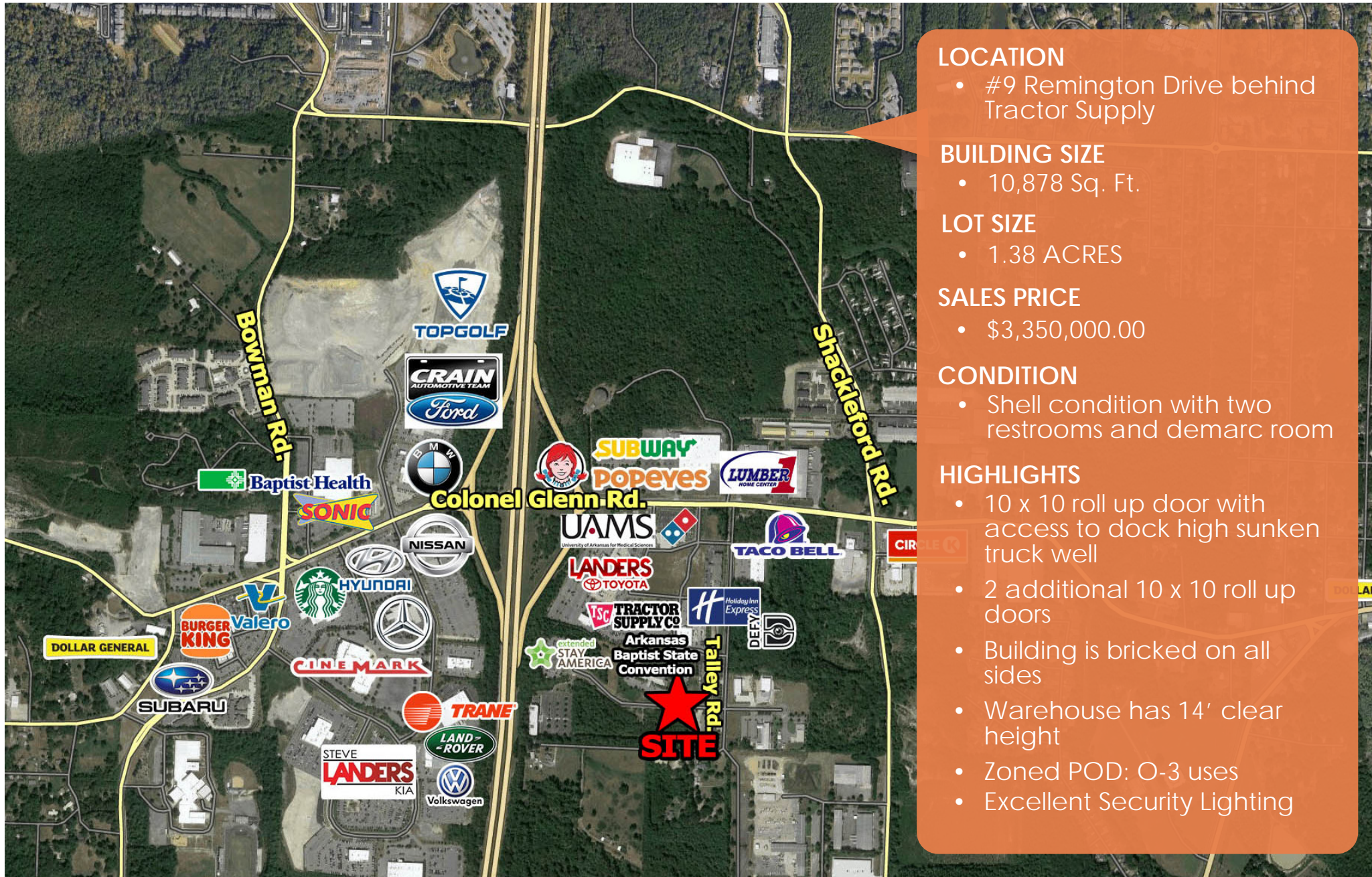

LOCATION

- #9 Remington Drive behind Tractor Supply

BUILDING SIZE

- 10,878 Sq. Ft.

LOT SIZE

- 1.38 ACRES

SALES PRICE

- \$3,350,000.00

CONDITION

- Shell condition with two restrooms and demarc room

HIGHLIGHTS

- 10 x 10 roll up door with access to dock high sunken truck well
- 2 additional 10 x 10 roll up doors
- Building is bricked on all sides
- Warehouse has 14' clear height
- Zoned POD: O-3 uses
- Excellent Security Lighting

Floor Plan

#9 Remington Drive | Little Rock, AR

Commercial
Realty LLC

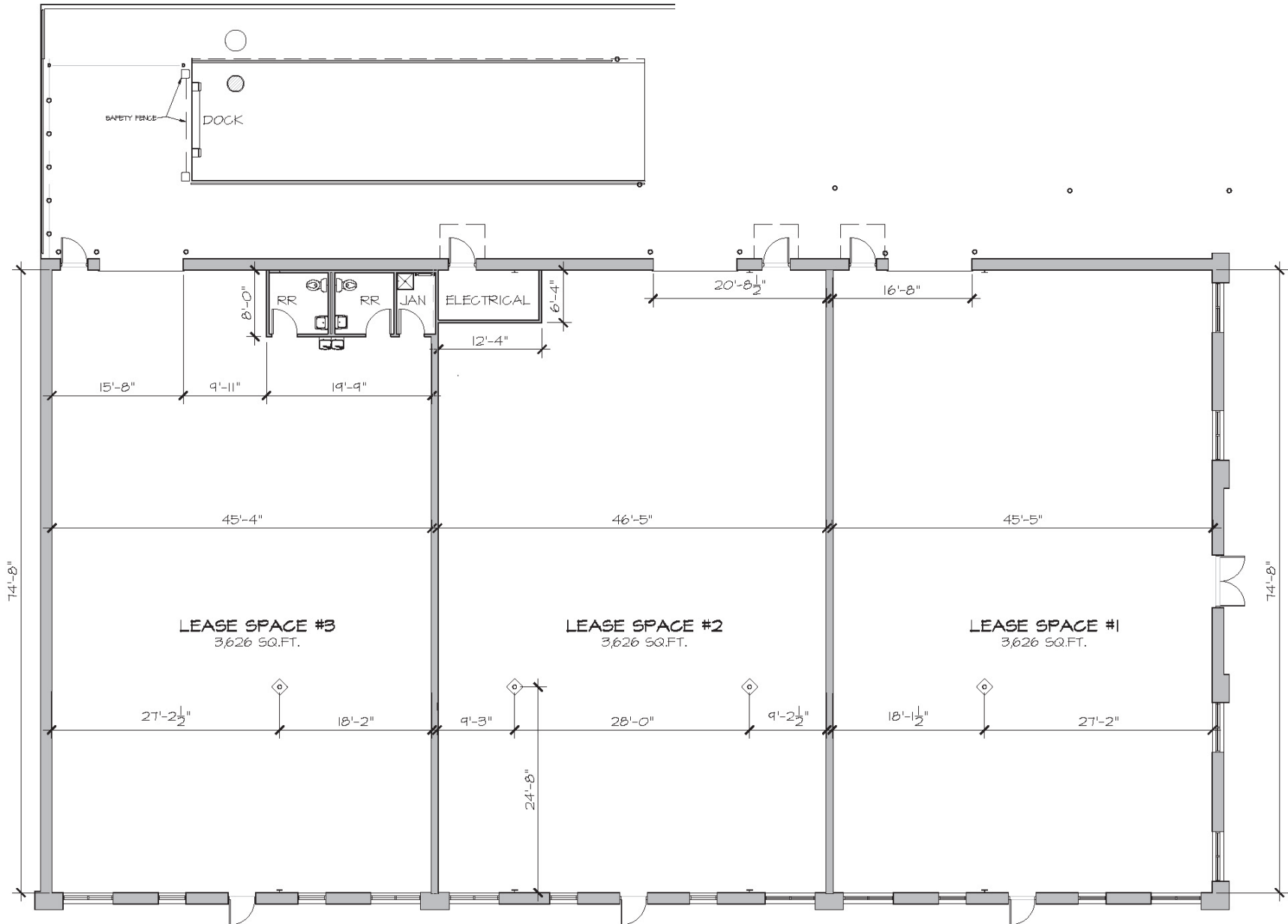

SITE PLAN

#9 Remington Drive | Little Rock, AR

Commercial
Realty LLC

