

For Lease or Sale
Owner Financing Available

EXCLUSIVELY MARKETED BY: **CBRE**



1120 Alza Dr, El Paso, Texas

CROSS-BORDER SPEC BUILDING — 38,272 SF

UNPARALLELED CONNECTIVITY AND MARKET ACCESSIBILITY

SITUATED FOR SUCCESS

1120 ALZA DR

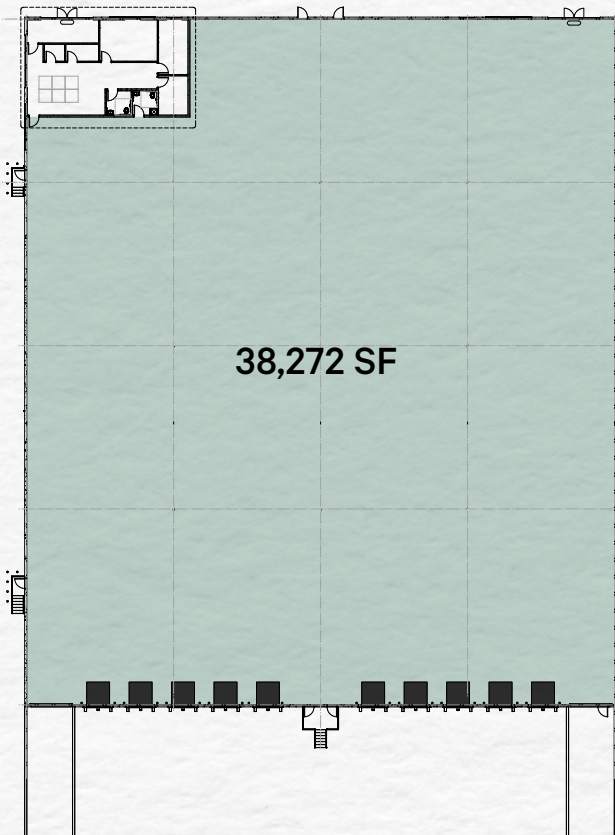

This Class "A", 38,272-square-foot industrial spec building offers an ideal location for cross-border logistics, warehousing, and distribution. Strategically positioned with convenient access to I-10, North Zaragoza Road, and the Loop 375/I-10 Interchange, the property's proximity to Mexico and the Zaragoza International Port of Entry makes it particularly attractive to businesses seeking to leverage US/Mexico trade.

Building Specifications

- + Clear Height: 28'
- + Dock Doors: 10
- + Ramps: 2
- + Truck Court: 181' x 213'
- + Parking: 34 Spaces
- + Office: 1,500 sq. ft.
- + Zoning: M1

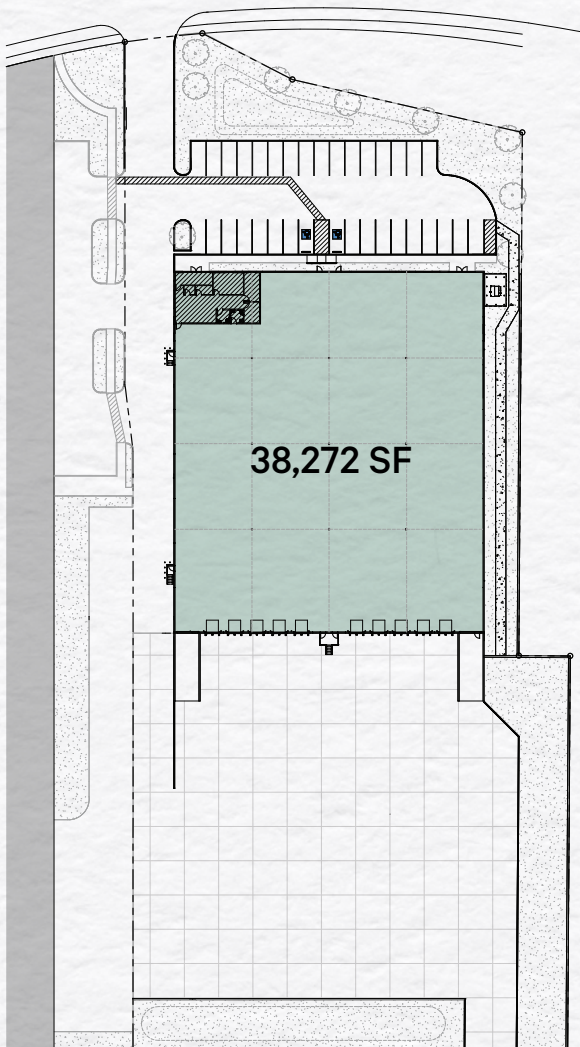

CD. JUÁREZ, MEXICO

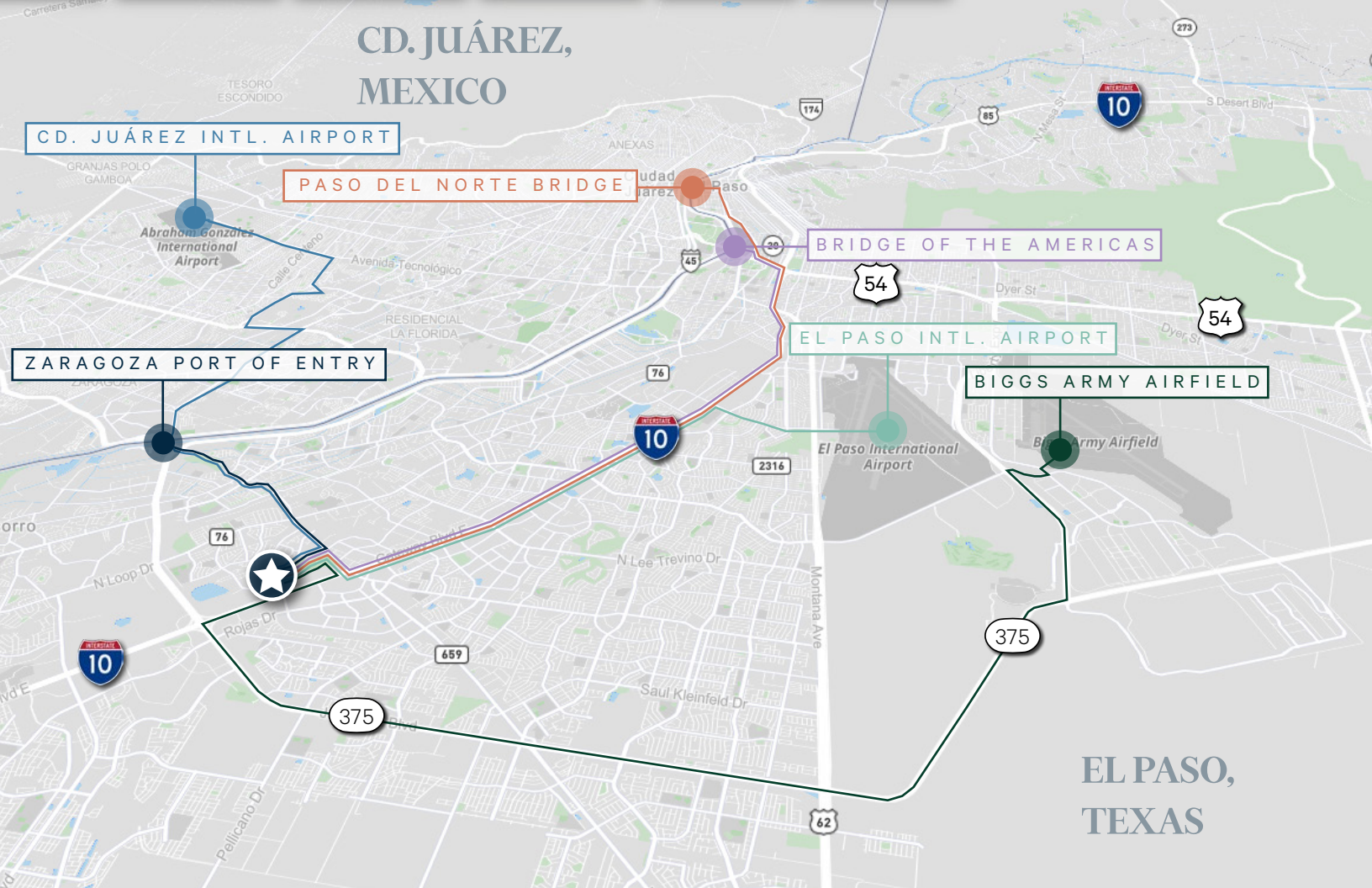

EFFICIENCY AND BORDER PROXIMITY 1120 ALZA DR

4.4 Miles
Zaragoza Port of Entry

12.8 Miles
Bridge of the Americas

15.1 Miles
Paso Del Norte Bridge

9.8 Miles
El Paso Intl. Airport

14.6 Miles
Cd. Juárez Intl. Airport

18.6 Miles
Biggs Army Airfield



For Lease or Sale
Owner Financing Available

EXCLUSIVELY MARKETED BY: **CBRE**



CONTACT US

Jacob Quinn

Executive Vice President

D: +1 915 313 8815

C: +1 915 269 6786

jacob.quinn@cbre.com

© 2026 CBRE, Inc. All rights reserved. This information has been obtained from sources believed reliable, but has not been verified for accuracy or completeness. You should conduct a careful, independent investigation of the property and verify all information. Any reliance on this information is solely at your own risk. CBRE and the CBRE logo are service marks of CBRE, Inc. All other marks displayed on this document are the property of their respective owners, and the use of such logos does not imply any affiliation with or endorsement of CBRE. Photos herein are the property of their respective owners. Use of these images without the express written consent of the owner is prohibited.