

OFFICE SPACE FOR SUBLEASE

# WATERMARK

4380 S MACADAM AVENUE, PORTLAND, OR 97239

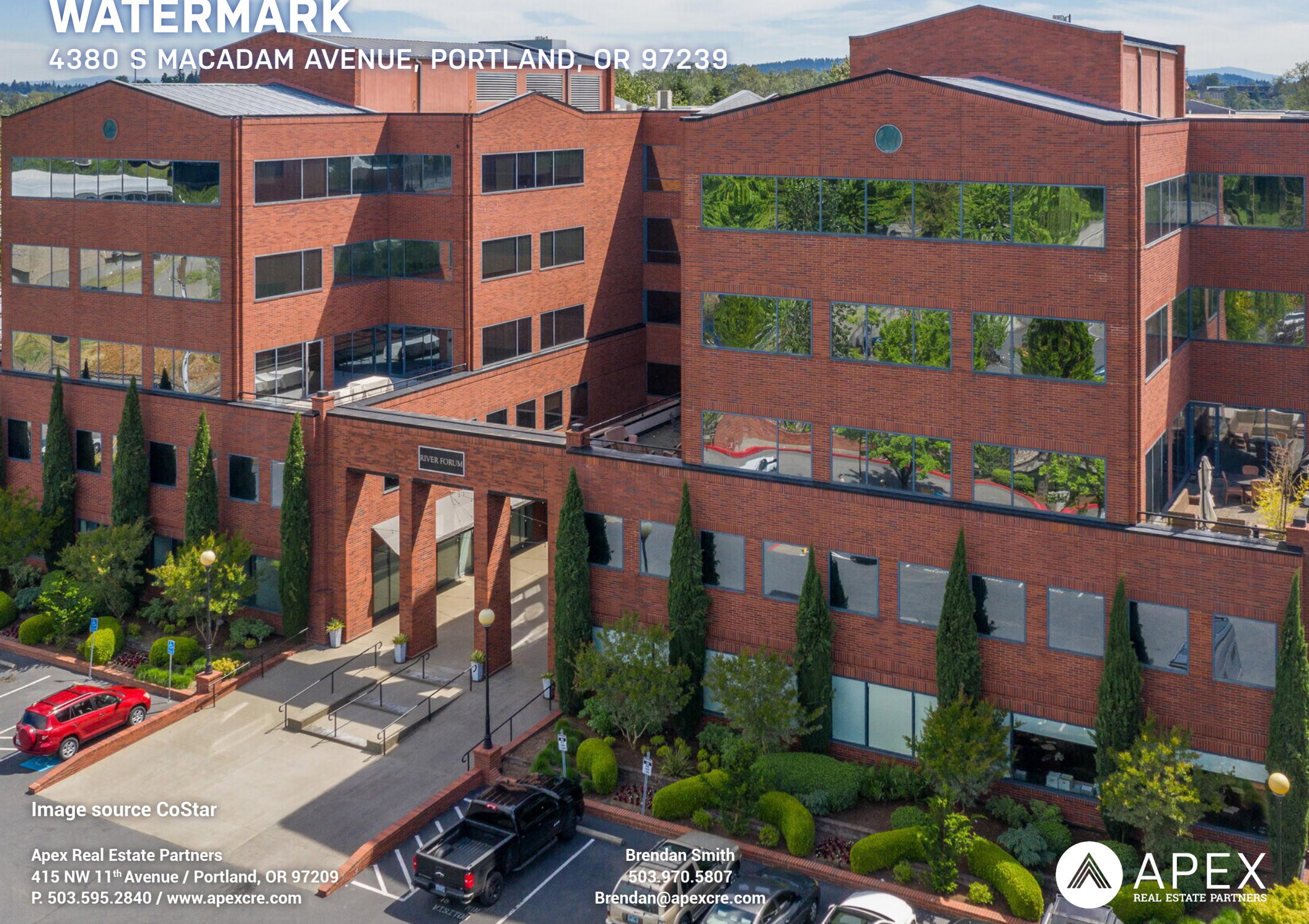

Image source CoStar

Apex Real Estate Partners  
415 NW 11<sup>th</sup> Avenue / Portland, OR 97209  
P. 503.595.2840 / [www.apexcre.com](http://www.apexcre.com)

Brendan Smith  
503.970.5807  
[Brendan@apexcre.com](mailto:Brendan@apexcre.com)



**APEX**  
REAL ESTATE PARTNERS



# MODERN OFFICE



Suite 150/185 ± 3,151 RSF



Asking rate \$36.00/RSF Full Service Gross



Move-in ready space with high-quality, turnkey build-out



Flexible layout with a large, open work area, conference room, and private offices



Bright breakroom with immediate access to the outdoor patio, courtyard, and seating area



Ample window lines and glass relites allow for abundant natural light throughout



The property offers on-site amenities including a fitness center, conference room, and lounge



Excellent public transportation access



Prime Johns Landing location, just steps from a variety of restaurants and retailers



Covered parking ± 3/1,000 SF



Sublease expires June 1, 2029



BREAKROOM



OPEN WORKSPACE



WORK ROOM

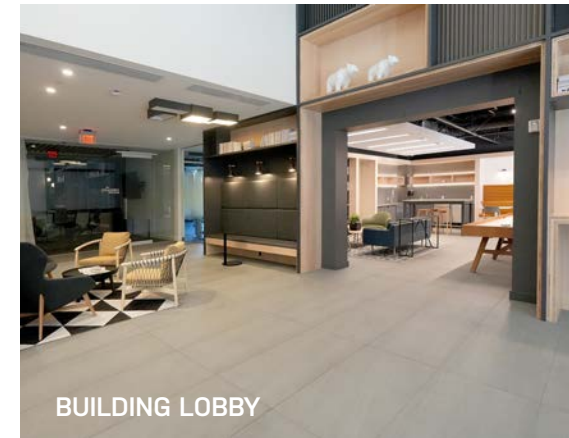

BUILDING LOBBY



OFFICE



OUTDOOR COURTYARD & LOUNGE AREA

# ± 3,151 RSF AVAILABLE

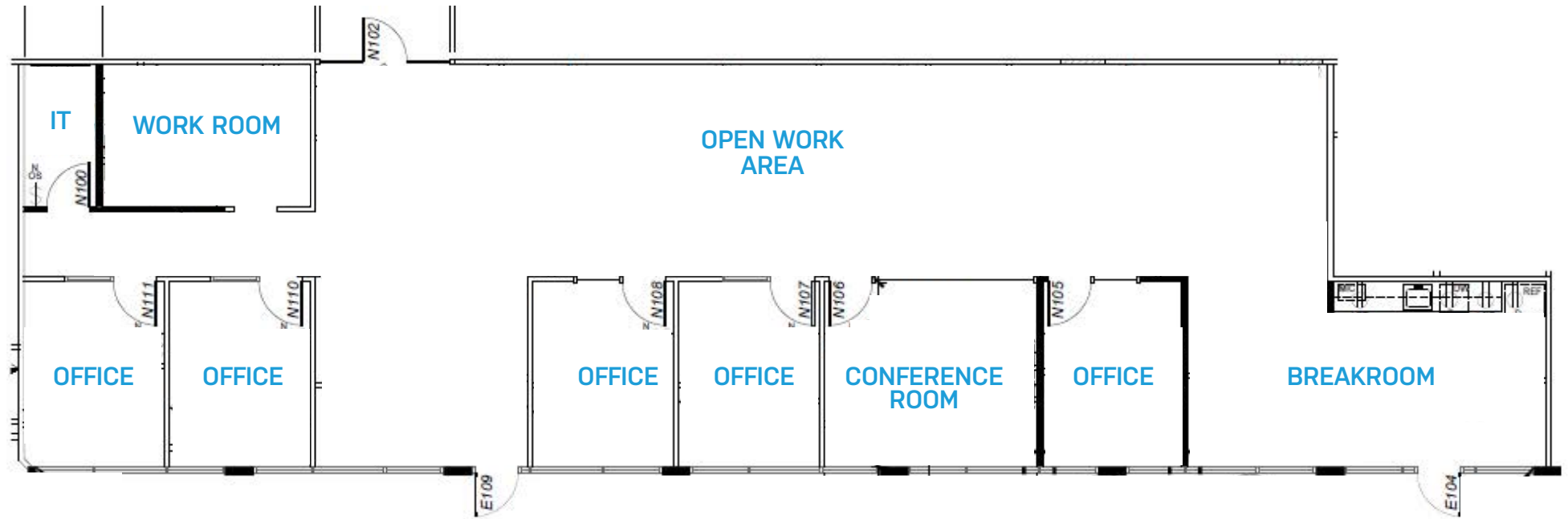



# CONVENIENT LOCATION



No warranty or representation, express or implied, is made as to the accuracy of the information contained herein, and same is submitted subject to errors, omissions, change of price, rental or other conditions, withdrawal without notice, and to any special listing condition imposed by our principals.