

23250 VAN BORN ROAD
DEARBORN HEIGHTS, MICHIGAN

RETAIL FOR LEASE
5,000 Square Feet Available



**SIGNATURE
ASSOCIATES**
KNOW SIGNATURE | KNOW RESULTS



PROPERTY FEATURES

- 29,476 total building square footage
- 5,000 available square feet
- Zoned C-3
- Over 150 asphalt parking spaces
- Built in 1956, Remodeled in 1997
- Signage available

Comments: Excellent opportunity to lease prime retail space along Van Born Road. Site has 155' of retail frontage and almost 19,000 cars passing by daily.

Major Tenants: O'Reilly Auto Parts and Family Dollar

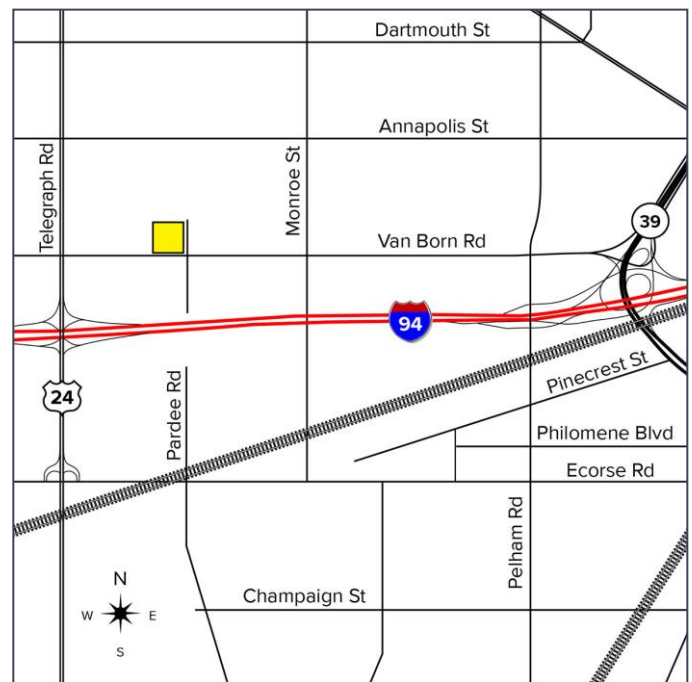

For more information, please contact:

JOE RIZQALLAH
(616) 822 6310
jrizzqallah@signatureassociates.com

JUSTIN GAFFREY
(734) 341 9950
jgaffrey@signatureassociates.com

SIGNATURE ASSOCIATES
1188 East Paris Ave SE, Suite 220
Grand Rapids, MI 49546
www.signatureassociates.com

23250 Van Born Road – Dearborn Heights, MI

Retail For Lease

5,000
Square Feet
AVAILABLE

Site Plan

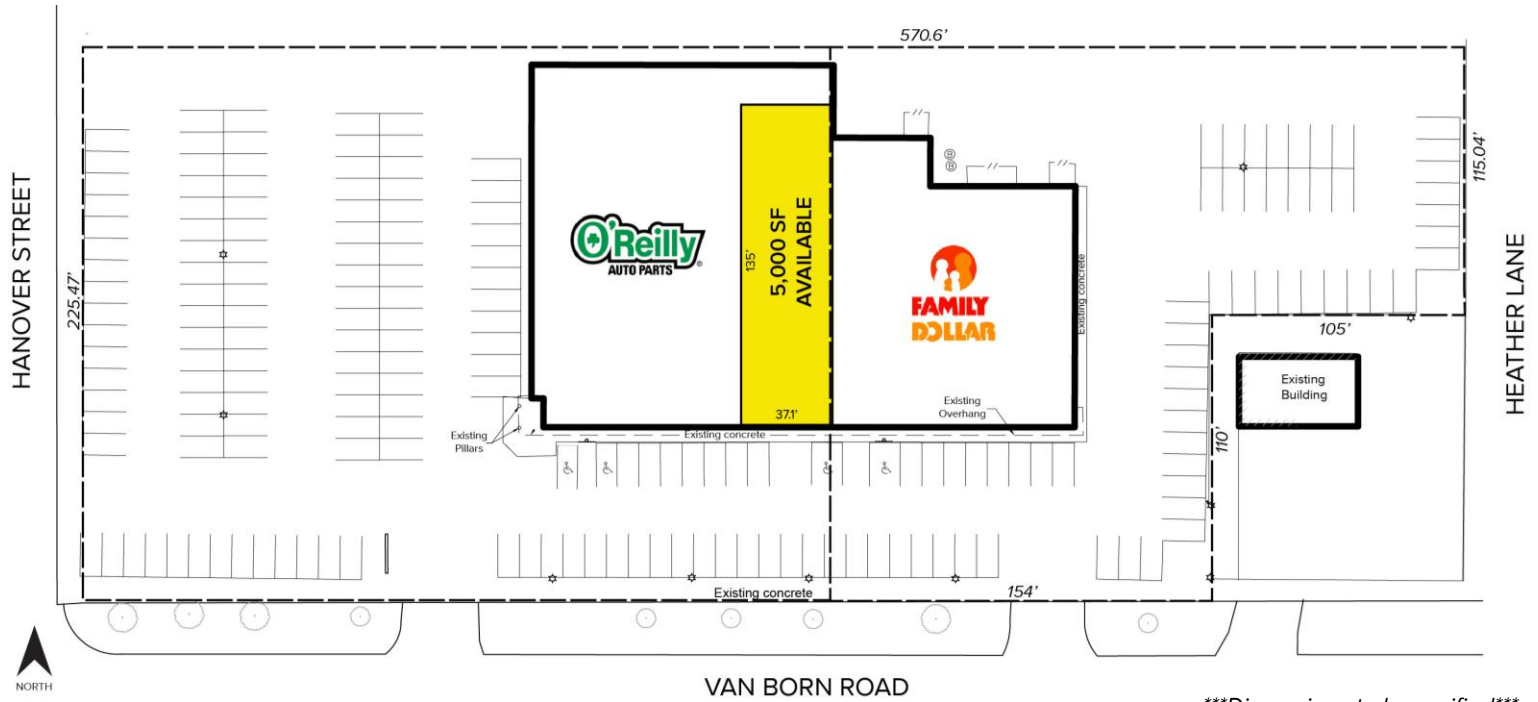

Dimensions to be verified

Additional Photos

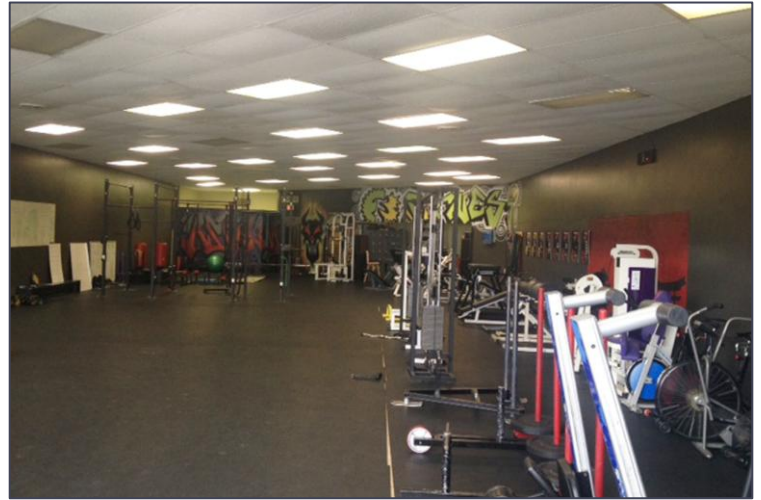

For more information, please contact:

JOE RIZQALLAH
(616) 822 6310
jrizqallah@signatureassociates.com

JUSTIN GAFFREY
(734) 341 9950
jgaffrey@signatureassociates.com

SIGNATURE ASSOCIATES
1188 East Paris Ave SE, Suite 220
Grand Rapids, MI 49546
www.signatureassociates.com

23250 Van Born Road – Dearborn Heights, MI

Retail For Lease

5,000
Square Feet
AVAILABLE

Aerial



DEMOGRAPHICS

	POPULATION	MED. HH INCOME
1 MILE	12,031	\$63,468
3 MILE	109,179	\$69,504
5 MILE	273,946	\$66,833

TRAFFIC COUNTS (TWO-WAY)

18,871	Van Born Rd east of Telegraph Rd
53,875	Telegraph Rd north of Van Born Rd
156,699	I-94 east of Telegraph Rd
58,057	Telegraph Rd south of I-94

For more information, please contact:

JOE RIZQALLAH

(616) 822 6310

jrizqallah@signatureassociates.com

JUSTIN GAFFREY

(734) 341 9950

jgaffrey@signatureassociates.com

SIGNATURE ASSOCIATES

1188 East Paris Ave SE, Suite 220

Grand Rapids, MI 49546

www.signatureassociates.com