



FOR LEASE

Industrial Building

632 Shelley Street
Springfield OR 97477

DETAILS

- Approximately 27,300 square feet
- Adjacent 19,000 square foot fenced yard (shared)
- Available January 1st, 2025
- Zoned LMI (Light Medium Industrial)
- 2 grade loading doors
- \$0.85 per square foot per month, modified gross

**Evans
Elder
Brown &
Seubert**

COMMERCIAL REAL ESTATE

CONTACT

Jeff Elder
jeff@eebcre.com

Ashley Hope Elder
ashley@eebcre.com

(541) 345-4860

Licensed in the State of Oregon.

Overview

632 Shelley Street, Springfield Oregon 97477

Evans
Elder
Brown &
Seubert

COMMERCIAL REAL ESTATE

CONTACT

Jeff
Elder

jeff@eebcre.com

Ashley
Hope
Elder

ashley@eebcre.com

(541) 345-4860

101 East Broadway
Suite #101
Eugene, OR 97401

Licensed in the
State of Oregon.

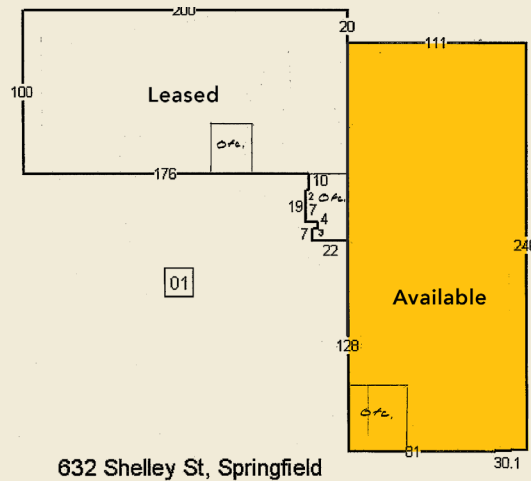

27,300 SF FOR LEASE

- Two (2) grade loading doors
- 400 amp power
- Ceilings 17' - 20' 8"

SITE

- Large parking area
- Adjacent fenced yard - approx. 19,000 sf



Photographs

632 Shelley Street, Springfield Oregon 97477

Evans
Elder
Brown &
Seubert

COMMERCIAL REAL ESTATE

CONTACT

**Jeff
Elder**

jeff@eebcre.com

**Ashley
Hope
Elder**

ashley@eebcre.com

(541) 345-4860

101 East Broadway
Suite #101
Eugene, OR 97401

Licensed in the
State of Oregon.



Location

632 Shelley Street, Springfield Oregon 97477

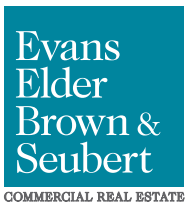

CONTACT

Jeff Elder
jeff@eebcre.com

(541) 345-4860

Ashley Hope Elder
ashley@eebcre.com

(541) 345-4860