

FOR LEASE
MEDICAL / OFFICE SPACE UP TO +/- 23,755 SF

OCEAN EAST MEDICAL CENTER

2300 SE OCEAN BLVD.
STUART, FL
34996



PROPERTY HIGHLIGHTS

- SUITE 14C: ±13,755 SF- 2ND GENERATION MEDICAL SPACE WITH MULTIPLE EXAM/PROCEDURE ROOMS
- SUITE 9 ±10,002 SF- BUILT OUT OFFICE SPACE
- BUILDING AND MARQUEE SIGNAGE AVAILABLE
- COVERED PATIENT PICK UP AND DROP OFF AREA
- AMPLE PARKING AT 4.50:1,000 SF
- CLOSE TO CLEVELAND CLINIC MARTIN NORTH HOSPITAL
- OTHER TENANTS INCLUDE: RADNET IMAGING CENTER, ALZHEIMER'S RESEARCH AND TREATMENT CENTER, THE FRESH MARKET, UPS, WALGREEN'S, AND STARBUCKS COFFEE (COMING SOON)



PROPER DESIGN AND FLOW OF SPACE



ENHANCED PATIENT EXPERIENCE



INTEGRATED HEALTHCARE DELIVERY

Suite 14C: Medical Space
+/- 13,755 SF

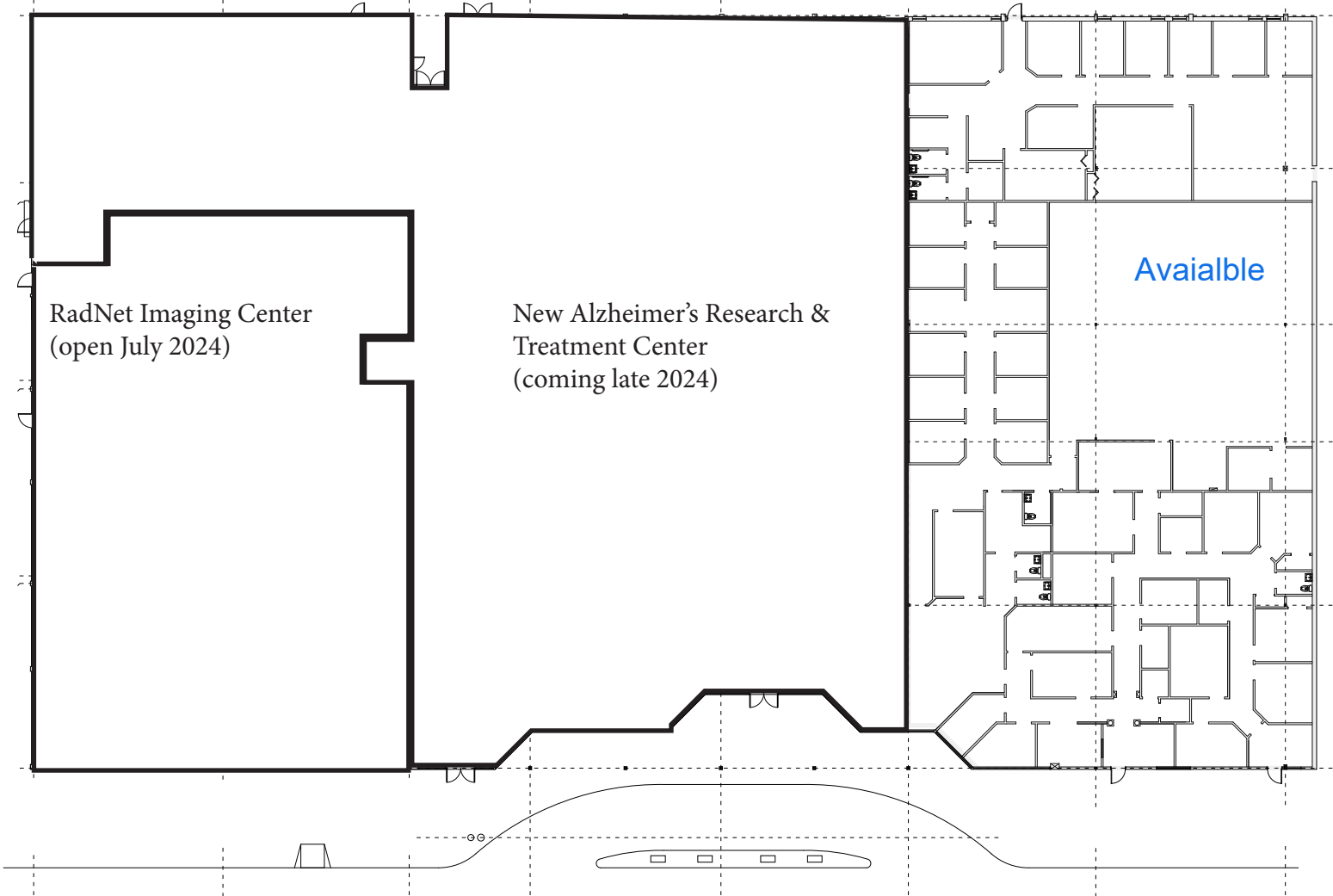

MEDICAL CENTERS TREASURE COAST

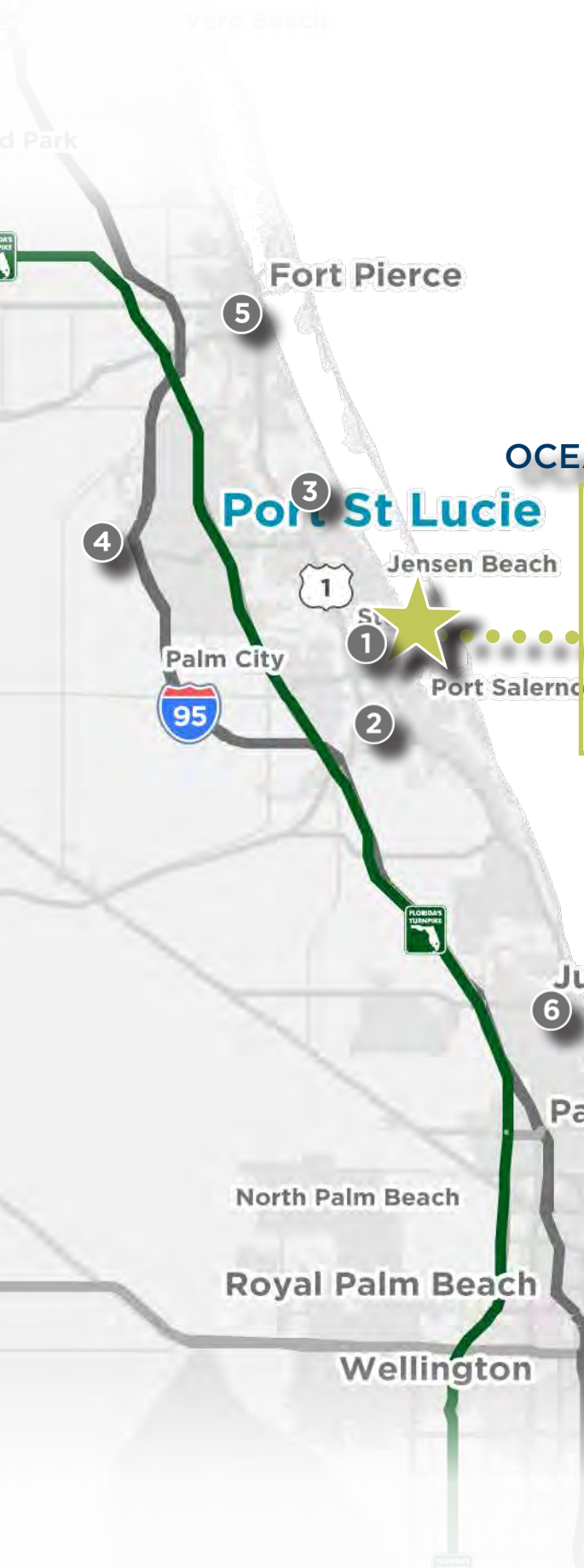

OCEAN EAST MEDICAL CENTER



Atlantic Ocean

NEARBY HOSPITALS

- 1 CLEVELAND CLINIC MARTIN NORTH HOSPITAL
- 2 CLEVELAND CLINIC MARTIN SOUTH HOSPITAL
- 3 HCA FLORIDA ST. LUCIE HOSPITAL
- 4 CLEVELAND CLINIC TRADITIONAL HOSPITAL
- 5 HCA FLORIDA LAWNWOOD HOSPITAL
- 6 JUPITER MEDICAL CENTER

CLEVELAND CLINIC MARTIN NORTH HOSPITAL



Cleveland Clinic Florida is a nonprofit, multi-specialty healthcare provider that integrates clinical and hospital care with research and education. The Florida region now includes Cleveland Clinic Indian River Hospital, Cleveland Clinic Martin Health, and Cleveland Clinic Weston Hospital, with five hospitals and numerous outpatient centers in Broward, Palm Beach, Martin, St. Lucie and Indian River Counties. Cleveland Clinic Florida is regionally and nationally ranked for its expertise and care. The Florida region is an integral part of Cleveland Clinic in Ohio, where providing outstanding patient care is based upon the principles of cooperation, compassion and innovation. Physicians at Cleveland Clinic are experts in the treatment of complex conditions that are difficult to diagnose.

HCA FLORIDA ST. LUCIE HOSPITAL



St. Lucie Medical Center is now HCA Florida St. Lucie Hospital. Our 207-bed hospital has been serving Florida's Treasure Coast community with quality care for more than 30 years. Our comprehensive healthcare facility offers a full range of services, including 24/7 emergency care in our senior-friendly emergency room (ER). We also provide a wide range of acute care services, including rehabilitation, obstetrics, inpatient and outpatient surgery and orthopedic care.

SITE PLAN



Suite	Tenant	Size (SF)	Suite	Tenant	Size (SF)	Suite	Tenant	Size (SF)
1	The Fresh Market	18,500 SF	5	The UPS Store	1,300 SF	11	Storage	1,129 SF
1B	Fresh Market Expansion	7,600 SF	6A	Ocean Foot Spa	1,502 SF	14A	Radiology/Imaging Associates	9,222 SF
1C	Dollar Tree	12,000 SF	6B	Apple Nails	1,512 SF	14B	Alzheimer Research	19,083 SF
1A	Available	2,025 SF	7,8, & 12	FMC Dialysis	9,360 SF	14C	Available	13,755 SF
2	Rocky's Subs	758 SF	9	Available	10,002 SF			
3-4	Rag Street	4,658 SF	10	Storage	767 SF			

THE CITY OF STUART | MARTIN COUNTY

YOUR COUNTY
YOUR COMMUNITY



OCEAN EAST MEDICAL CENTER

2300 SE OCEAN BLVD.
STUART, FL 34996

FOR MORE INFORMATION,

PLEASE CONTACT:

MICHAEL H. FELDMAN, CCIM

Senior Director

Florida Healthcare Advisory Practice
Commercial Brokerage

Direct: +1 561 227 2063

Mobile: +1 561 207 0852

Email: michael.feldman@cushwake.com

FLORIDA HEALTHCARE ADVISORY PRACTICE
PUTTING CLIENTS AT THE HEART OF OUR BUSINESS



©2023 Cushman & Wakefield. All rights reserved. The information contained in this communication is strictly confidential. This information has been obtained from sources believed to be reliable but has not been verified. NO WARRANTY OR REPRESENTATION, EXPRESS OR IMPLIED, IS MADE AS TO THE CONDITION OF THE PROPERTY (OR PROPERTIES) REFERENCED HEREIN OR AS TO THE ACCURACY OR COMPLETENESS OF THE INFORMATION CONTAINED HEREIN, AND SAME IS SUBMITTED SUBJECT TO ERRORS, OMISSIONS, CHANGE OF PRICE, RENTAL OR OTHER CONDITIONS, WITHDRAWAL WITHOUT NOTICE, AND TO ANY SPECIAL LISTING CONDITIONS IMPOSED BY THE PROPERTY OWNER(S). ANY PROJECTIONS, OPINIONS OR ESTIMATES ARE SUBJECT TO UNCERTAINTY AND DO NOT SIGNIFY CURRENT OR FUTURE PROPERTY PERFORMANCE.