



INDUSTRIAL FOR LEASE | TWO SPACES AVAILABLE

EASTPORT I

5600-5626 Eastport Blvd.
Richmond, Virginia 23231



CUSHMAN &
WAKEFIELD

THALHIMER

OWNED BY AN AFFILIATE OF
EQUUS
CAPITAL PARTNERS, LTD.

EASTPORT I

5600-5626 EASTPORT BLVD.



Property Features

EASTPORT is a 98-acre flex/warehouse/distribution park strategically located in Greater Richmond, Virginia near the intersection of Charles City Road and East Laburnum Avenue, close to the Richmond International Airport and just minutes to I-64, I-295 and I-95.

Eastport can accommodate space needs from 4,000 to 250,000 square feet with flexible spaces finished to meet your company's needs.

Building Size: 71,433 Total SF

Suite 5616- 5618 **11,686 SF**
3 docks & 1 drive-in
Available Now

Suite 5624 **4,460 SF**
1 dock
Available Now

Year Built: 1989

Zoning: M-2

Clear Height: 18'

Columns: 31'3" x 36'

Sprinkler: Wet

EASTPORT I

5600-5626 EASTPORT BLVD.



EASTPORT I

5600-5626 EASTPORT BLVD.

SITE PLAN

Suite 5616-5618
11,686 SF Available

Suite 5624
4,460 SF Available

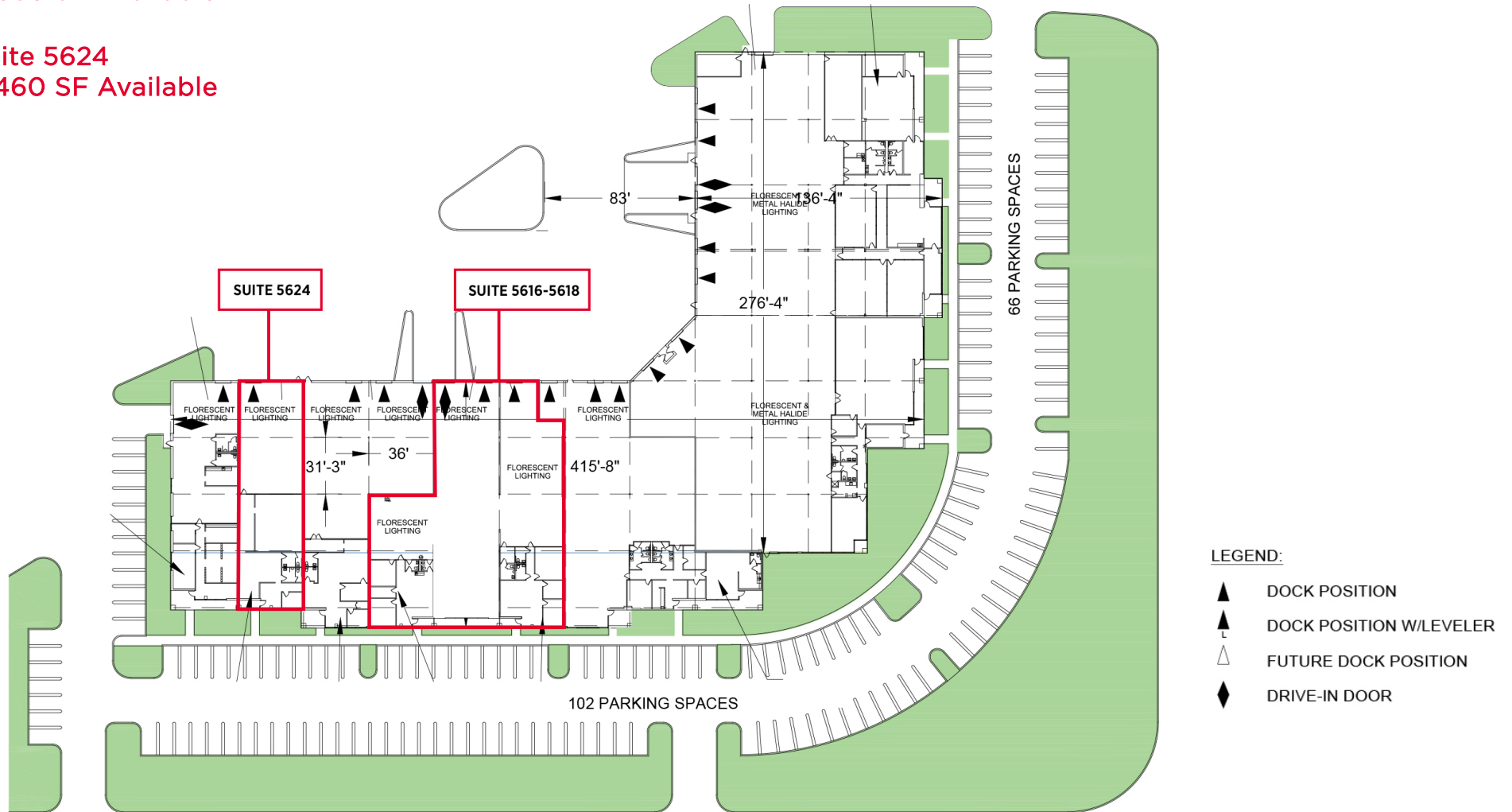

LEGEND:

- ▲ DOCK POSITION
- ▲_L DOCK POSITION W/LEVELER
- △ FUTURE DOCK POSITION
- ◆ DRIVE-IN DOOR

EASTPORT I

5600-5626 EASTPORT BLVD.





FOR MORE INFORMATION, CONTACT:

GRAHAM STONEBURNER, SIOR
Senior Vice President
804 344 7159
graham.stoneburner@thalhimer.com

DANNY HOLLY
Senior Vice President
804 697 3489
danny.holly@thalhimer.com

Thalhimer Center
11100 W. Broad Street
Glen Allen, VA 23060
thalhimer.com

Independently Owned and Operated / A Member of the Cushman & Wakefield Alliance

Cushman & Wakefield | Thalhimer © 2025. No warranty or representation, express or implied, is made to the accuracy or completeness of the information contained herein, and same is submitted subject to errors, omissions, change of price, rental or other conditions, withdrawal without notice, and to any special listing conditions imposed by the property owner(s). As applicable, we make no representation as to the condition of the property (or properties) in question.

