



GREAT FLEX SPACE IN MEDICAL BUSINESS PARK. 2669SF ONE LEVEL. EASY PARKING & ACCESS. JUST OFF HWY 20!

**1143 Warwick Way
Village of Mount Pleasant
Wisconsin 53406**

**MLS #: 1849392
Price: \$16**

DESCRIPTION

2669 SF in a stairless building, with great parking and easy access in and out. This is a Medical/Office complex with 5 stand-alone buildings and long-term national medical tenants including DaVita Dialysis, Aurora Health Center, Concentra Urgent Care and Cornerstone Counseling. Open design with warehouse/storage. Space can be converted to office/medical/flex use. Modified Gross Lease. Tenant will pay gas, electric and internet. Cannot be divided.

PROPERTY FEATURES

Property Type: Comm/Industrial

Taxes: \$49,846 / 2022

Business Name:

Year Established:

Est. Total Sq. Ft: 2,669

Avg Ceiling Height: 8'-10'

Truck Door Height: No Truck Door

Est. Year Built: 2000

Parking: 75

Lease Amount: \$

Lease Expiration:

Avg Rent/Sq. Ft: \$18

Expenses Include: None

Scheduled Gross Income: \$0

Gross Operating Income: \$0

Total Operating Exp: \$0

Net Operating Income: \$0

DIRECTIONS

Hwy 20 to Warwick Way north to property

CONTACT INFORMATION

Karmen J Johnson
Berkshire Hathaway Home Services Epic Real Estate

Phone: 262-620-9740

Cell: 262-620-9740

Fax:

Email: karmen@karmenjohnson.com

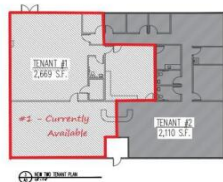

The information contained herein is provided for general information purposes only. If any of the above information is material or being utilized to determine whether to purchase the property, the buyer should personally verify same or have it confirmed by a qualified expert. The information to independently verify and confirm includes but is not limited to total square footage formula, total square footage / acreage figures, land, building or room dimensions and all other measurements of any sort of type. Equal housing opportunity listing. Copyright 2024 by Multiple Listing Service, Inc. See [copyright notice](#).

Prepared by Karmen J Johnson on Wednesday, March 20, 2024 10:26 AM.