

BUILD-TO-SUIT OPPORTUNITY

# SOCIAL CIRCLE DC

East Hightower Trail | Social Circle, Georgia 30025



**1,223,040 SF cross-dock distribution warehouse build-to-suit able to accommodate large-scale operations**

- 40' clear height
- 258 dock-high doors
- High-efficiency T5 lighting throughout the facility
- Ample parking with 614 car spaces and dedicated trailer parking for 532 trailers
- ESFR sprinkler system featuring K-25 heads
- Generous truck court with a spacious 185' deep court and 60' concrete apron
- Strategic location benefiting from convenient access to I-20 (exits 98 and 101) for efficient distribution across the region

 **TRANSWESTERN**<sup>®</sup>

JULIAN BROWN | 404.281.8893 | [julian.brown@transwestern.com](mailto:julian.brown@transwestern.com)

**Ackerman & Co.**

BRETT BUCKNER | 770-913-3923 | [bbuckner@ackermanco.net](mailto:bbuckner@ackermanco.net)

# Social Circle DC

Industrial Warehouse for Lease – 1,223,040 SF

East Hightower Trail  
Social Circle, Georgia, 30025

## BUILDING SPECIFICATIONS

Parcels numbers:	SC230-011, SC230-012, SC230-013
Building Type:	Cross-dock distribution warehouse
Building Size:	1,223,040 SF
Available Space:	1,223,040 SF
Office:	Build-to-suit
Clear Height:	40'
Column Spacing:	52' x 50' bays
Dock(s):	258 dock high doors
Building Depth:	520'
Building Length:	1924'
Floor Slab:	7" reinforced concrete
Fire Sprinkler:	ESFR
Lighting System:	T5 high efficiency
Auto Parking:	614 spaces
Trailer Parking:	532 spaces
Truck Court(s):	185' deep, 60' concrete apron
Roof:	R25; 60 mil white TPO, 20-year warranty, 98 Skylights; LED warehouse lights; clerestory windows
Exterior Construction:	Tilt-up exterior concrete wall construction



**JULIAN BROWN**

404-281-8893 | julian.brown@transwestern.com



**BRETT BUCKNER**

770-913-3923 | bbuckner@ackermanco.net

[www.ackermanco.com](http://www.ackermanco.com)

©2024 Ackerman & Co. All rights reserved. While we have no reason to doubt the accuracy of the information provided from sources we deem reliable, we cannot guarantee it and therefore assume no liability for errors, omissions or changes to this content.



# Social Circle DC

Industrial Warehouse for Lease – 1,223,040 SF

East Hightower Trail  
Social Circle, Georgia, 30025

## AERIAL MAP



### STRATEGIC LOCATION

Truck Transit Time from Atlanta to Anywhere in U.S.

#### MAJOR PORT CITIES

Gainesville Station.....	50 MILES
Inland Port Greer.....	150 MILES
Savannah.....	218 MILES
Brunswick.....	275 MILES
Charleston.....	260 MILES
Jacksonville.....	340 MILES

#### MAJOR RAIL YARDS

CSX Hulsey.....	50 MILES
CSX Fairburn.....	65 MILES
Norfolk Southern Inman.....	55 MILES
Norfolk Southern Austell.....	64 MILES

#### MAJOR AIRPORTS

Hartsfield-Jackson International..	55 MILES
------------------------------------	----------



**JULIAN BROWN**  
404-281-8893 | julian.brown@transwestern.com



**BRETT BUCKNER**  
770-913-3923 | b buckner@ackermanco.net

[www.ackermanco.com](http://www.ackermanco.com)

©2024 Ackerman & Co. All rights reserved. While we have no reason to doubt the accuracy of the information provided from sources we deem reliable, we cannot guarantee it and therefore assume no liability for errors, omissions or changes to this content.



# Social Circle DC

Industrial Warehouse for Lease – 1,223,040 SF

East Hightower Trail  
Social Circle, Georgia, 30025

## SITE PLAN

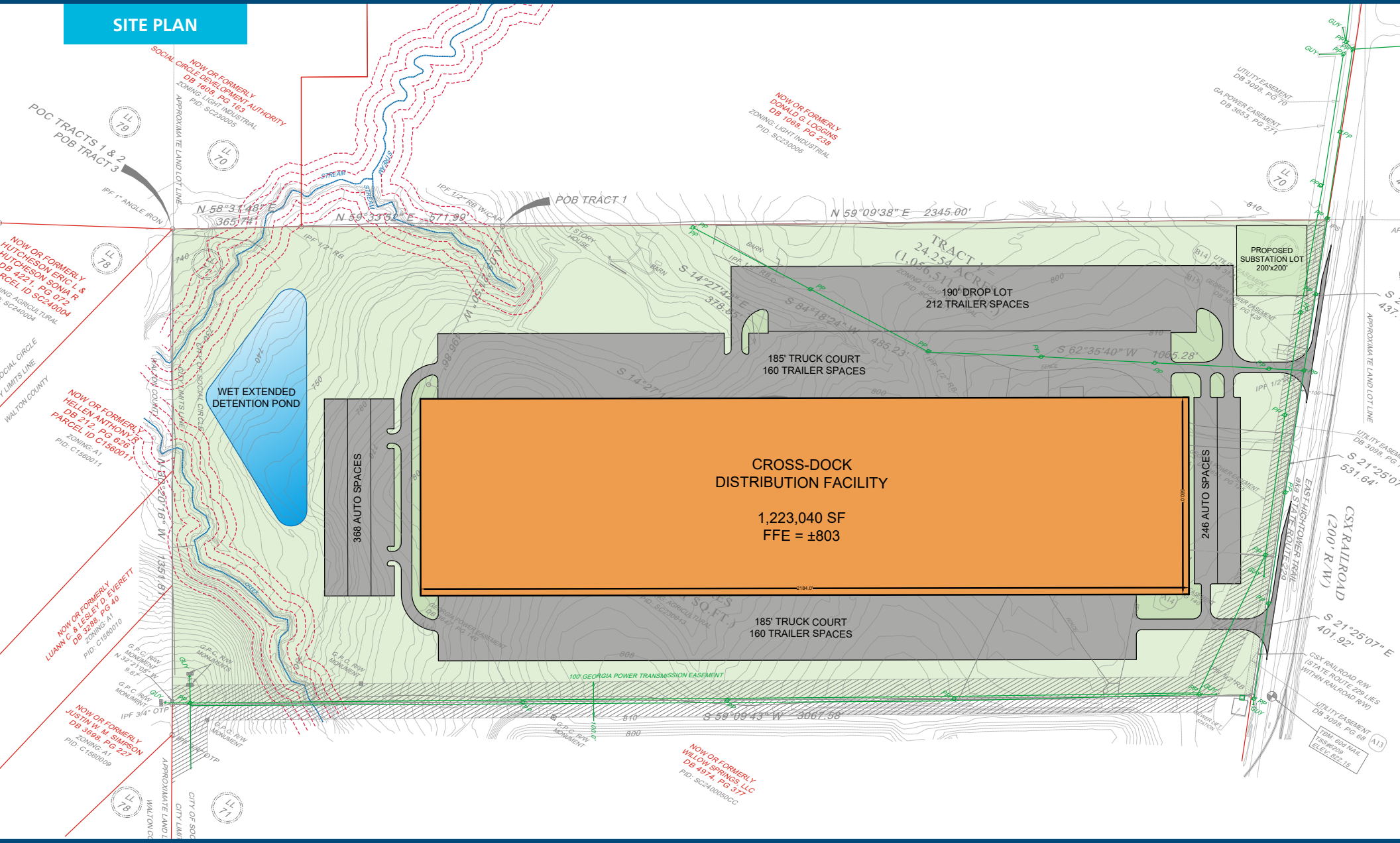

JULIAN BROWN

404-281-8893 | julian.brown@transwestern.com



BRETT BUCKNER

770-913-3923 | bbuckner@ackermanco.net

[www.ackermanco.com](http://www.ackermanco.com)

©2024 Ackerman & Co. All rights reserved. While we have no reason to doubt the accuracy of the information provided from sources we deem reliable, we cannot guarantee it and therefore assume no liability for errors, omissions or changes to this content.