

FOR LEASE

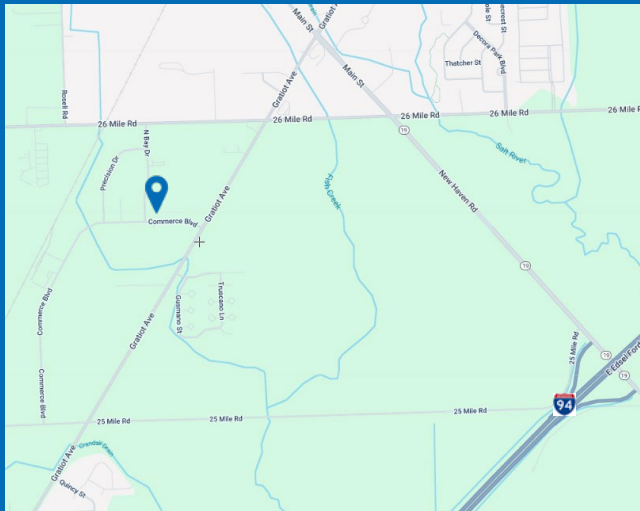

# 30455 Commerce Blvd

Chesterfield Township, MI 48051



## Property Highlights

- 21,280 square feet
- 3,136 square foot office
- 21' clear
- 2 overhead doors
- 1 truckwell

For information, please contact:

**Bob Pagano**

Senior Managing Director

t 248-357-6576

bob.pagano@nmrk.com

39400 Woodward Ave., Suite 100  
Bloomfield Hills, MI 48304



nmrk.com

# NEWMARK

Licensed in Michigan as Newmark Real Estate

The information contained herein has been obtained from sources deemed reliable but has not been verified and no guarantee, warranty or representation, either express or implied, is made with respect to such information. Terms of sale or lease and availability are subject to change or withdrawal without notice.

## INDUSTRIAL – Lease

30455 Commerce Blvd.  
Chesterfield Township, MI 48051



Total Building Size:	21,280
Total Available:	21,280
Age:	1994
Factory:	18,144
Office:	3,136
Minimum Divisible:	21,280
Zoned:	Light Manufacturing

<b>Lease Rate:</b>	<b>\$7.50/SF NNN</b>
<b>Monthly Rate:</b>	<b>\$13,300</b>
<b>Taxes:</b>	<b>\$51,604.22 (2024)</b> <b>(\$2.43/SF)</b>

## Property Details

Acreage:	2.2	Power:	
Frontage:	240'	Buss:	No
Depth:	400'	Lights:	T-5
Parking:	50+	Truckwell:	1
Expandable:	Possible	Grade Door:	(2) 12' x 14'
Storage:		Heating:	Radiant Tube
Clearance:	21'	A/C:	Office
Bay Size:	55'	Sprinklered:	Yes
Lavatories:	(2) Office; (4) Shop	Airlines:	Yes
Crane:	Prepped	Compressor:	No
Underhook:		Floordrains:	Yes, Near Office

## Additional Information:

Versatile industrial facility ideally suited for both distribution and manufacturing operations. Excellent truck access, including full drive-around capability for efficient vehicle circulation. Conveniently located just minutes from I-94. Newly paved roads throughout the industrial park.

## Contact Information:

**Bob Pagano**

**248-357-6576**

**bob.pagano@nmrk.com**

# NEWMARK





SHOP OFFICE IS NOT  
PART OF OFFICE SQ. FT.

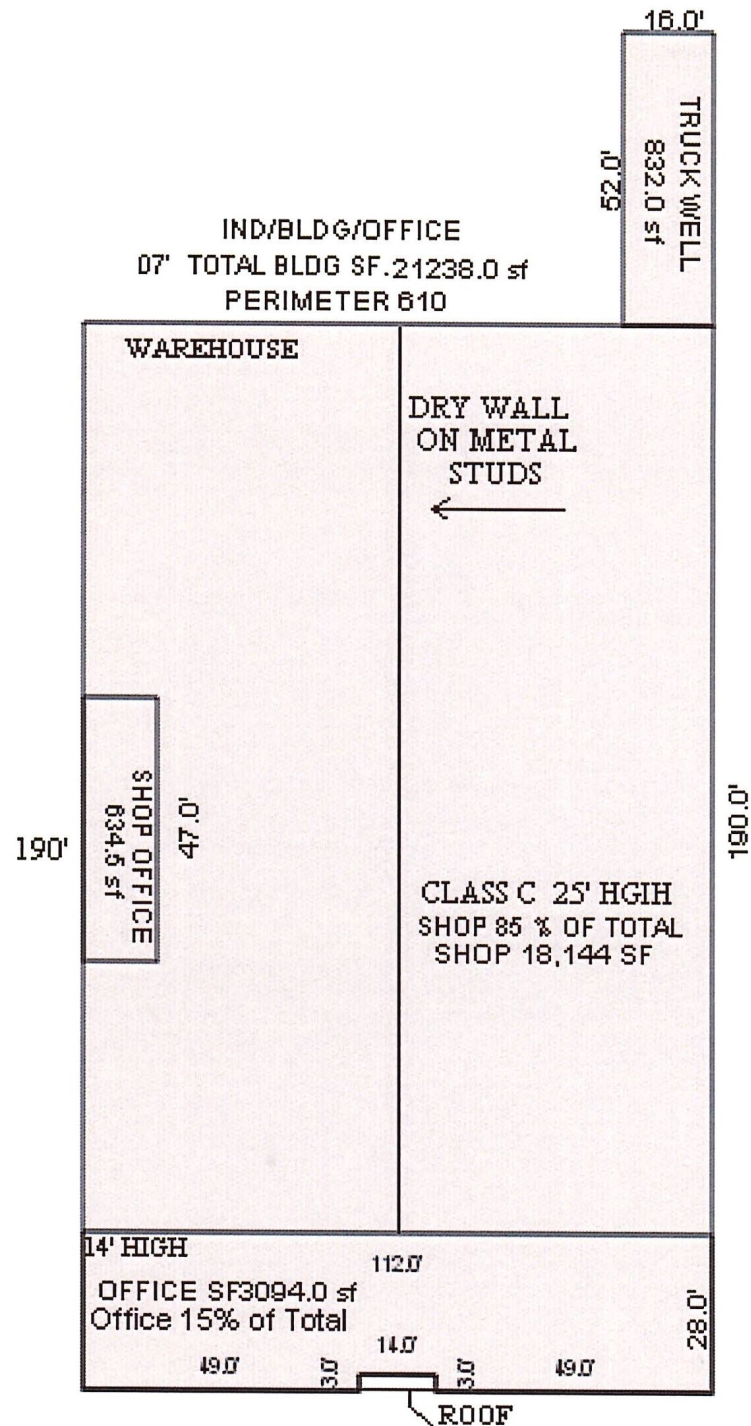





**NEWMARK**