

12155 Gateway Boulevard West

El Paso, TX

Key Facts

Property type	Industrial space
Building size	604,280 SF
Space available	127,230 - 604,280 SF



Contact Us

Learn more about this property or schedule a tour by reaching out to our local investment and leasing officer.

Colby Schraegle

+1 (214) 504-4067

colby.schraegle@eqtpartners.com

12155 Gateway Boulevard West

El Paso, TX

BUILDING SPECIFICATIONS - OPTION 1

Proposed Building Size: 604,280 SF
Land: 39.23 Acres
Dock Positions: 154
Column Spacing: 56' x 50'
Auto Parking: 232 Spaces
Trailer Parking: 196 Spaces
Truck Court Depth: 130'

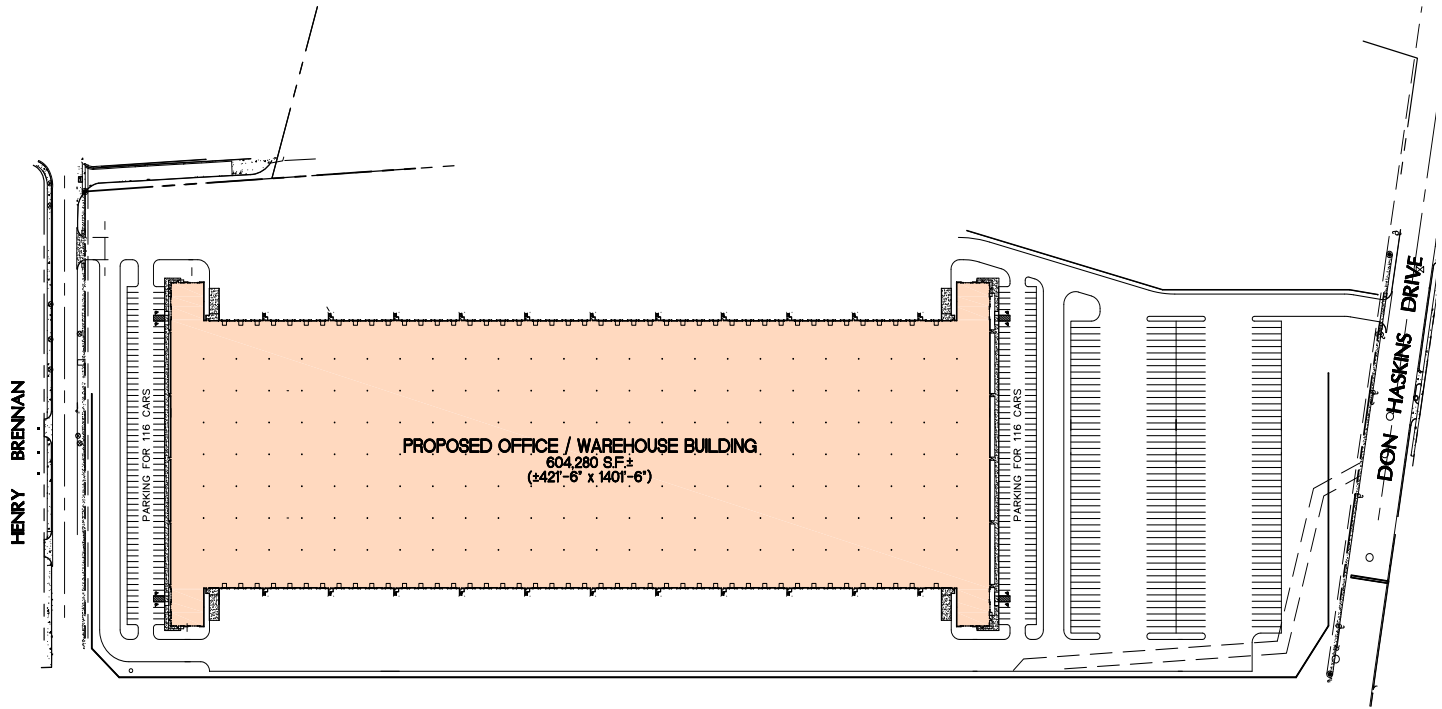

Contact Us

Learn more about this property or schedule a tour by reaching out to our local investment and leasing officer.

Colby Schraegle

+1 (214) 504-4067

colby.schraegle@eqtpartners.com

12155 Gateway Boulevard West

El Paso, TX

BUILDING SPECIFICATIONS - OPTION 2

Building A: 256,946 SF

- Truck Court Depth: 130'
- Auto Parking Spaces: 192
- Column Spacing: 56' x 50'

Building B: 256,946 SF

- Truck Court Depth: 135'
- Auto Parking Spaces: 198
- Trailer Staging: 36
- Column Spacing: 56' x 50'

Building C: 127,230 SF

- Truck Court Depth: 130'
 - Auto Parking Spaces: 129
 - Trailer Staging: 26
 - Column Spacing: 54' x 50'
-

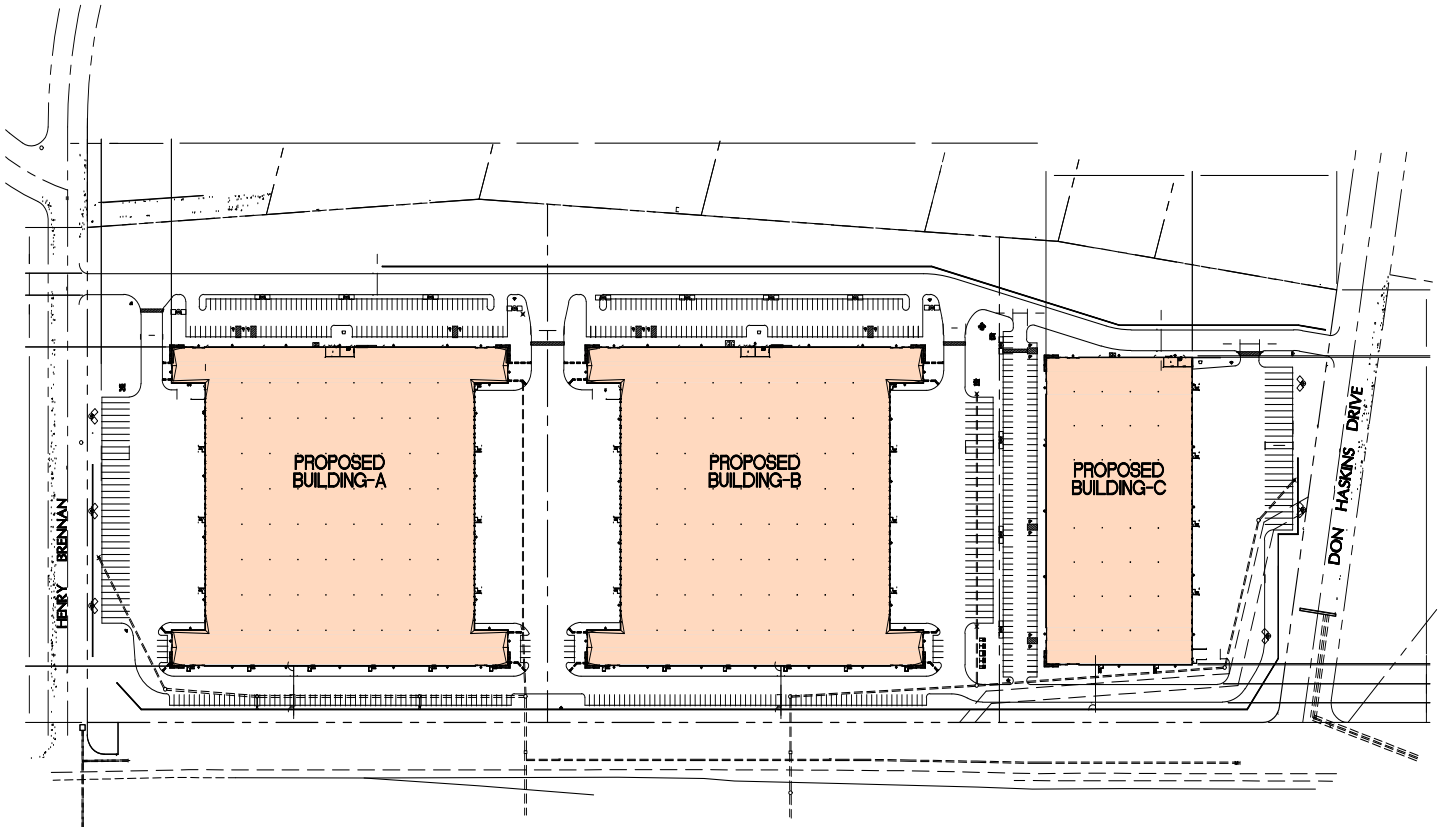

Contact Us

Learn more about this property or schedule a tour by reaching out to our local investment and leasing officer.

Colby Schraegle

+1 (214) 504-4067

colby.schraegle@eqtpartners.com