

# PHOENIX STAR COMMERCE PARK

**AVAILABLE 10/1/2026**

**2140 S. 7th Avenue  
Suite 140: ±13,146 SF**

**224,308 SQUARE FEET / 4 BUILDING PROJECT / 2110-2140 S. 7TH AVENUE, PHOENIX, AZ**



**JEFF CONRAD, SIOR**  
PRINCIPAL  
602.954-3743  
jconrad@leeearizona.com

**ALLEN LOWE**  
PRINCIPAL  
602.954.3747  
alowe@leeearizona.com

**RYAN HINGST**  
PRINCIPAL  
602.954.3772  
rhingst@leeearizona.com

5090 North 40th Street, Suite 300 Phoenix, Arizona 85018 | 602.956.7777

All information furnished regarding property for sale, rental or financing is from sources deemed reliable, but no warranty or representation is made to the accuracy thereof and same is submitted to errors, omissions, change of price, rental or other conditions prior to sale, lease or financing or withdrawal without notice. No liability of any kind is to be imposed on the broker herein.

# PHOENIX STAR COMMERCE PARK

## 2140 S. 7TH AVENUE SUITE 140

- ▶ ±13,146 SF Suite
- ▶ Three (3) Truckwells, One (1) Grade Level
- ▶ EVAP Warehouse
- ▶ 24' Clear Height
- ▶ 4 Private Offices, Open Bullpen, Breakroom, Restrooms

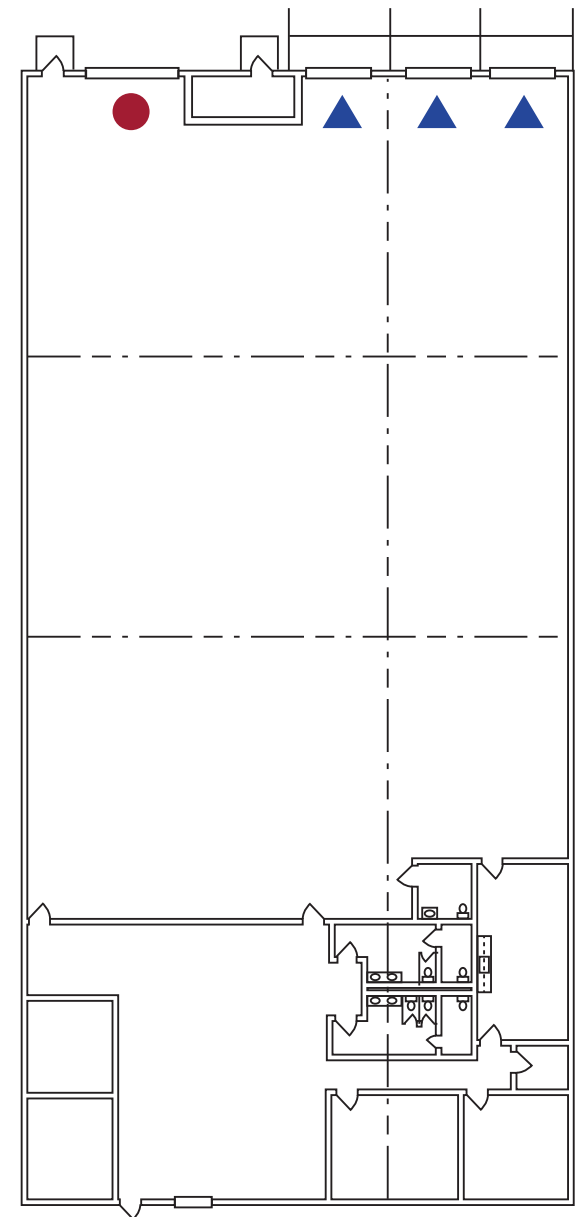

● Grade Level

▲ Truckwell

# PHOENIX STAR COMMERCE PARK

## FEATURES



Grade Level



Truckwell

### 2110 S. 7th Avenue

- 59,228 square feet
- 24' clear height
- 141'-3" bay depth
- 71 parking spaces
- Divisible to 14,620 sq. ft.
- Nine (9) grade level doors
- Twelve (12) truckwell doors

### 2120 S. 7th Avenue

- 50,666 square feet
- 24' clear height
- 131'-3" bay depth
- 111 parking spaces
- Divisible to 6,230 sq. ft.
- Ten (10) grade level doors
- Eight (8) truckwell doors

### 2130 S. 7th Avenue

- 46,814 square feet
- 24' clear height
- 121'-3" bay depth
- 101 parking spaces
- Divisible to 5,750 sq. ft.
- Ten (10) grade level doors
- Six (6) truckwell doors

### 2140 S. 7th Avenue

- 67,600 square feet
- 24' clear height
- 161'-3" bay depth
- 146 parking spaces
- Divisible to 16,700 sq. ft.
- Nine (9) grade level doors
- Fifteen (15) truckwell doors



# PHOENIX STAR COMMERCE PARK



- Adjacent to Full Diamond Interchange at Interstate-17 and 7th Avenue
- Three Miles to Phoenix Sky Harbor International Airport
- Exposure from an Elevated Freeway with 1,129 Feet of Freeway Frontage
- Grade Level Loading and Truckwells Provided
- A-2 (Heavy Industrial) Zoning, City of Phoenix
- 2000 Amp, 277/480 Volt, 3-Phase Per Building (APS Power)

**224,308 SQUARE FEET / 4 BUILDING PROJECT / 2110-2140 SOUTH 7TH AVENUE, PHOENIX, AZ**

**LEE & ASSOCIATES**  
COMMERCIAL REAL ESTATE SERVICES

**JEFF CONRAD, SIOR**  
PRINCIPAL  
602.954-3743  
jconrad@leearizona.com

**ALLEN LOWE, SIOR**  
PRINCIPAL  
602.954.3747  
alowe@leearizona.com

**RYAN HINGST**  
PRINCIPAL  
602.954.3772  
rhingst@leearizona.com

OWNED BY:

**WESTCORE**