

COMMERCE LANE BUSINESS PARK 427 COMMERCE LANE WEST BERLIN, NJ 08091

INDUSTRIAL
INVESTMENTS



- 14,700 SF Building
- Seven Drive-In Doors
- Excellent Location just off Route 73
- Minutes from NJ Turnpike, I-295, Route 30, Route 38, Route 70, and Philadelphia



FOR MORE INFORMATION: | 215.542.8017 | INDUSTRIALINVESTMENTS.COM

COMMERCE LANE BUSINESS PARK 427 COMMERCE LANE WEST BERLIN, NJ 08091

INDUSTRIAL
INVESTMENTS

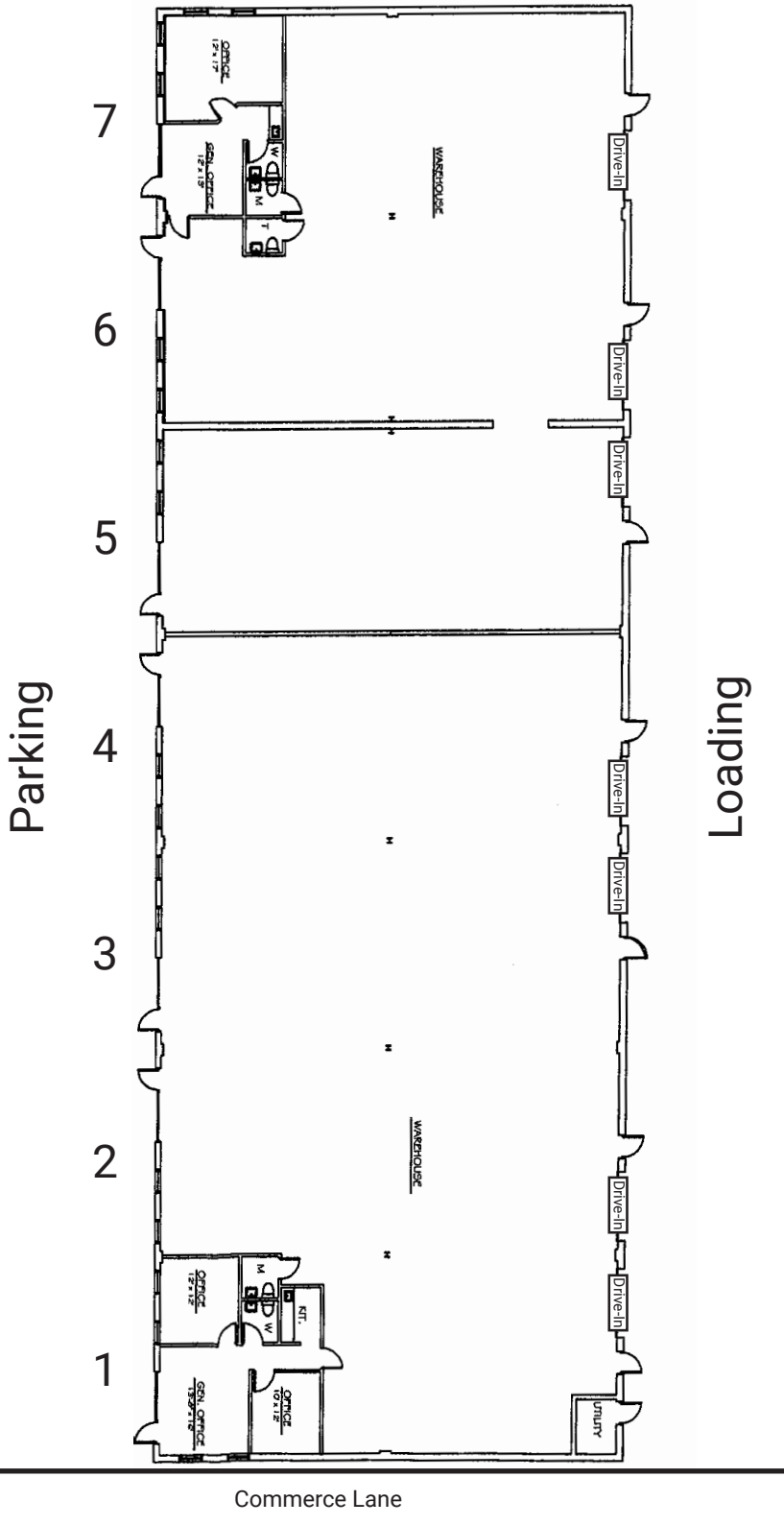

FEATURES

- Units from 2,100 Sq. Ft.
- Drive-In Loading
- 15' Clear Ceilings
- 3-Phase Power
- Offices-to-Suit
- Natural Gas Heating
- Separately Metered
- Flexible C-2 Commercial Zoning

LOADING DETAILS

- Drive-In Doors: 10' W x 12' H

BROKERS PROTECTED

The information herein is from sources deemed reliable,
but is not guaranteed. All measurements are approximate.

215.542.8017
INDUSTRIALINVESTMENTS.COM