

3461 - 3501 SAVIERS ROAD, OXNARD, CALIFORNIA

Property Information:

- Grocery anchored shopping center
- Redevelopment plans include drive-thru and carwash pads
- In-line retail space
- Centrally located in Oxnard, in high density trade area, with over 165,863 residential population within a 3-mile radius

AVAILABILITIES - GROUND LEASE

	Size
Drive-thru Parcel	Approx. 0.53 Acre
Carwash Parcel	Approx. 1 Acre

AVAILABILITIES - RETAIL

Retail Shop Space	2,200 SF
	5,000 SF

CONTACT US

Larry Tanji
Senior Vice President
Lic 01875638
larry.tanji@cbre.com
+1 805 288 4681



DEMOGRAPHICS (2022 Est) Source: Esri

	1-Mile	2-Mile	3-Mile
Residential Population	38,791	110,056	158,060
Daytime Population	27,720	84,973	126,723
Average Household Income	\$94,418	\$89,153	\$94,901

TRAFFIC COUNTS

Saviers Rd & Bryce Ave	13,657 ADT
------------------------	------------

Source: Placer 2019

3461 - 3501 Saviers Road
Oxnard, California

For Lease

SITE PLAN - DRIVE THRU & CARWASH PARCELS

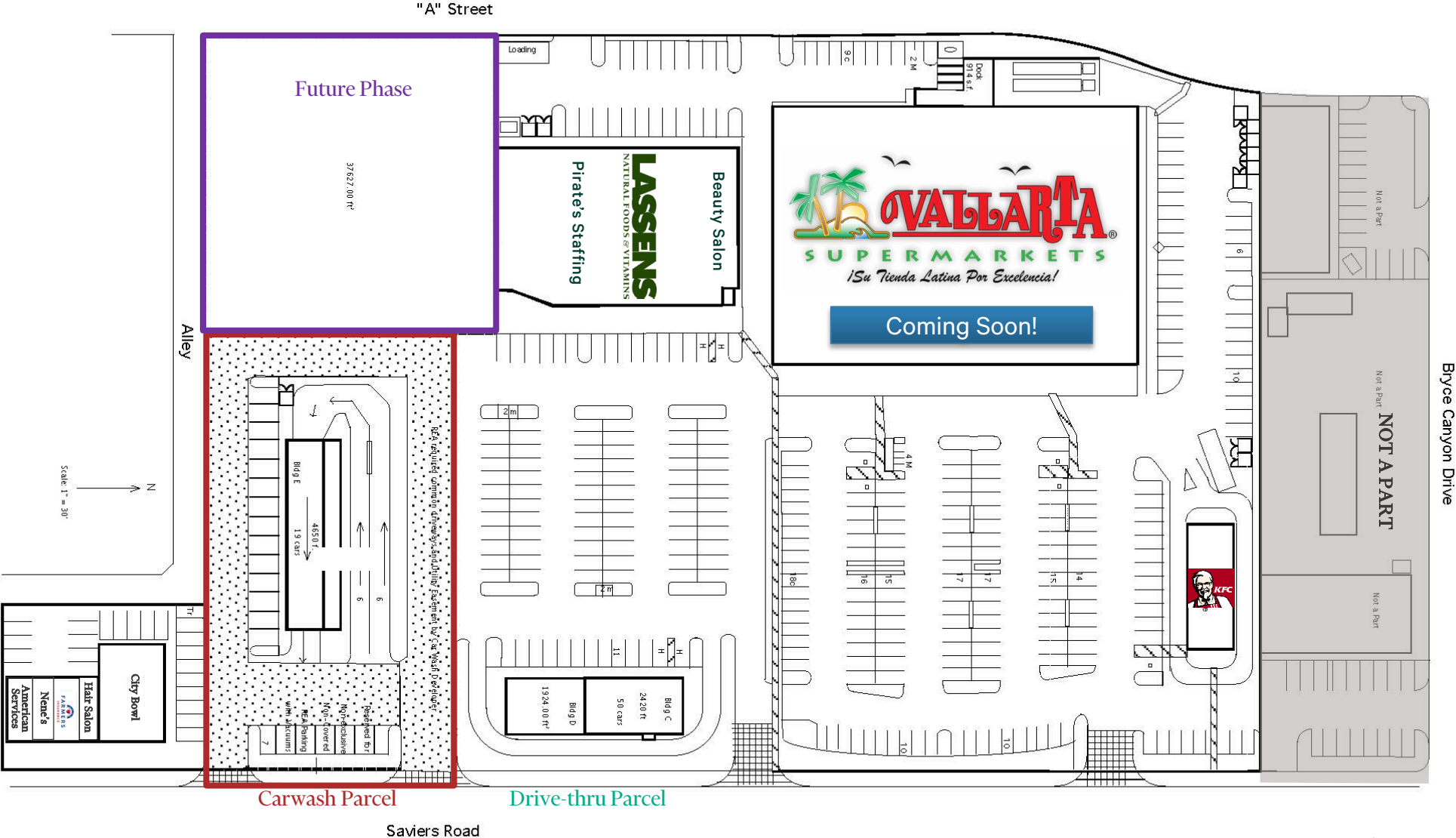

AVAILABILITIES - GROUND LEASE

	Size
Drive-thru Parcel	Approx. 0.53 Acre
Carwash Parcel	Approx. 1 Acre



3461 - 3501 Saviers Road
Oxnard, California

For Lease

SITE PLAN - RETAIL SPACE

AVAILABLE SPACE - RETAIL SPACE

SPACE	SQ.FT.
#3461	5,000
#3477	2,200

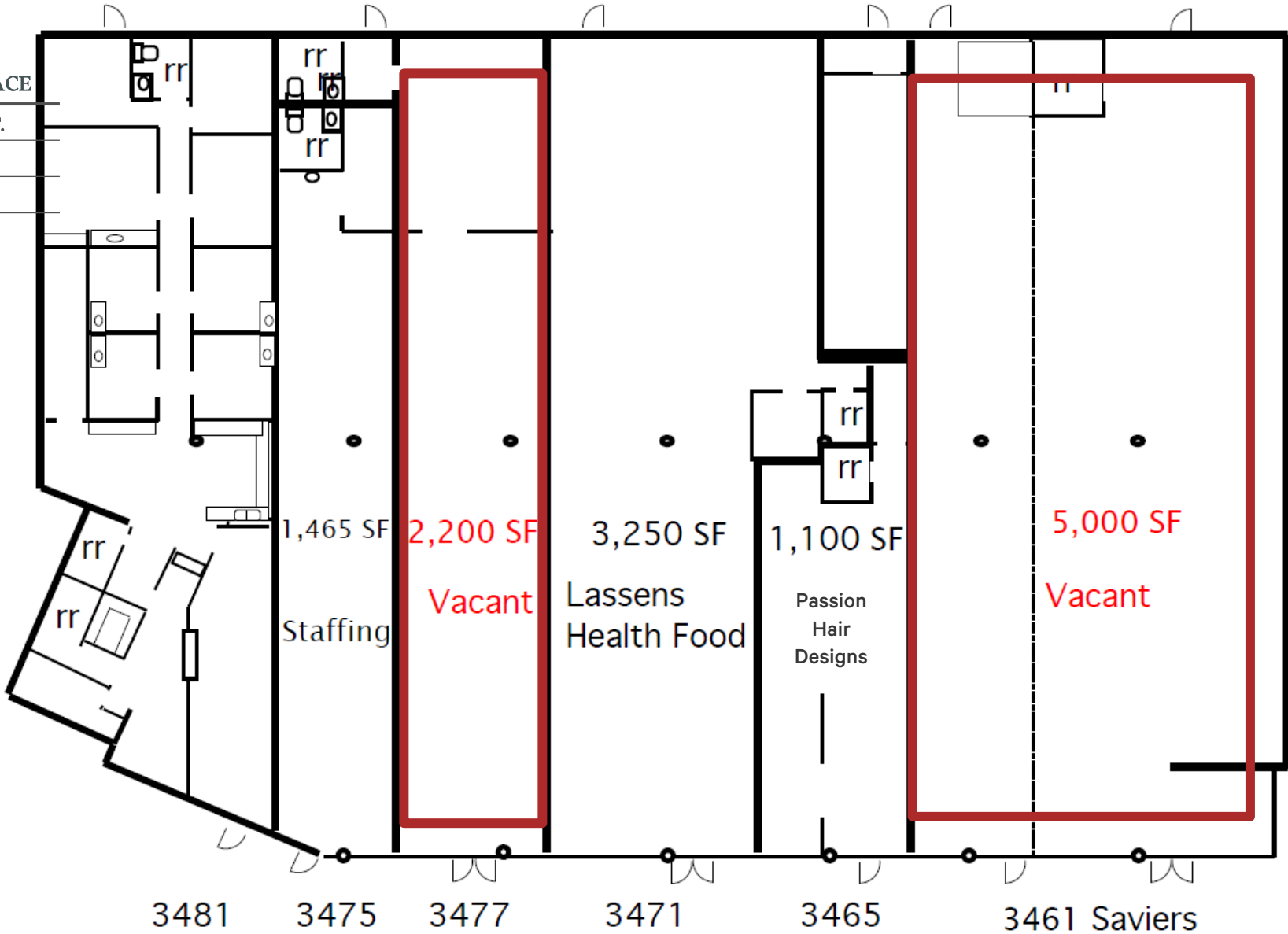

© 2025 CBRE, Inc. All rights reserved. This information has been obtained from sources believed reliable, but has not been verified for accuracy or completeness. You should conduct a careful, independent investigation of the property and verify all information. Any reliance on this information is solely at your own risk. CBRE and the CBRE logo are service marks of CBRE, Inc. All other marks displayed on this document are the property of their respective owners, and the use of such logos does not imply any affiliation with or endorsement of CBRE. Photos herein are the property of their respective owners. Use of these images without the express written consent of the owner is prohibited.



3461 - 3501 Saviers Road
Oxnard, California

For Lease

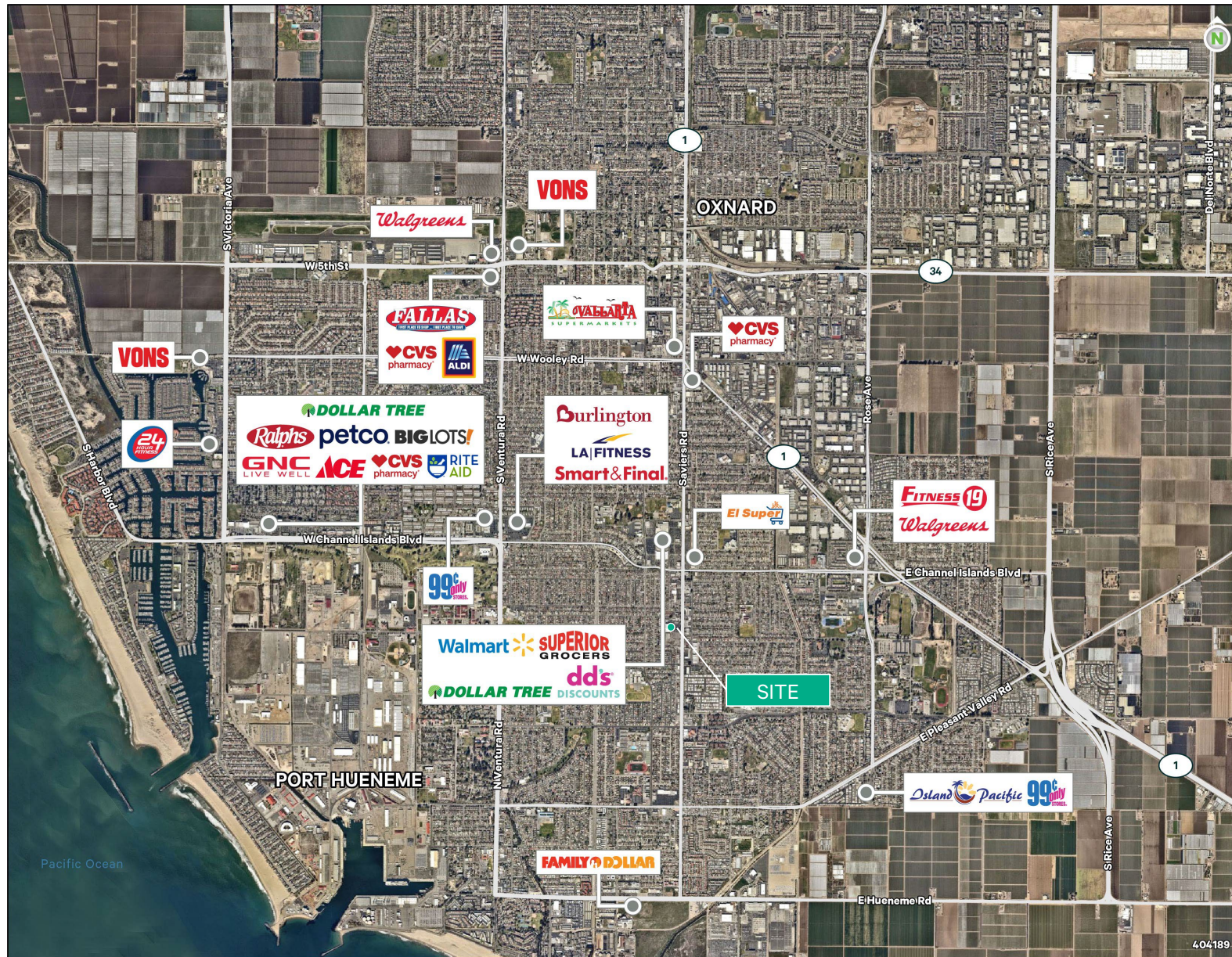

CONTACT US

Larry Tanji
Senior Vice President
Lic 01875638
larry.tanji@cbre.com
+1 805 288 4681

© 2025 CBRE, Inc. All rights reserved. This information has been obtained from sources believed reliable, but has not been verified for accuracy or completeness. You should conduct a careful, independent investigation of the property and verify all information. Any reliance on this information is solely at your own risk. CBRE and the CBRE logo are service marks of CBRE, Inc. All other marks displayed on this document are the property of their respective owners, and the use of such logos does not imply any affiliation with or endorsement of CBRE. Photos herein are the property of their respective owners. Use of these images without the express written consent of the owner is prohibited.

CBRE