

145 WILLIMAN STREET

CHARLESTON | SOUTH CAROLINA

±11,992 SF of Plug and Play Office Space for Sublease

**Sublease runs through 8/13/2025*



William Ederle
Brokerage Associate
+1 843 720 7507
william.ederle@colliers.com

Colliers
4289 Spruill Ave
Suite 200
North Charleston, SC 29405

145 Williman **Availability**

145 Williman is a ±11,992 square-foot Class A office building located in the center of Charleston’s downtown peninsula. Tenants will enjoy a **world-class** work environment and convenient access to restaurants, hotels, shopping, arts and popular attractions. A mix of open workspace and private offices allows for a flexible floor plan, fit for any business. Furniture is negotiable.

Sublease rate: \$22/sf NNN
Estimated pass throughs: \$7.55/sf

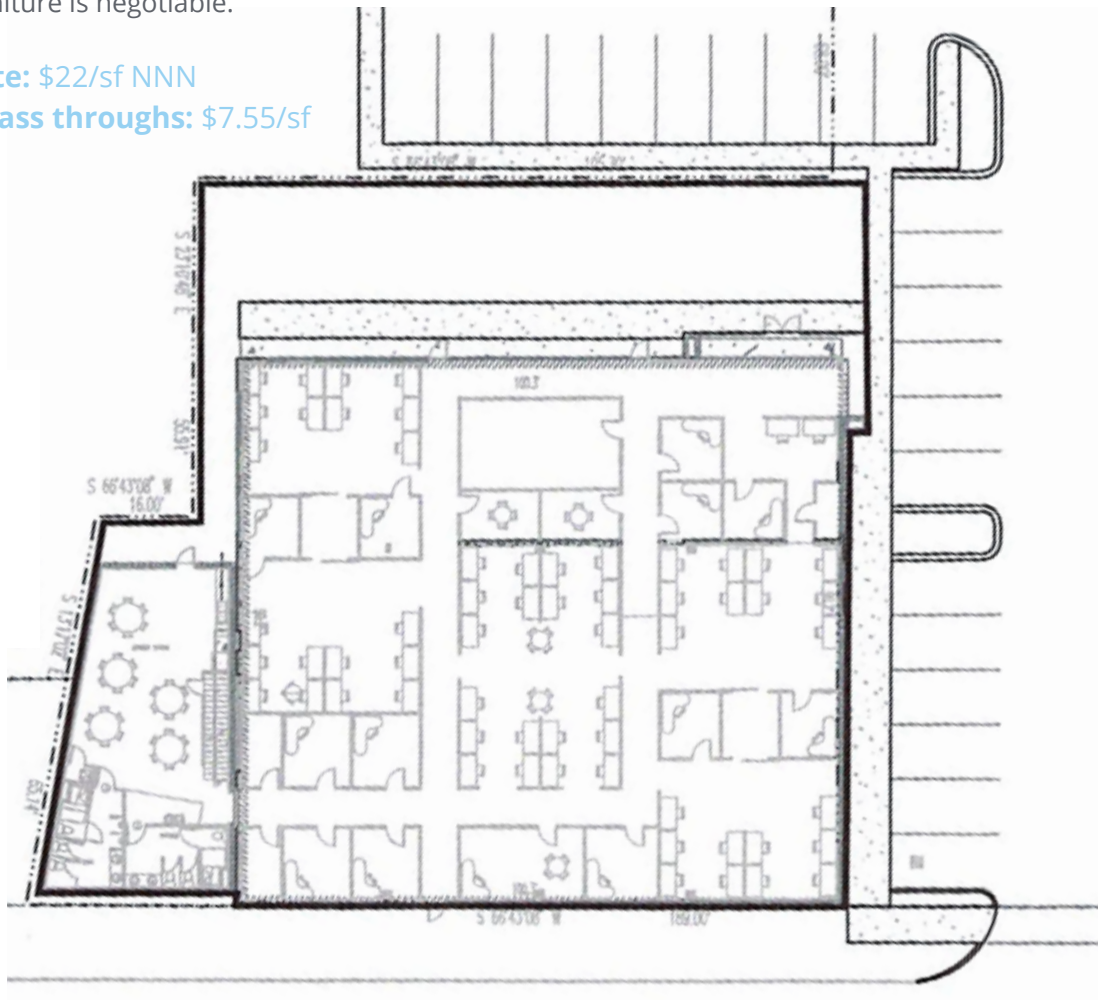

**Sublease runs through 8/13/2025*

145 Williman **Amenities**



Parking

Ample, free on-site parking available.



Visibility

Excellent visibility from the highly trafficked Morrison Drive and Meeting Street.



Entertainment

Centrally located near many bars and restaurants, there’s endless opportunities for business lunches, coffee meetings or happy hour hangouts.



Outdoor Space

Whether you’re eating lunch or enjoying a snack break, the covered porch and outdoor patio are a quiet oasis in the middle of the city.



Breakroom

Large breakroom with full kitchen.



Move-in Ready

145 Williman offers a Class A, move-in ready space providing minimal cost to bottom lines.





#1 City in
the US
8th year in a row

The South's Best
City **2020**
- Southern Living Magazine

#1 Small City
in the US
10th year in a row

7.3 Million
visitors
in 2019

#13 Best
performing
cities 2020
-Milken Institute

#19 Best cities
for jobs
-Wallet Hub

#8 Best state
for business

3 James Beard Award-winning
RESTAURANTS
Husk | Rodney Scott's BBQ | FIG

