



JCM
Ventures



DULUTH OFFICE SPACE

3505 Duluth Park Ln NW, Bldg 2
Duluth, GA 30096

GET IN TOUCH

Juan Mejia
678-636-9716
cre@jcmvpro.com



JCM
Ventures

3505 DULUTH PARK LN NW

Office Park located in Duluth

Currently used by Gwinnett County nonprofit for its operations. This space offers plenty of private offices for any user. The space is located across the street from Northside Hospital Duluth location and less than a 1.5 miles from Downtown Duluth. This property is located in a quiet four building office park.

About the Space

- **5,056 SF**
- **Professional Office or Medical Office**
- **Competitive Rates & Flexible Terms**
- **"Across the street" from Northside Hospital - Duluth**
- **Easily accessible close to major intersections and dining**
- **Free parking 2/1,000**

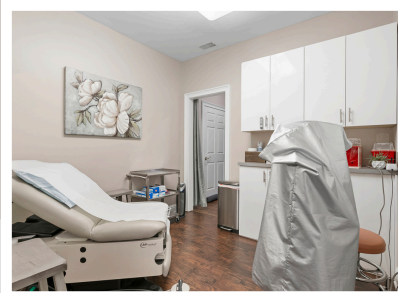



JCM
Ventures

FLOOR PLAN

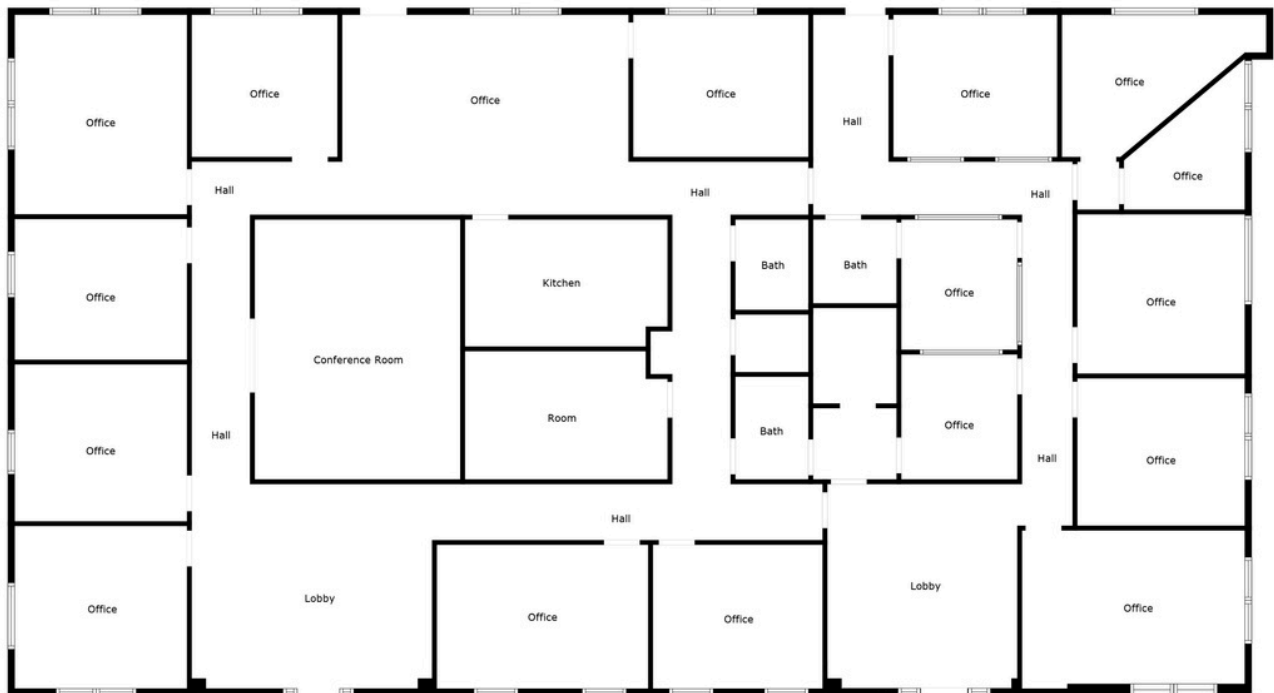



JCM
Ventures

3505 DULUTH PARK LN NW, BLDG 2





JCM
Ventures

INTERESTED? REACH OUT

Juan Mejia

PHONE: 678-636-9716

EMAIL: cre@jcmvpro.com

WEBSITE: <https://jcmvpro.com/>

If you have any further questions or are interested in scheduling tour, reach out and we are happy to assist.

