



715 South Maple Avenue
Montebello, CA 90640

For Lease
Asking Lease Rate:
\$60,107 per month net (\$0.60 PSF)
Available:
±100,179 SF (±2.3 Acres)

Contact Us:

Lary Carlton
Senior Vice President
Lary.Carlton@colliers.com
Direct: +1 562 547 8994

Kyle Degener
Senior Vice President
Kyle.Degener@colliers.com
Direct: +1 310 321 1805

Amanda DePierro
Senior Associate
Amanda.DePierro@colliers.com
Direct: +1 310 321 1817

colliers.com

This document has been prepared by Colliers International for advertising and general information only. Colliers International makes no guarantees, representations or warranties of any kind, expressed or implied, regarding the information including, but not limited to, warranties of content, accuracy and reliability. Any interested party should undertake their own inquiries as to the accuracy of the information. Colliers International excludes unequivocally all inferred or implied terms, conditions and warranties arising out of this document and excludes all liability for loss and damages arising there from. This publication is the copyrighted property of Colliers International and/or its licensor(s). ©2024. All rights reserved.

Property Highlights

- ◇ Cross Streets: South Maple Avenue / Beach Street
- ◇ Lot: ± 100,179 SF (± 2.3 Acres)
- ◇ Yard: Fully Secured / Fenced / Paved
- ◇ Building: ± 4,800 SF
- ◇ Offices: ± 1,600 SF of Office
- ◇ Utilities: Water / Electric / Sewer
- ◇ Power: ± 200 Amps
- ◇ Zoning: M1
- ◇ Current Use: Truck Yard
- ◇ APN: 6353-002-011
- ◇ Location: Close Proximity to 605 / 710 / 5 Freeways

Tax Map

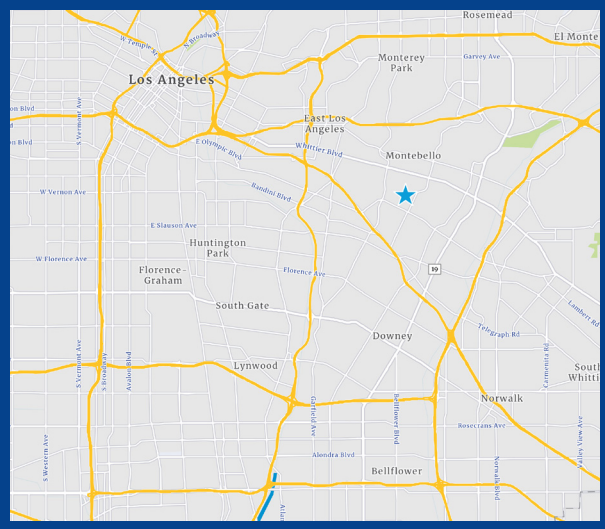
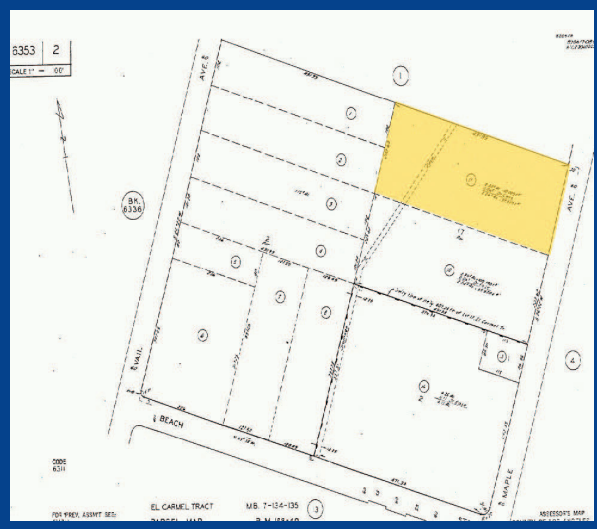

Contact Us:

Lary Carlton
Senior Vice President
Lary.Carlton@colliers.com
Direct: +1 562 547 8994

Kyle Degener
Senior Vice President
Kyle.Degener@colliers.com
Direct: +1 310 321 1805

Amanda DePierro
Senior Associate
Amanda.DePierro@colliers.com
Direct: +1 310 321 1817

Lessee to verify all data including but not limited to size, square footage*, power, clearance, zoning, allowed uses with municipality and all other data. * All square footages referenced are for comparison purposes only and are not a representation or warranty. Buyer / Lessee are encouraged to measure and confirm the property size and square footages and engage a surveyor for exact determination of square footages, property lines, easements, encroachments, etc. (Square Footage may or may not have been and are often taken from title company published data. Colliers does not know if the SF is accurate or not accurate. Note that it is common when an appraiser, architect, engineer, or real estate agent measures a property, building, lot, that each may often come up with different measurements and these measurements may often be different from what the tax assessor might publish).

715 South Maple Avenue | For Lease

Photos

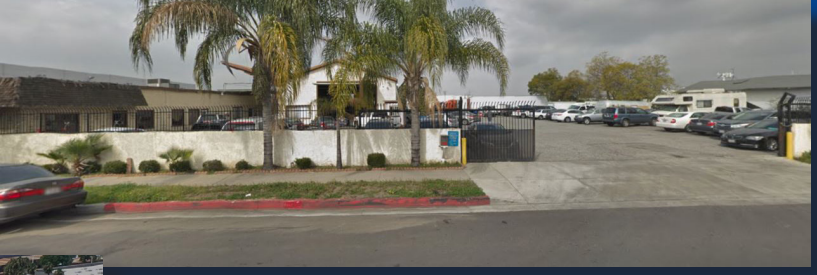
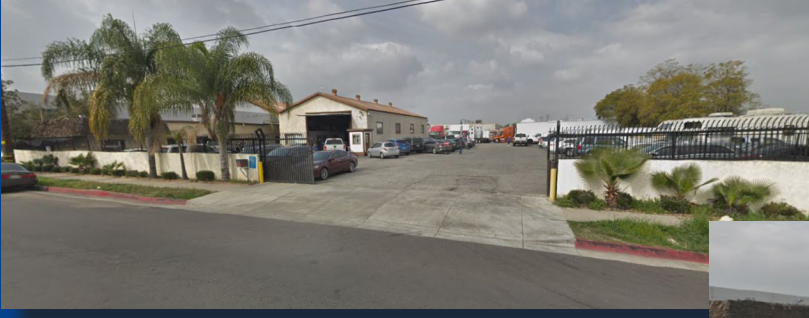

Contact Us:

Lary Carlton
Senior Vice President
Lary.Carlton@colliers.com
Direct: +1 562 547 8994

Kyle Degener
Senior Vice President
Kyle.Degener@colliers.com
Direct: +1 310 321 1805

Amanda DePierro
Senior Associate
Amanda.DePierro@colliers.com
Direct: +1 310 321 1817

Lessee to verify all data including but not limited to size, square footage*, power, clearance, zoning, allowed uses with municipality and all other data. * All square footages referenced are for comparison purposes only and are not a representation or warranty. Buyer / Lessee are encouraged to measure and confirm the property size and square footages and engage a surveyor for exact determination of square footages, property lines, easements, encroachments, etc. (Square Footage may or may not have been and are often taken from title company published data. Colliers does not know if the SF is accurate or not accurate. Note that it is common when an appraiser, architect, engineer, or real estate agent measures a property, building, lot, that each may often come up with different measurements and these measurements may often be different from what the tax assessor might publish).