

# FOR SUBLEASE



**7337 Airways Blvd,  
Southaven, MS**

**± 36,469 s.f. warehouse/distribution space**

- Available: ± 36,469 s.f.
- Clear height: 24'
- Dock doors: 6
- Sprinkler system: ESFR
- Column Spacing: 57' x 25'
- HVAC: Fully-Conditioned
- Lease rate: Contact broker for pricing
- Lease term: Negotiable
- Term expiration: 12/31/2032

**Matt Denny**  
+1 901 291 5407  
[matthew.denny@jll.com](mailto:matthew.denny@jll.com)

**Russ Westlake**  
+1 901 261 2613  
[russ.westlake@jll.com](mailto:russ.westlake@jll.com)

**Simon Copeland**  
+1 919 424 8454  
[simon.copeland@jll.com](mailto:simon.copeland@jll.com)

**Al Williams**  
+1 919 424 8154  
[al.williams@jll.com](mailto:al.williams@jll.com)



**Jones Lang LaSalle  
Brokerage, Inc.**  
+1 901 261 2600

± 36,469 s.f. warehouse/distribution space

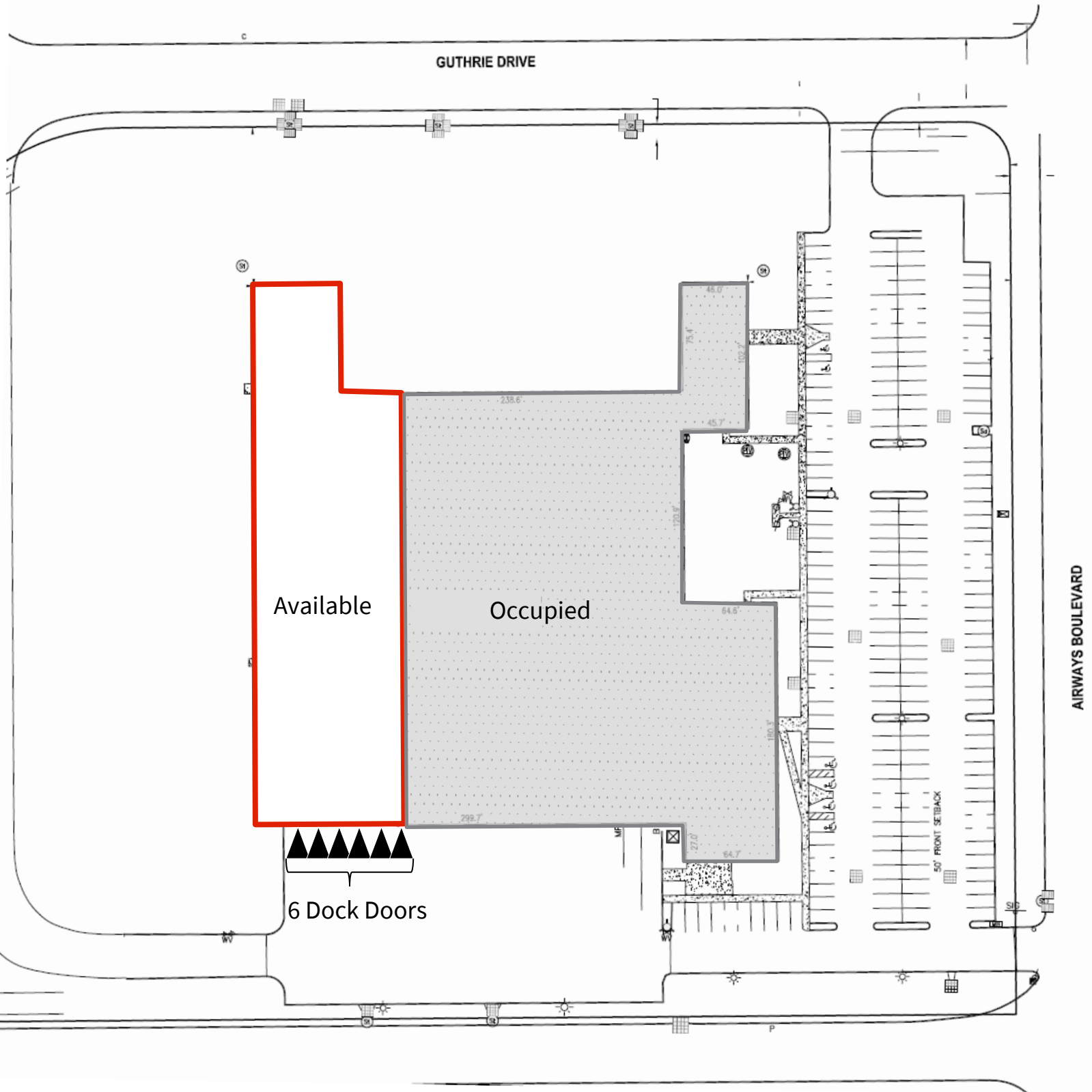

**Matt Denny**  
+1 901 291 5407  
[matthew.denny@jll.com](mailto:matthew.denny@jll.com)

**Russ Westlake**  
+1 901 261 2613  
[russ.westlake@jll.com](mailto:russ.westlake@jll.com)

**Simon Copeland**  
+1 919 424 8454  
[Simon.copeland@jll.com](mailto:Simon.copeland@jll.com)

**Al Williams**  
+1 919 424 8154  
[al.williams@jll.com](mailto:al.williams@jll.com)



**Jones Lang LaSalle  
Brokerage, Inc.**  
+1 901 261 2600

# Location Overview

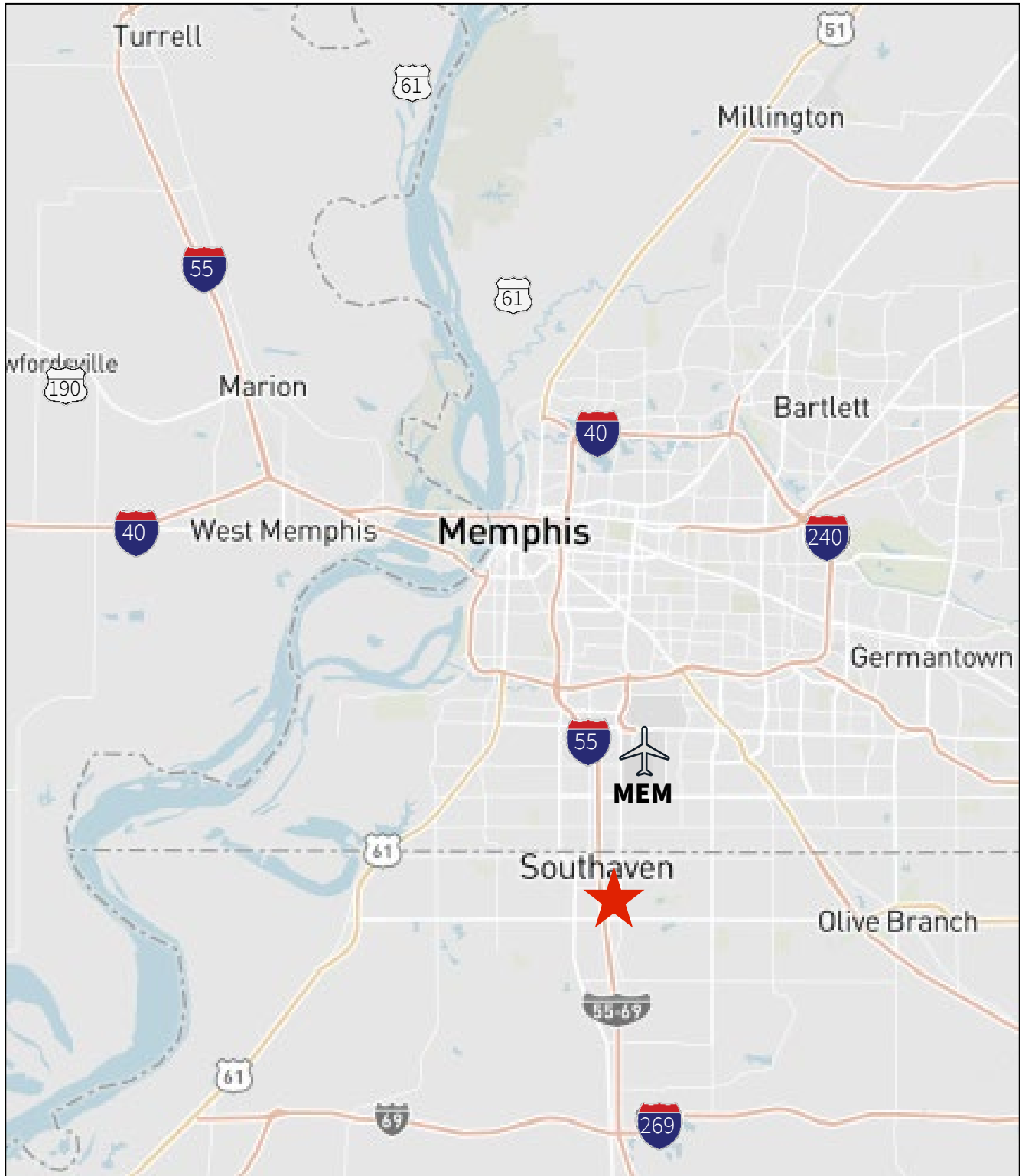

**Matt Denny**  
+1 901 291 5407  
[matthew.denny@jll.com](mailto:matthew.denny@jll.com)

**Russ Westlake**  
+1 901 261 2613  
[russ.westlake@jll.com](mailto:russ.westlake@jll.com)

**Simon Copeland**  
+1 919 424 8454  
[Simon.copeland@jll.com](mailto:Simon.copeland@jll.com)

**Al Williams**  
+1 919 424 8154  
[al.williams@jll.com](mailto:al.williams@jll.com)



**Jones Lang LaSalle  
Brokerage, Inc.**  
+1 901 261 2600